



- Well Presented Garden Fronted Mid Terraced House
- Lounge/Dining Room
- Kitchen
- Two Double Bedrooms
- 3 Piece Bathroom
- Rear Courtyard
- Internal Inspection Highly Advised

596 Tonge Moor Road, Crompton, Bolton, BL2 3BJ

The Property A generous sized bay fronted, two bed mid terrace property, with views over the allotments and Tonge Cricket Club to the rear. Situated in close proximity to the train station, sought after local nurseries, schools, excellent transport links and amenities. Not overlooked to the rear with views of the allotments and Cricket Club.

Warmed by gas central heating and uPVC double glazed, we feel the property will be of particular interest to both investors and first time buyers alike.

A personal inspection comes with the highest recommendations.

Briefly comprising: Composite entrance door, entrance vestibule, hall, bay fronted lounge, dining room with pvc double glazed French doors leading to the rear courtyard, modern kitchen, landing, two double bedrooms and a three piece family bathroom suite.

Outside

To the outside is a low maintenance front garden and an enclosed rear yard.

Out And About

Close to a host of local amenities including the train station and good schools including Cannon Slade and Turton High.

£145,000

Entrance Hall



Lounge



Dining Room





Kitchen



First Floor



Bedroom 1



Bedroom 2



3 Piece Bathroom



596 Tonge Moor Road, Crompton, Bolton, BL2 3BJ

Outside



Additional Pictures





Agents Notes

William Thomas Estates for themselves and for vendors or lessors of this property whose agents they are given notice that: (i) the particulars are set out as a general outline only for the guidance of intended purchasers or lessees and do not constitute nor constitute part of an offer or a contract. (ii) all descriptions, dimensions, reference to condition and necessary permissions for use and occupation and other details are given without responsibility and any intending purchasers or tenants should not rely on them as statements or representations of fact but must satisfy themselves by inspection or otherwise as to the correctness of each of them (iii) no person in the employment of William Thomas Estates has authority to make or give any representations or warranty whatever in relation to this property

GROUND FLOOR
411 sq.ft. (38.2 sq.m.) approx.

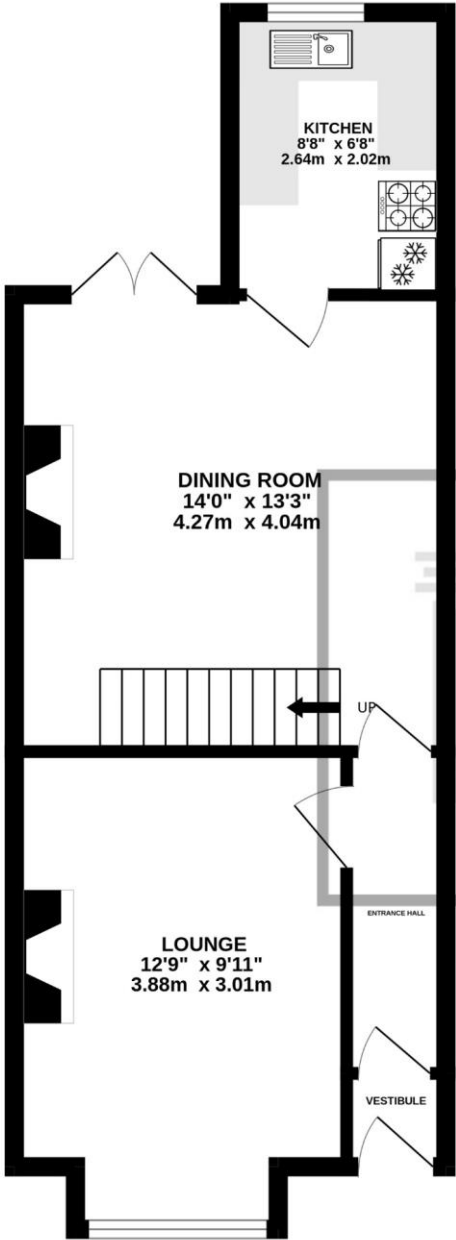

1ST FLOOR
339 sq.ft. (31.5 sq.m.) approx.

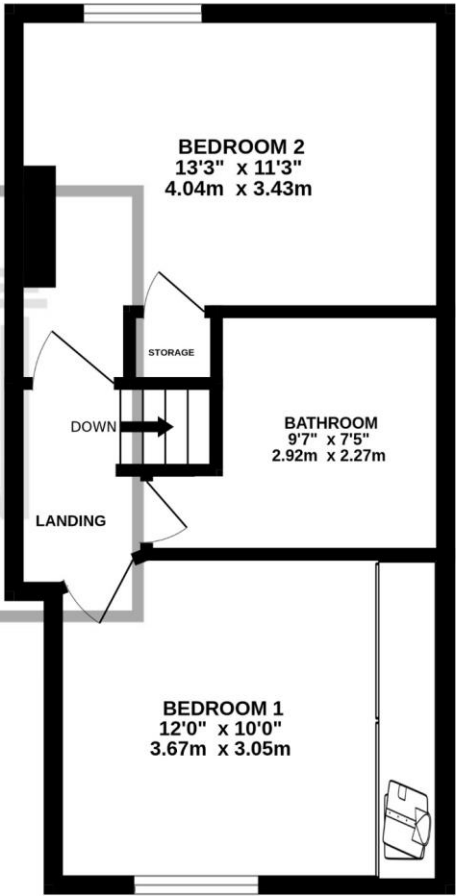

596 TONGE MOOR ROAD - MARKETING BY WILLIAM THOMAS ESTATE AGENTS

TOTAL FLOOR AREA : 750 sq.ft. (69.7 sq.m.) approx.

Whilst every attempt has been made to ensure the accuracy of the floorplan contained here, measurements of doors, windows, rooms and any other items are approximate and no responsibility is taken for any error, omission or mis-statement. This plan is for illustrative purposes only and should be used as such by any prospective purchaser. The services, systems and appliances shown have not been tested and no guarantee as to their operability or efficiency can be given.
Made with Metropix ©2025