

# 4 Appledore Drive

Approximate Gross Internal Area

732 sq ft - 68 sq m

Bedroom 3

10'10 x 5'11

3.29 x 1.80m

Bathroom

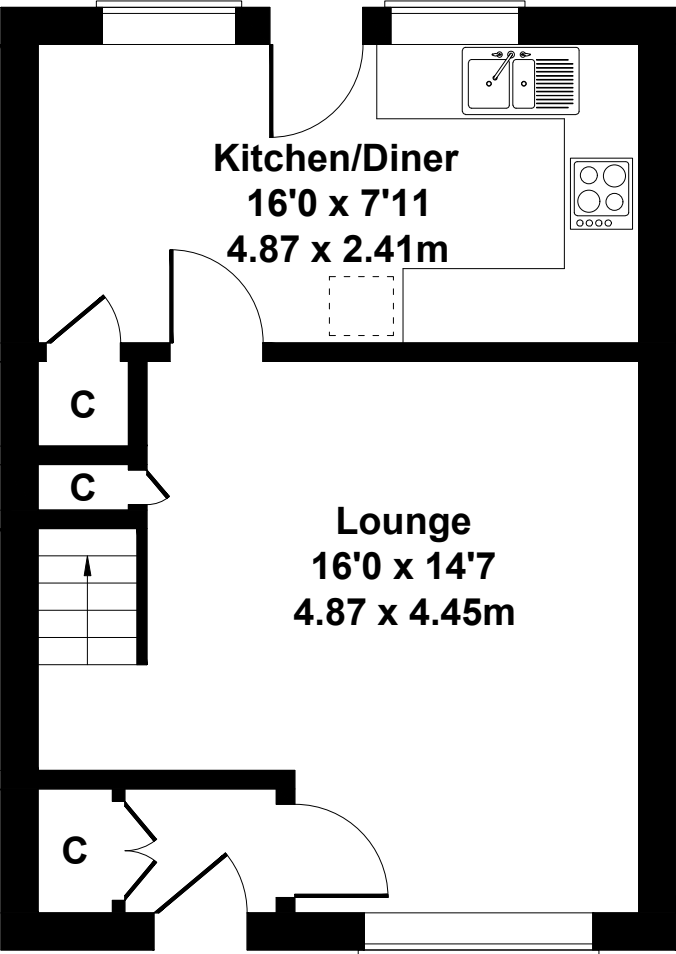

**GROUND FLOOR**

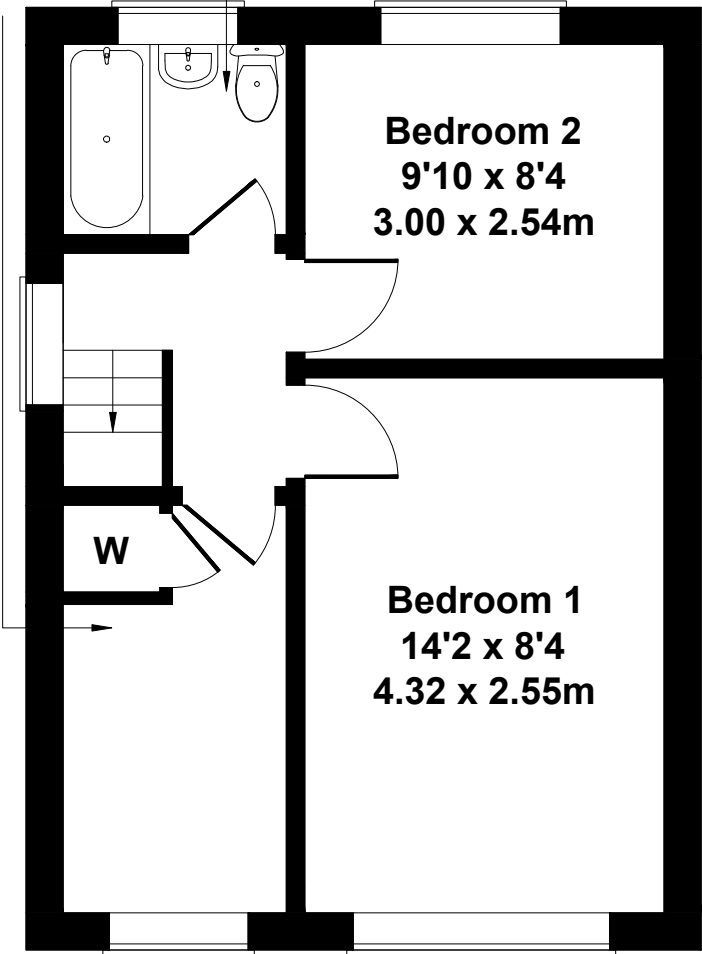

**FIRST FLOOR**

Not to Scale. Produced by The Plan Portal 2026

**For Illustrative Purposes Only.**