

100mm soil and vent pipe to be ducted to external air via a roof tile vent; internally the pipe to be encased with tanalised softwood framing and 1 no. layer of 12.5mm Gyproc WallBoard receiving a plaster skim finish.

Black uPVC 68mm round rainwater downpipe and gully to connect into drainage system to Building Control satisfaction.

Black uPVC 68mm round rainwater downpipe and gully to connect into drainage system to Building Control satisfaction.

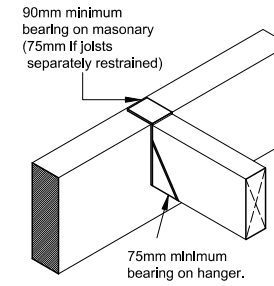

Joist Hanger Detail (Not to Scale)

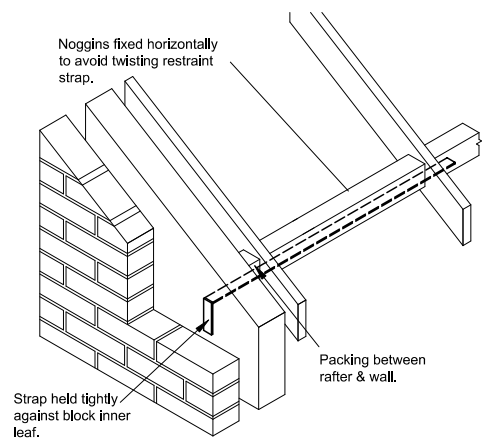

Roof Strap Detail (Not to Scale)

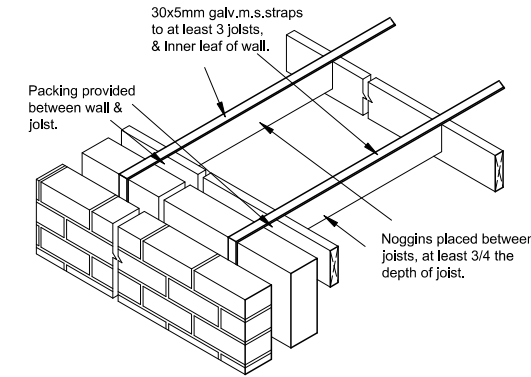

Wall Strap Detail (Not to Scale)

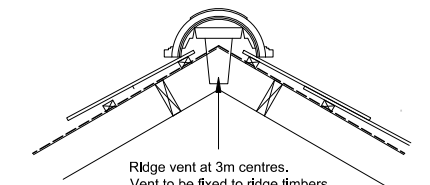

Dry Ridge Detail (Not to Scale)

2 rows solid full depth timber noggin to be provided at head of wind post

Wind post fixed to wall plate. Refer to details

100mm external soil and vent pipe to terminate a minimum 900mm above nearest opening light.

Black uPVC 68mm round rainwater downpipe and gully to connect into drainage system to Building Control satisfaction.

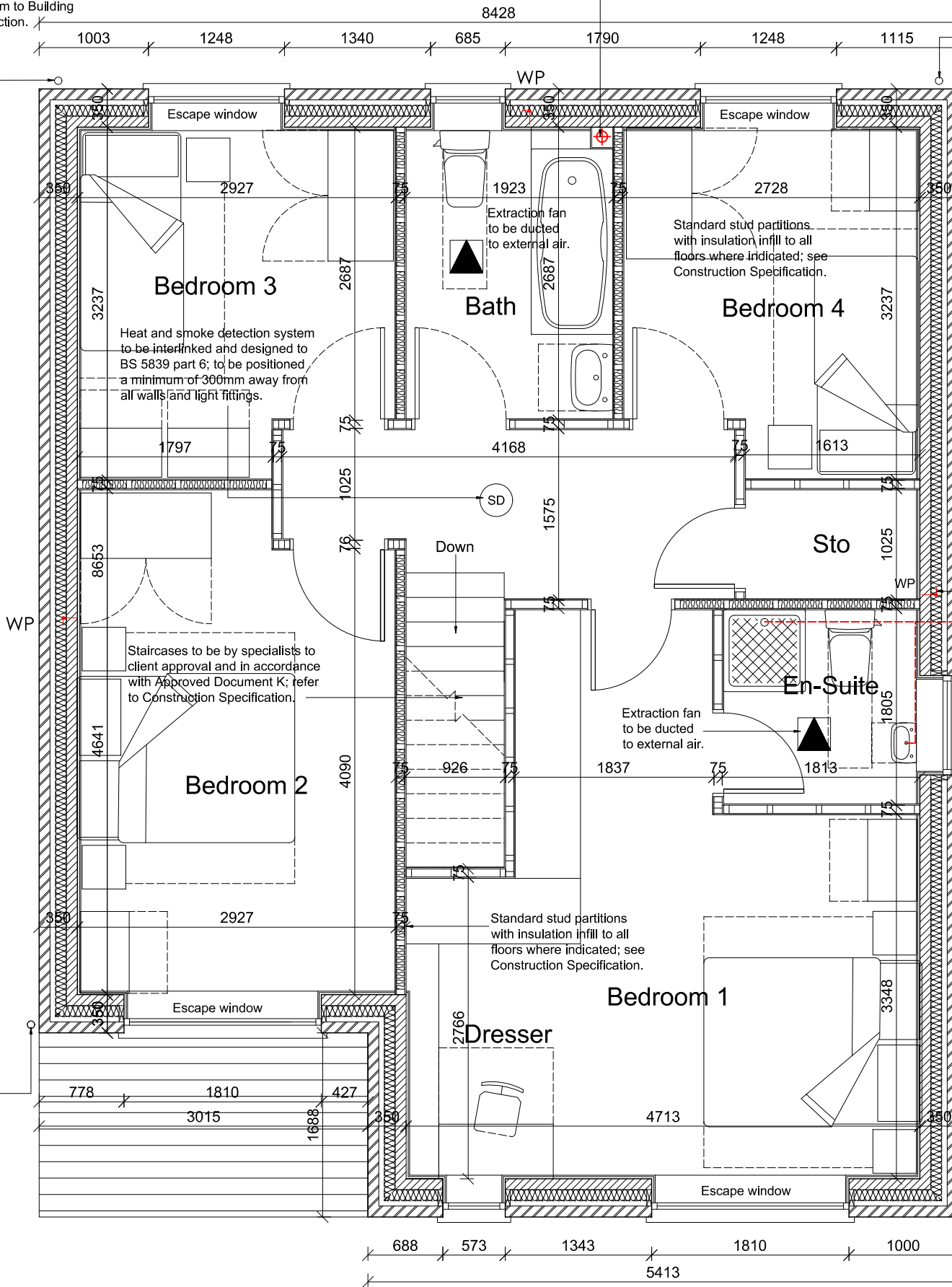

First Floor Plan

NB: All steelwork to be intumescently painted to provide min. 1 hour fire resistance unless encased in fireboarding.

REV	DATE	AMENDMENT	BY	CHKD
B	27/01/21	Structural steelwork added.	GG	--
A	07/12/20	First Floor Layout Amended	GG	--

HNAarchitects
Architecture | Planning | Design

PROJECT:	Land adjacent 615 Swanlow Lane, Winsford			
CLIENT:	Linear Living			
DRAWING:	Plot two - First floor plan			
DRAWN BY:	YQ	CHECKED BY:	--	DATE: Nov 2020
STATUS:	Technical design		DRAWING No: 1301/C/105	SCALE: 1:50 @ A3
				REVISION: B