



EVOTECH®
P E R F O R M A N C E

Installation Instructions

DUCATI MONSTER 1200 R TAIL TIDY

Product Reference - 13275

Kit Contents

- | | |
|------------------------------------|--|
| A 1 x Main Tail Tidy | E 2 x M5 -12 Countersink Screws |
| B 1 x Licence Plate Bracket | F 2 x Plastic Nuts and Screws |
| C 1 x Plate Light Bracket | G 4 x M4 - 8 Button Head Screws |
| D 1 x Reflector and Bracket | H 5 x Cable Ties |

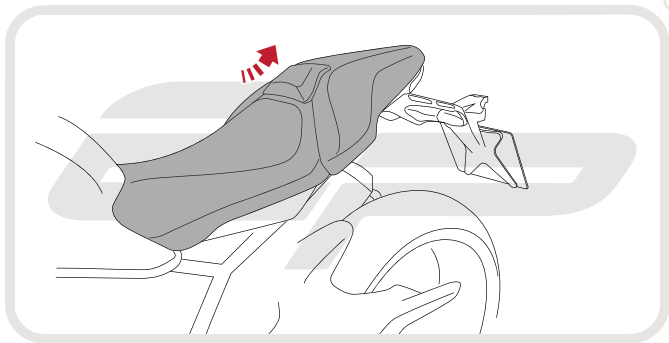

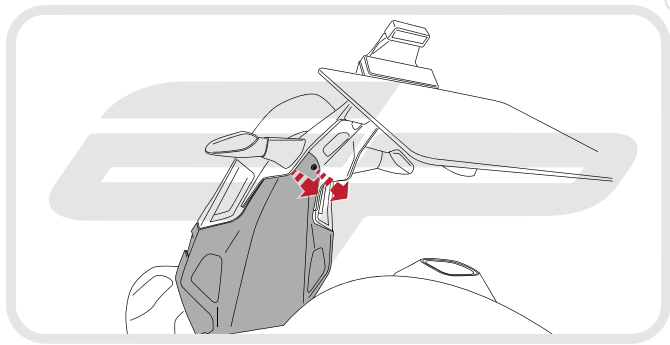

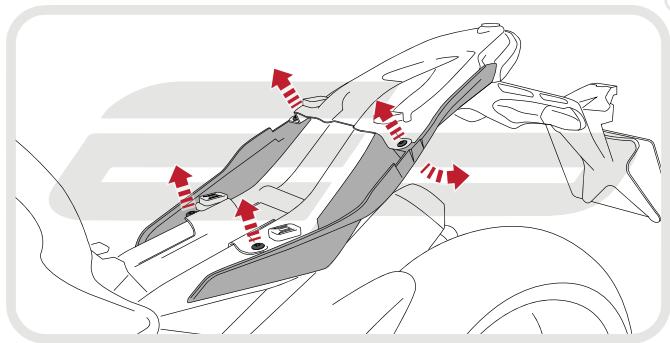

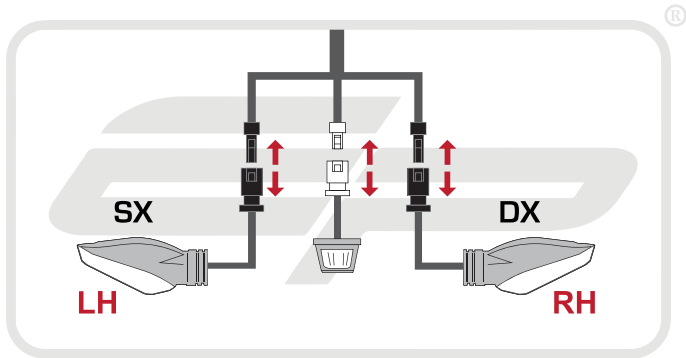

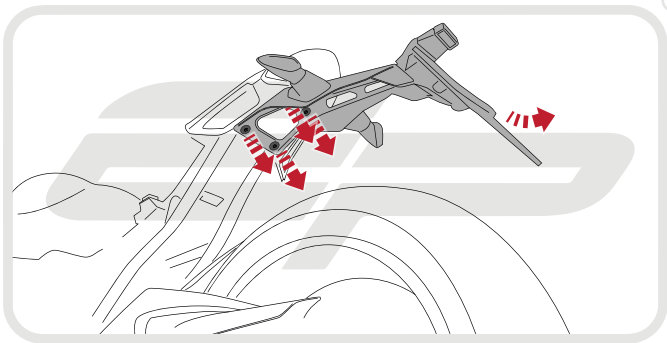

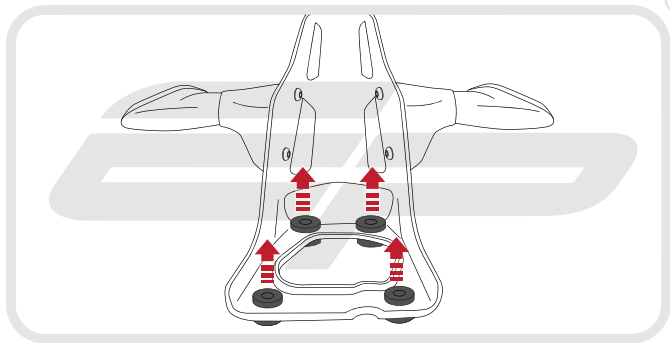

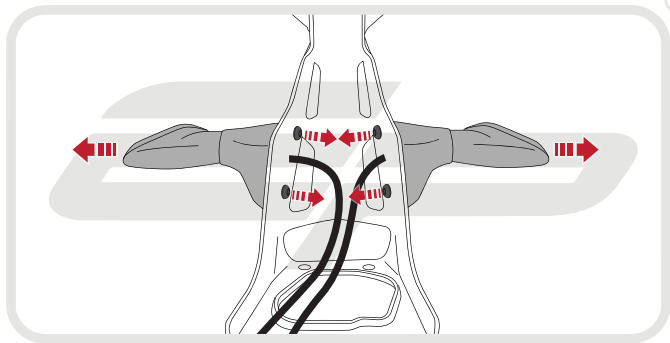

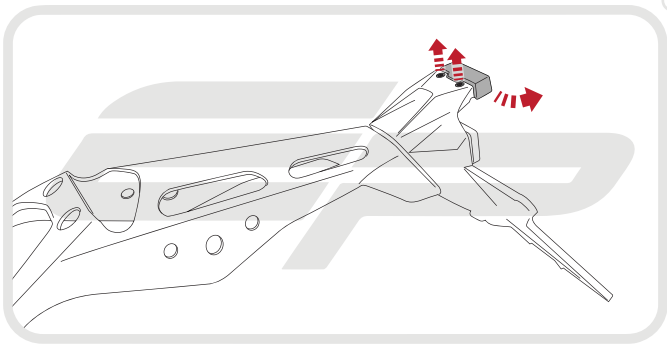



Loop cable ties through the tail tidy but **DO NOT** zip them up at this stage

H x3

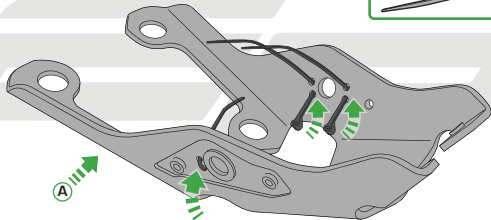



Caution

Pull indicator connector through
tail tidy **BEFORE** installing
rubber grommet

Repeat for both indicators

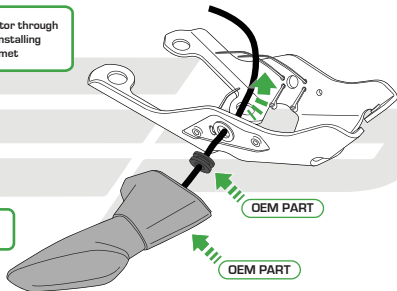

OEM PART

OEM PART

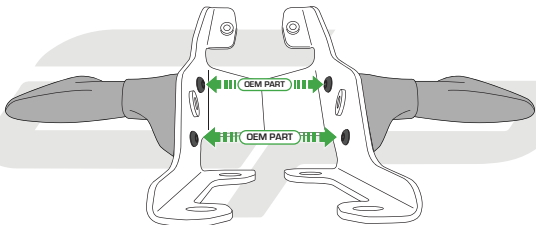

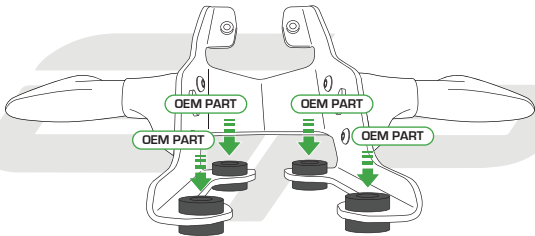

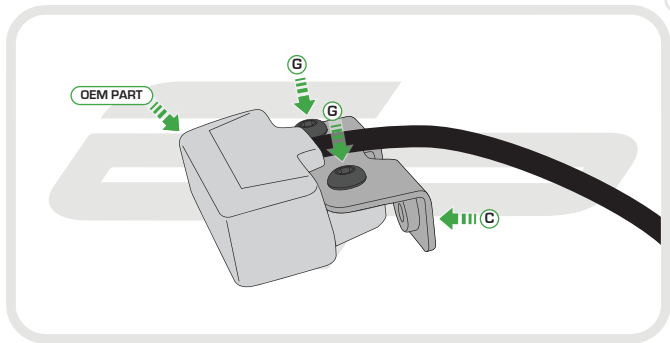

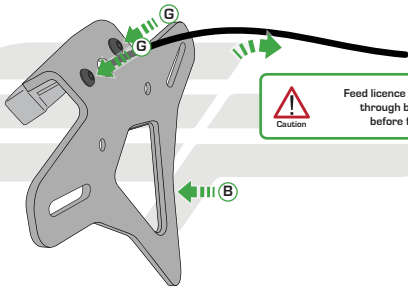

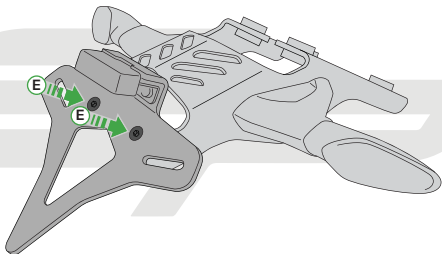

EVOTECH[®]
P E R F O R M A N C E

Use cable ties installed in stage 9
to hold wires neatly along the
sides of the tail tidy

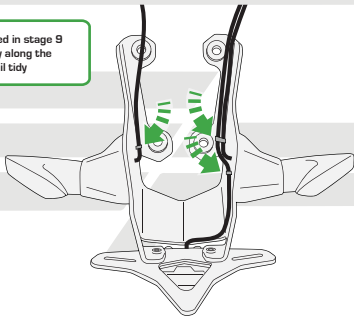

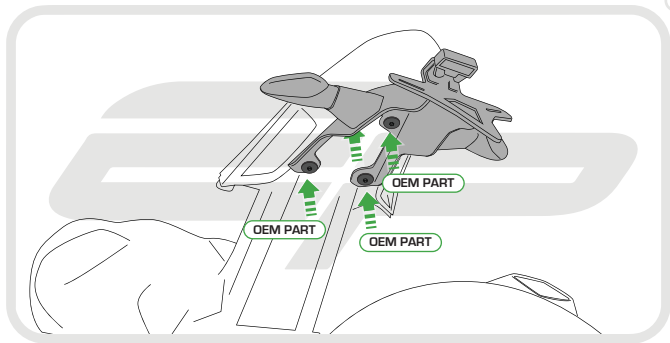

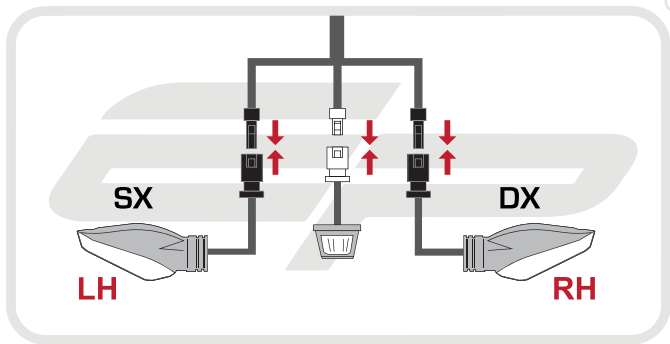



Use cable ties to neatly group wires in this area

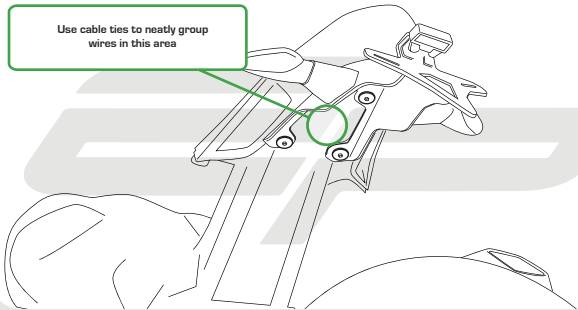



Reverse Stages

3 - 1

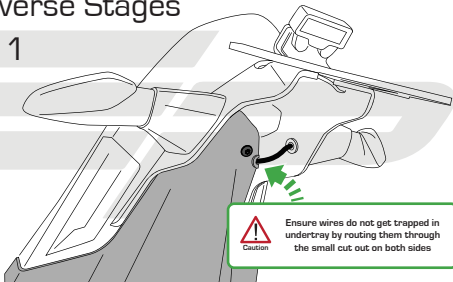

Reflector Bracket Installation

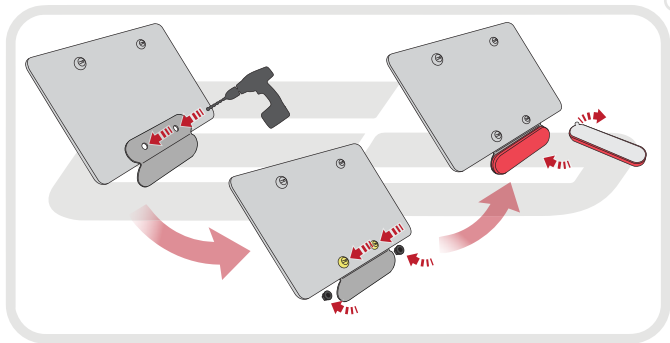

EVOTECH[®]
P E R F O R M A N C E



 **ESSENTIAL CHECKS** 

After installation of your tail tidy ensure that the licence plate does not contact the rear tyre when suspension is fully compressed.

Ensure all electrics including indicators, tail light, brake light and licence plate light lights are working correctly before riding the motorcycle.

It is recommended that periodic inspections are made to ensure that all fixings are fully tightend.



EVOTECH®
P E R F O R M A N C E

www.evotech-performance.com