



EVOTECH®
P E R F O R M A N C E

Installation Instructions



TRIUMPH TIGER 800 XCx, XR AND XRx CRASH PROTECTION

Product Reference - 12404

Kit Contents

- | | |
|------------------------------------------|------------------------------------------------|
| A 1 x RH Plate | I 1 x M10 - 90 x 1.25 Hex Bolt |
| B 1 x RH Front Bracket | J 1 x M10 - 80 x 1.25 Hex Bolt |
| C 1 x RH Frame Spacer | K 1 x M10 - 60 x 1.25 Pro Bolt |
| D 1 x RH Bobbin Spacer (Shortest) | L 2 x M10 - 110 x 1.25 Hex Bolts |
| E 1 x LH Plate | M 2 x Bobbin Heads |
| F 1 x LH Rear Bracket | N 2 x M10 Large Washers |
| G 1 x LH Frame Spacer | O 3 x M10 Standard Washers |
| H 1 x LH Bobbin Spacer (Longest) | P 4 x M8 - 20 Socket Countersink Screws |

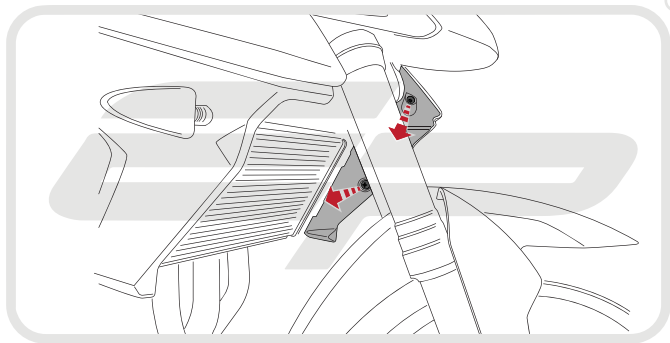

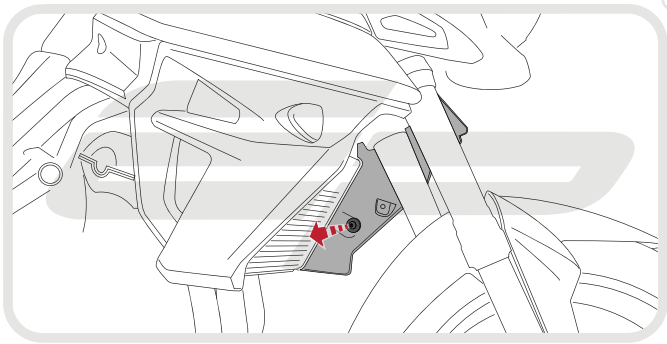

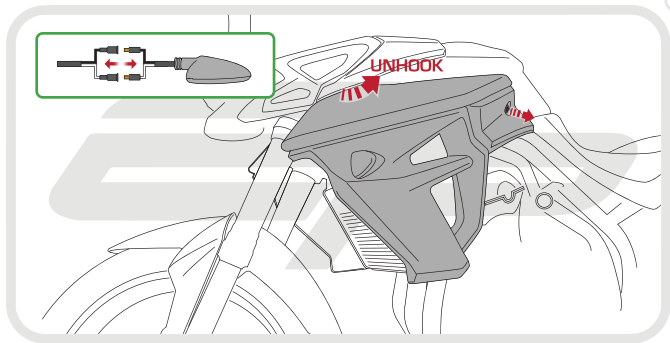

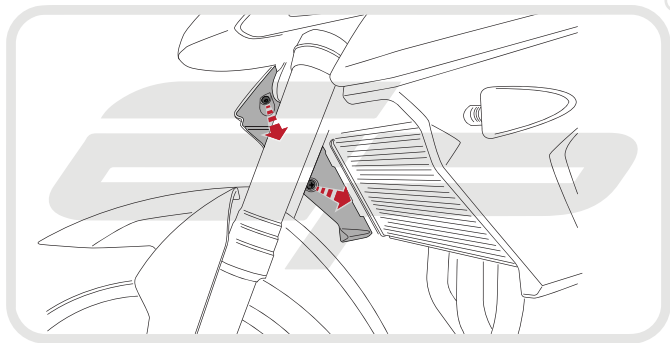

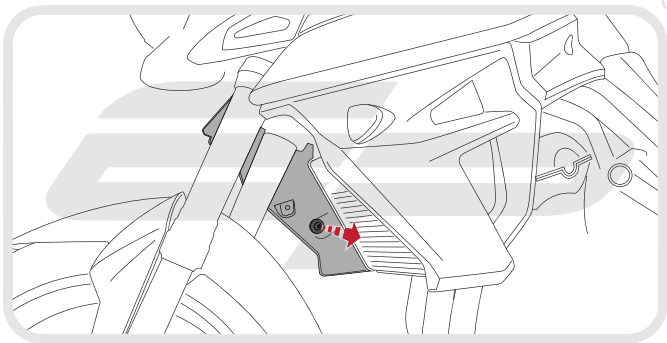

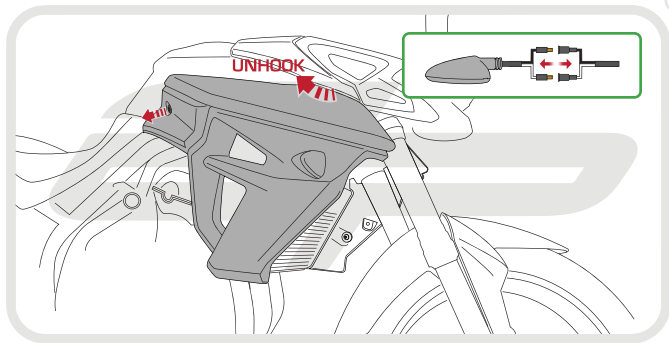



Caution

Release radiator bolt to allow radiator to pull forwards. **DO NOT** pull on any of the hoses or cables surrounding the radiator

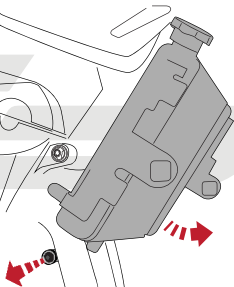



Caution

Only remove engine bolts
from one side at a time



Caution



A long reach socket will be
required to access the bolt
from the LH side of the bike



Caution

Only remove engine bolts
from one side at a time

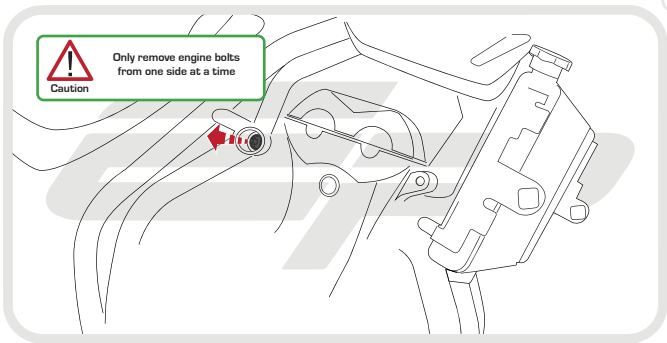

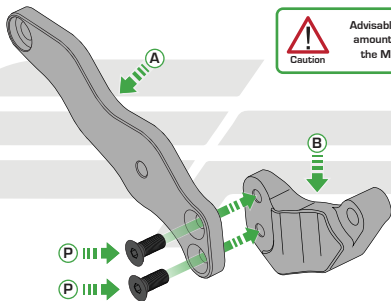



Caution

Manufacturers Torque
Specification
(Nm)



Caution



Re-fit OEM nut using a long
reach socket from the
LH side of the bike

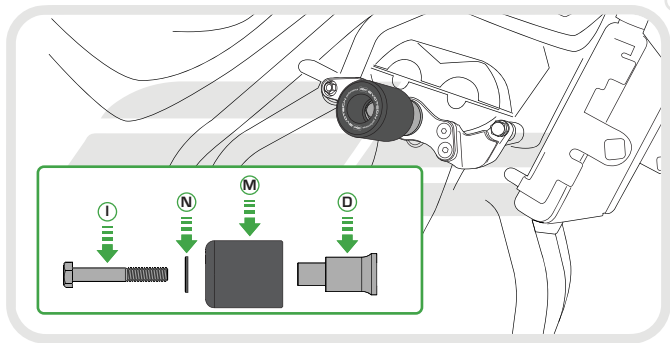

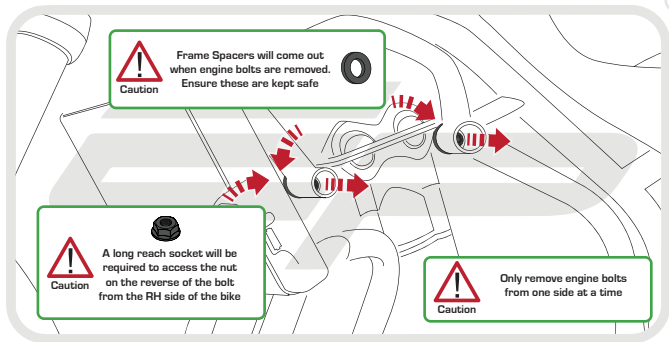

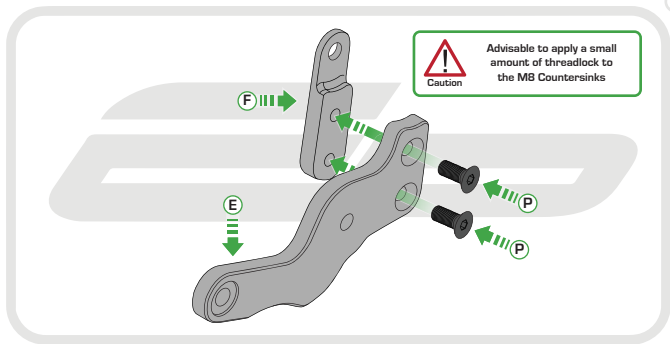

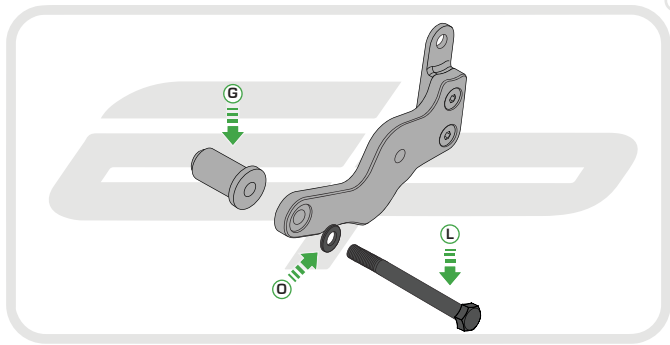

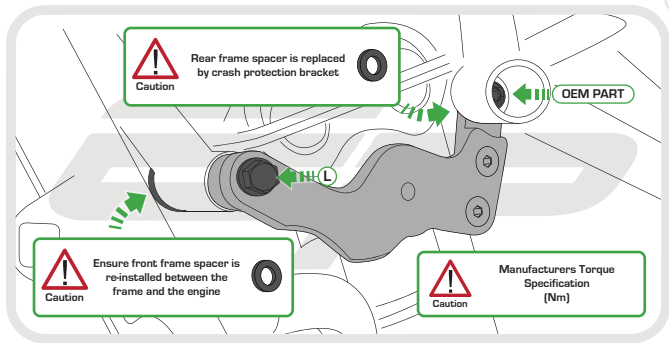

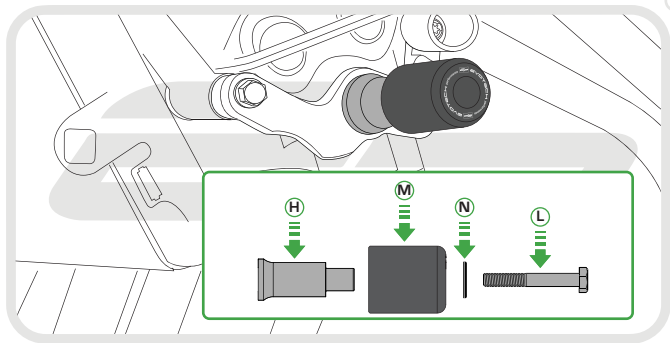



Reverse Stages

7 - 1



ESSENTIAL CHECKS



It is recommended that periodic inspections are made to ensure that all bolts are tightened to the specified torque settings.

Should the bike be involved in an accident a thorough inspection should be made and any components that have taken an impact, no matter how small, be replaced



EVOTECH®
P E R F O R M A N C E

www.evotech-performance.com