

# G

## COMPANIES FORM No. 169

### Return by a company purchasing its own shares

# 169

CHA 116

Pursuant to section 169 of the Companies Act 1985



£500  
PR  
19/6

Please do not write in this margin

To the Registrar of Companies

For official use

Company number

Please do not write in the space below. For Inland Revenue use only.

Please complete legibly, preferably in black type, or bold block lettering

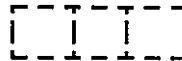

1071506

Name of company

\* ESDALE LIMITED

\* insert full name of company

This return must be delivered to the Registrar within a period of 28 days beginning with the first date on which shares to which it relates were delivered to the company

Shares were purchased by the company under section 162 of the above Act as follows:

Class of Shares	Ordinary		
Number of shares purchased	1,250		
Nominal value of each share	£1		
Date(s) on which the shares were delivered to the company	10 <sup>th</sup> June 1997		
Maximum prices paid for each share	£		
Minimum prices paid for each share	£		

§ A private company is not required to give this information

The aggregate amount paid by the company for the shares to which this return relates was: £ £100,000

Stamp duty payable pursuant to section 66 of the Finance Act 1986 on the aggregate amount at 50p per £100 or part of £100 £ £500

† Insert Director, Secretary, Receiver, Administrator, Administrative Receiver or Receiver (Scotland) as appropriate

Signed

Designation † Director

Date 10 / 6 / 1997

Presenter's name address and reference (if any):  
Whitfield Hallam Goodall  
7 King Street  
MIRFIELD  
West Yorkshire  
WF14 8AW  
DX: NO. 29642 MIRFIELD

For official Use  
General Section

