

DESIGNED BY KASAMA
COOPERATE WITH
ULTIMATE HELI-UAE

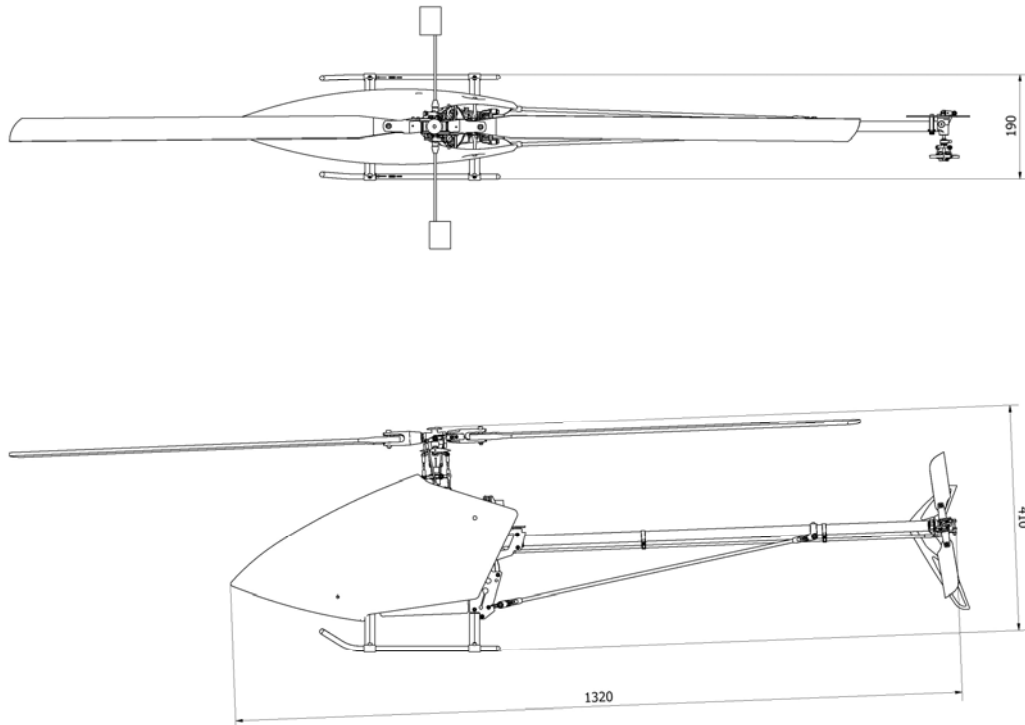

สีหมอก ไฟฟ้า ๙๐

SRI-MOK-FAI-FA 90

FAI-FA IS THAI LANGUAGE, MEAN ELECTRIC.

S R I M O K 90
THE NEXT LEVEL



INTRODUCTION

THANK YOU FOR YOUR PURCHASE OF SRIMOK 90 RADIO CONTROLLED HELICOPTER . THE SRIMOK 90 WAS DESIGNED AND DEVELOPED BY MR. KASAMA THAWORN. WITH STRONG AND FRIENDLY SUPPORT FROM ULTIMATE HELI U.A.E. IT COMBINES BOTH ELEMENTS OF HIS PREVIOUS DESIGNS , NEWLY ADVANCED TECHNOLOGIES AND MATERIALS . THE DESIGN IDEAS ARE NOT ONLY FROM FLYING , BUT ALSO FROM MANY YEARS OF RC EXPERIENCE . SO THE BEGINNERS AND ADVANCED 3-D FLIERS WILL DEFINITELY BE IMPRESSED WITH SRIMOK 90.

THIS RADIO CONTROLLED HELICOPTER IS NOT A TOY. IT IS A SOPHISTICATED PIECE OF EQUIPMENT THAT WAS DESIGNED FOR HOBBY USE ONLY .IF IT IS NOT PROPERLY ASSEMBLED , MAINTAINED OR OPERATED , IT IS CAPABLE OF CAUSING PROPERTY DAMAGE AND BODILY HARM TO BOTH OPERATOR AND/OR SPECTATORS . KASAMA HELICOPTERS CO., LTD. AFFILIATES AND ITS AUTHORIZED AFFILIATES ASSUME NO LIABILITY FOR DAMAGE THAT COULD OCCUR FROM THE ASSEMBLY, USE AND/ MISUSE OF THIS PRODUCT. IF YOU ARE NEW TO THE HOBBY WE STRONGLY RECOMMEND SEEKING HELP AND ADVICE FROM AN EXPERIENCED MODELER. SRIMOK90 IS A VERY HIGH SPEED HELICOPTER, IT WAS NOT INTENDED FOR BEGINNERS OR NOVICE BUILDING, SETUP OR FLYING.

OPERATING A MODEL HELICOPTER REQUIRES A HIGH DEGREE OF DILIGENCE AND SKILL. IF YOU ARE A NEWCOMER TO THE HOBBY , IT IS BEST TO SEEK HELP AND GUIDANCE FROM EXPERIENCED RADIO CONTROLLED HELICOPTER PILOTS . THIS WILL BOTH GREATLY SPEED UP THE LEARNING PROCESS AND MAKE IT MUCH SAFER AND ENJOYABLE.

WE ALSO WOULD STRONGLY URGE YOU TO JOIN THE ACADEMY OF MODEL AERONAUTICS. THE AMA IS A NON-PROFIT ORGANIZATION THAT PROVIDES ITS MEMBER WITH A LIABILITY INSURANCE PLAN AS WELL AS MONTHLY MAGAZINE ENTITLED MODEL AVIATION .ALL CLUBS OPERATE IN ACCORDANCE WITH AMA PRINCIPLES AT THEIR FIELDS. FOR FURTHER INFORMATION ,CONTACT THE AMA AT

ACADEMY OF MODEL AERONAUTICS

5151 EAST MEMORIAL DRIVE

MUNCIE, IN47302

[317] 287-1256

INDEX

SECTION DESCRIPTION	PAGE	SECTION DESCRIPTION	PAGE
INTRODUCTION	3	CYBER CENTER HUB INSTALLATION	30
INDEX	4	ROTOR GRIP BLADE INSTALLATION	31
LANDING GEAR ASSEMBLY	5	TAIL ROTOR HEAD ASSEMBLY	32
MAIN FRAME L ASSEMBLY	6	PRE INSTALLATION TAIL BOOM	33
MAIN FRAME R ASSEMBLY	7	MARK AND DRILL TAIL BOOM	34
MAIN FRAME INSTALLATION	8	TORQUE TUBE ASSEMBLY	35
BEVEL PINION GEAR ASSEMBLY	9	TAIL BOOM ASSEMBLY	36
BEVEL PINION GEAR INSTALLATION	10	CANOPY INSTALLATION	37
TAIL BOOM CLAMP ASSEMBLY	11		
MAIN BEARING BLOCK ASSEMBLY	12		
CYCLIC SERVO MOUNT AND RADIUS ARM STAY ASSEMBLY	13		
MAIN GEAR ASSEMBLY	14		
MAIN SHAFT AND MAIN GEAR INSTALLATION	15		
HOW TO ADJUST BEVEL PINION GEAR .	16		
TAIL BELL CRANK AND TAIL SERVO INSTALLATION	17		
ELEVATOR SERVO ASSEMBLY.....	18		
CYCLIC SERVO ASSEMBLY.....	19		
CYCLIC SERVO INSTALLATION	20		
MOTOR MOUNT ASSEMBLY	21		
PINION BEARING DRIVE ASSEMBLY.....	22		
BATTERY TRAY INSTALLATION	23		
SWASH PLATE AND LINK INSTALLATION	24		
WASH OUT ARM INSTALLATION	25		
CENTER HUB AND SEESAW INSTALLATION	26		
ROTOR GRIP BLADE INSTALLATION	27		
ROTOR HEAD LINKAGE	28		
SWASH PLATE DRIVE INSTALLATION ...	29		

Thank you very much to

Georges Van Gansen
Scorpion Power System Ltd.

Technical support speed control and motor setup.

PLEASE READ THIS MANUAL CAREFULLY BEFORE INSTALLATION

DETAIL A

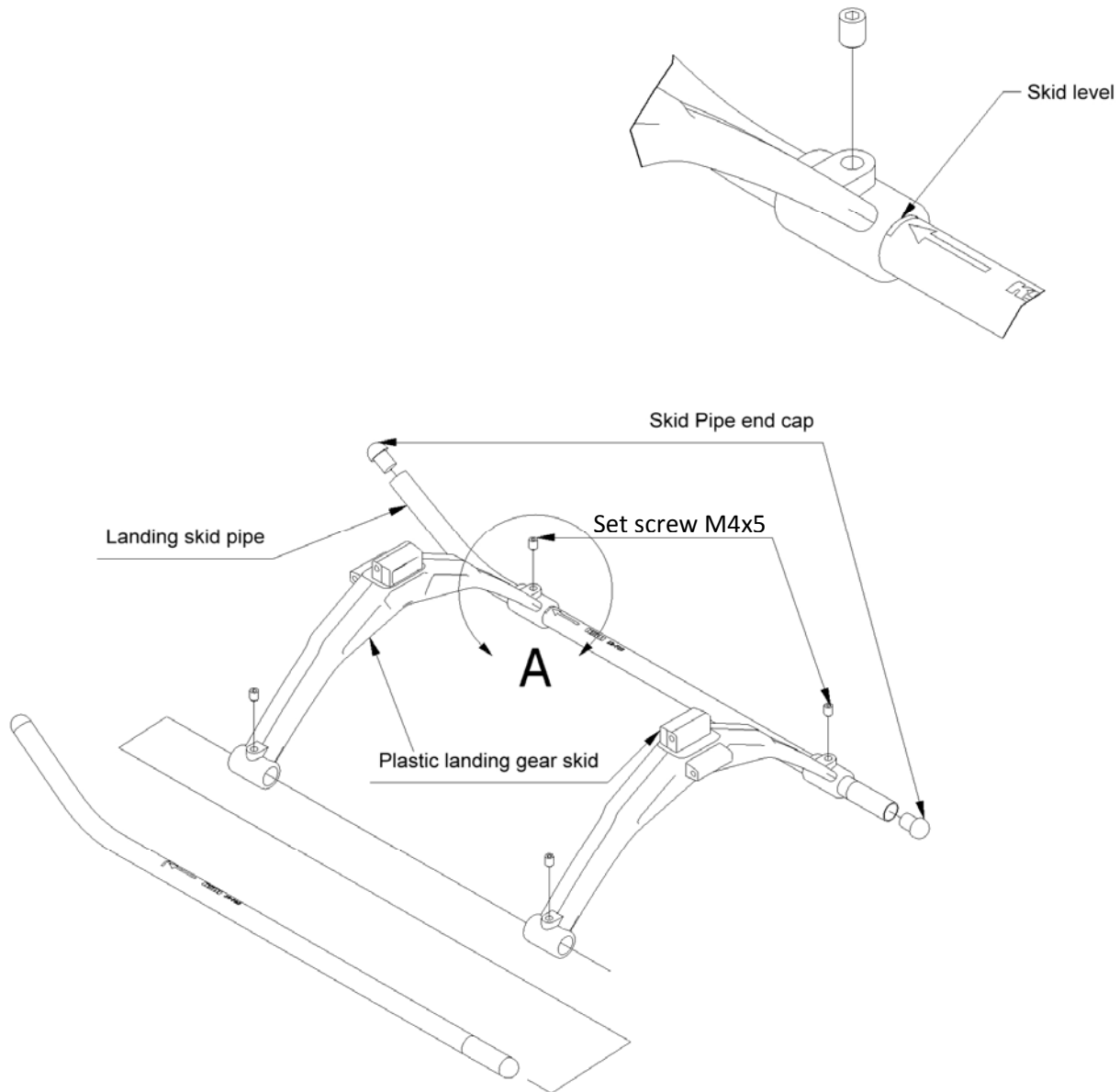

PARTS LIST			
ITEM	PART NUMBER	DESCRIPTION	QTY
1	KSM70-F18H	Plastic landing gear skid	2
2	KSM60-019	Set screw M4x5	4
3	KSM10-F25	Landing skid pipe	2
4	KSM70-F09	Skid pipe end cap	4

Note: Apply Blue thread lock to all screws, balls, and threads which it be fixed to metal-parts. For non-metal parts apply CA Glue.

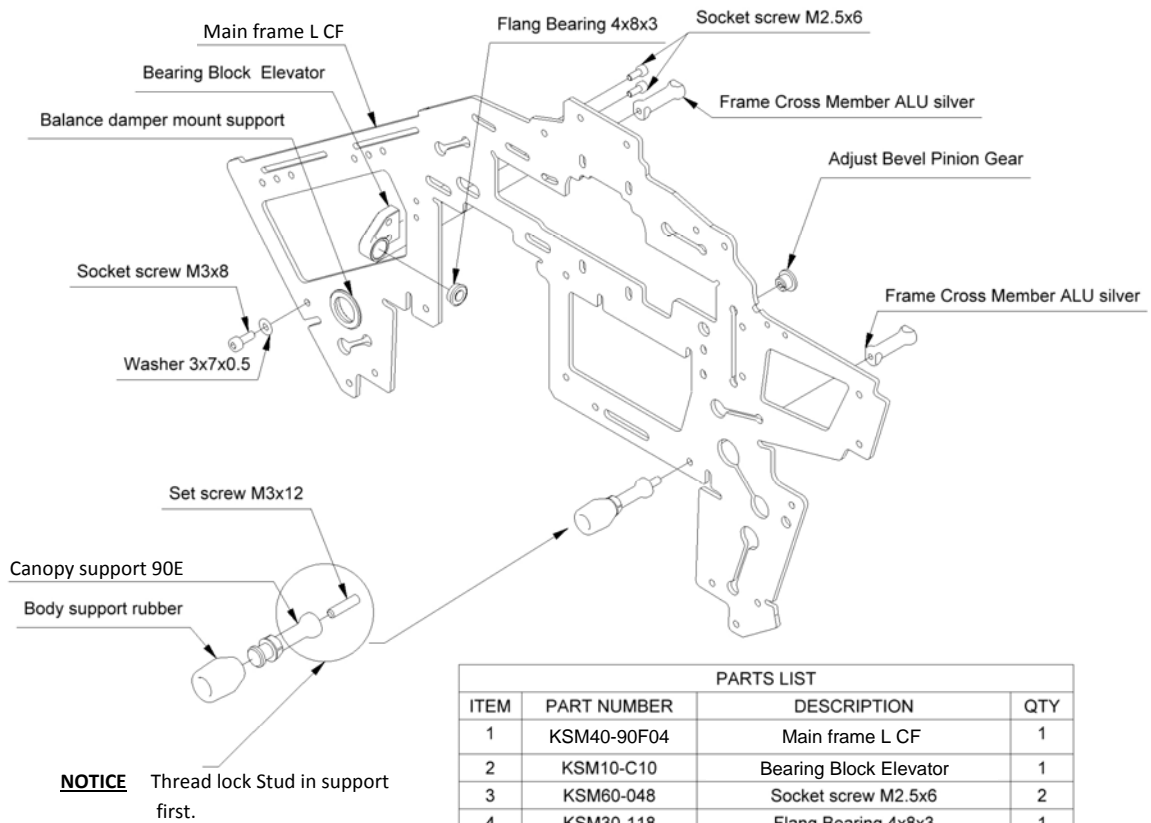

PARTS LIST			
ITEM	PART NUMBER	DESCRIPTION	QTY
1	KSM40-90F04	Main frame L CF	1
2	KSM10-C10	Bearing Block Elevator	1
3	KSM60-048	Socket screw M2.5x6	2
4	KSM30-118	Flang Bearing 4x8x3	1
5	KSM10-F02	Frame Cross Member ALU silver	2
6	KSM10-F27	Balance damper mount support	1
7	KSM60-034	Socket screw M3x8	1
8	KSM60-029	Washer 3x7x0.5	3
9	KSM20-TS09	Adjust Bevel Pinion Gear	1
10	KSM10-F32	Canopy support 90E	1
11	KSM60-062	Set screw M3x12	1
12	KSM70-F11	Body support rubber	1
13	KSM60-031	Socket screw M3x32	2

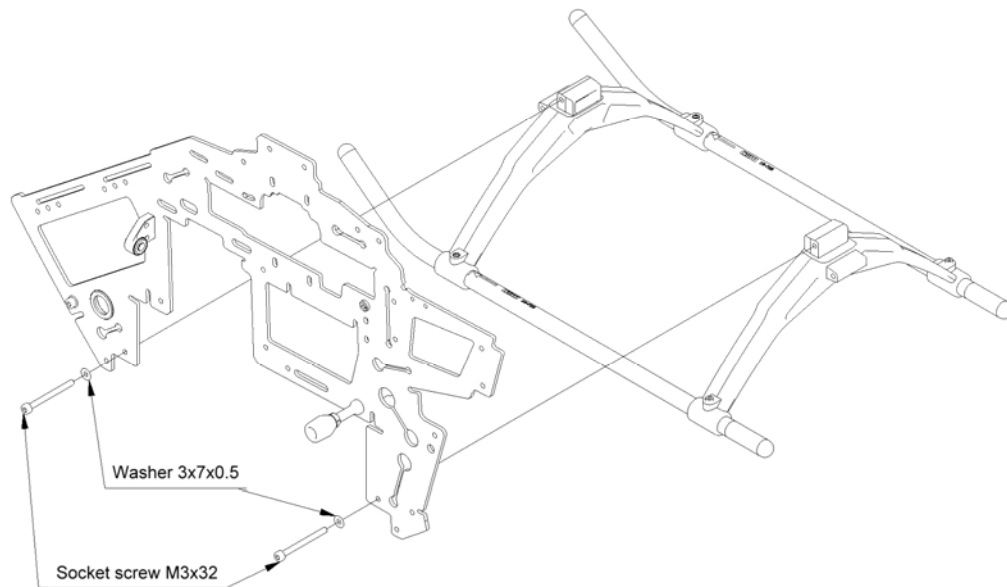

Note: Apply Blue thread lock to all screws, balls, and threads which it be fixed to metal-parts. For non-metal parts apply CA Glue.

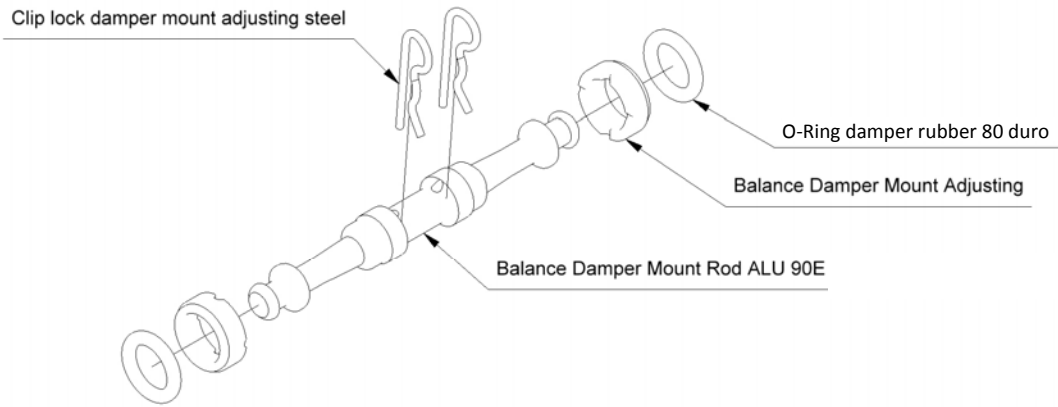

PARTS LIST			
ITEM	PART NUMBER	DESCRIPTION	QTY
1	KSM70-F08	Clip lock damper mount adjusting steel	2
2	KSM10-F11	Balance Damper Mount Rod ALU 90E	1
3	KSM70-F06	Balance Damper Mount Adjusting	2
4	KSM70-H06	O-Ring damper rubber 80 duro	2

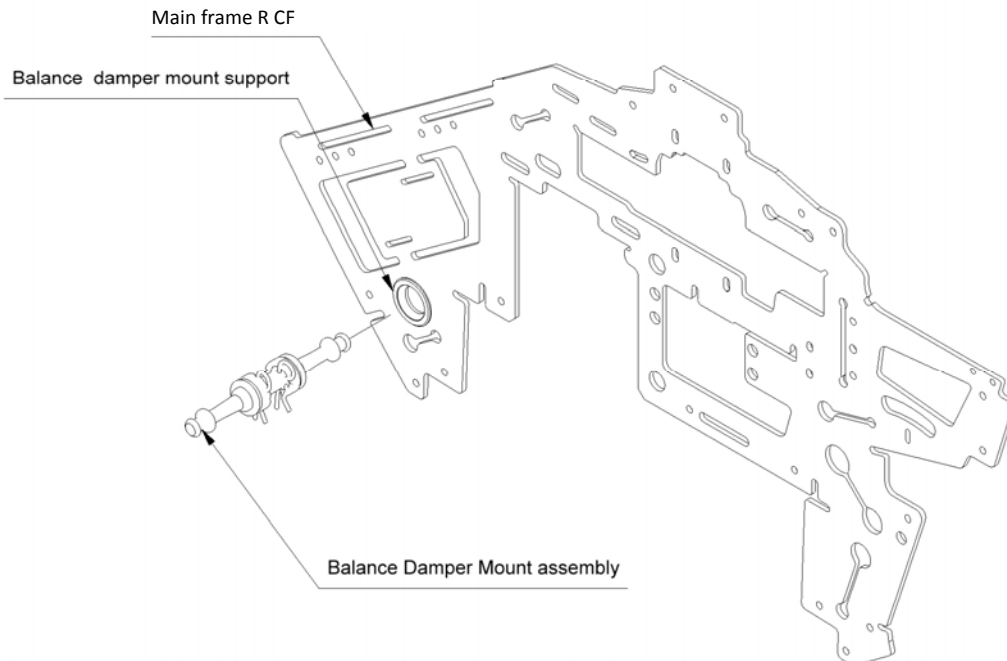

PARTS LIST			
ITEM	PART NUMBER	DESCRIPTION	QTY
1	KSM40-90F03	Main frame R CF	1
2	KSM10-F27	Balance damper mount support	1

Note: Apply Blue thread lock to all screws, balls, and threads which it be fixed to metal-parts. For non-metal parts apply CA Glue.

NOTICE Thread lock Stud in support first.

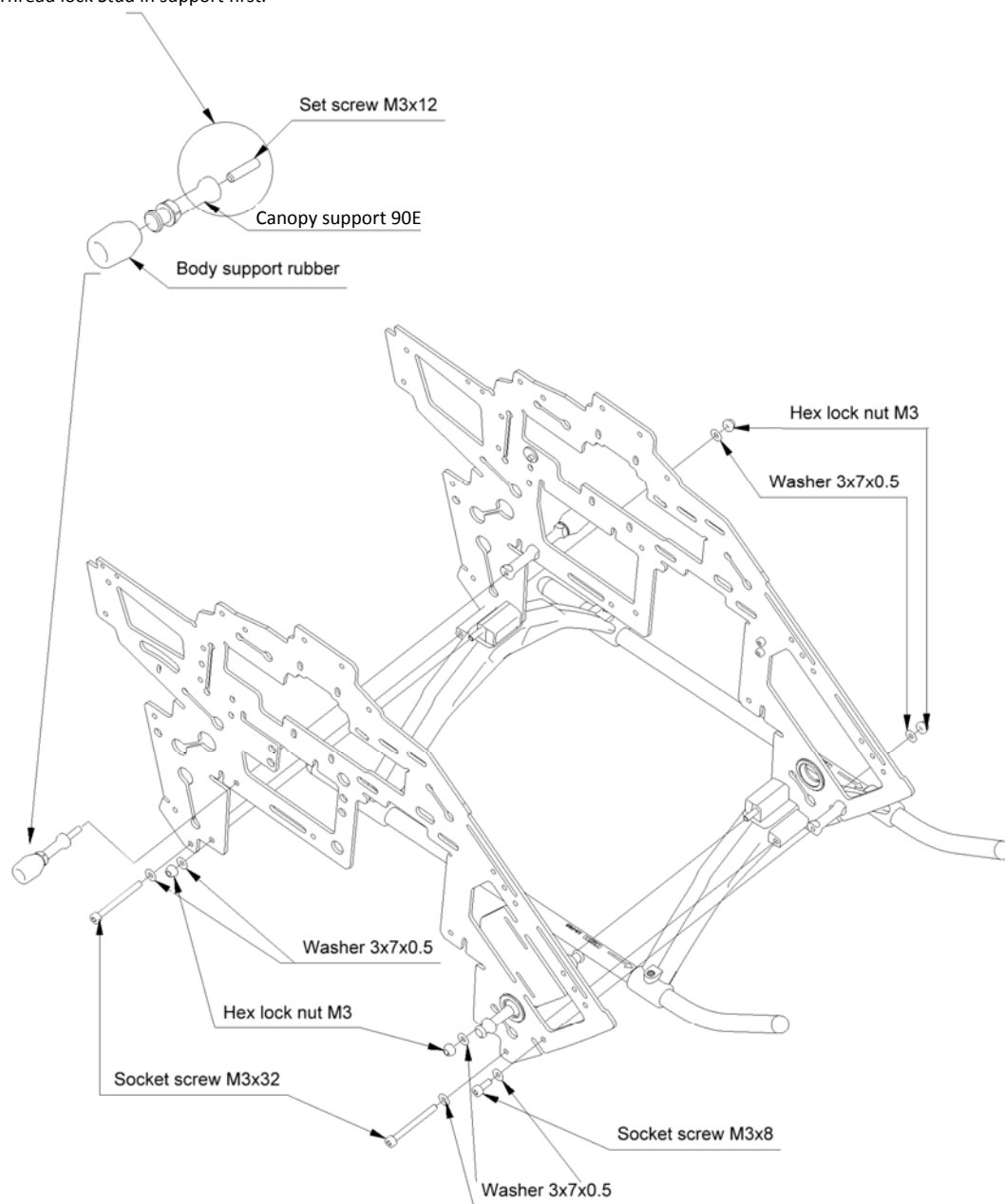

PARTS LIST			
ITEM	PART NUMBER	DESCRIPTION	QTY
1	KSM10-F32	Canopy support 90E	1
2	KSM60-062	Set screw M3x12	1
3	KSM60-029	Washer 3x7x0.5	7
4	KSM60-031	Socket screw M3x32	2
5	KSM60-027	Hex lock nut M3	4
6	KSM60-034	Socket screw M3x8	1
7	KSM70-F11	Body support rubber	1

Note: Apply Blue thread lock to all screws, balls, and threads which it be fixed to metal-parts. For non-metal parts apply CA Glue.

PARTS LIST			
ITEM	PART NUMBER	DESCRIPTION	QTY
1	KSM10-T28	Bevel Pinion Bearing block 90E	1
2	KSM30-117	Ball Bearing 6x13x5	2
3	KSM20-T12	Output Bevel Gear15T	1
4	KSM10-TS19	Tail Drive Joint Front ALU silver(6mm.)	1
5	KSM20-T11	Tran Output Shaft	1
6	KSM60-056	Socket screw M2.5x8	2
7	KSM60-002	Set screw M3x4	4

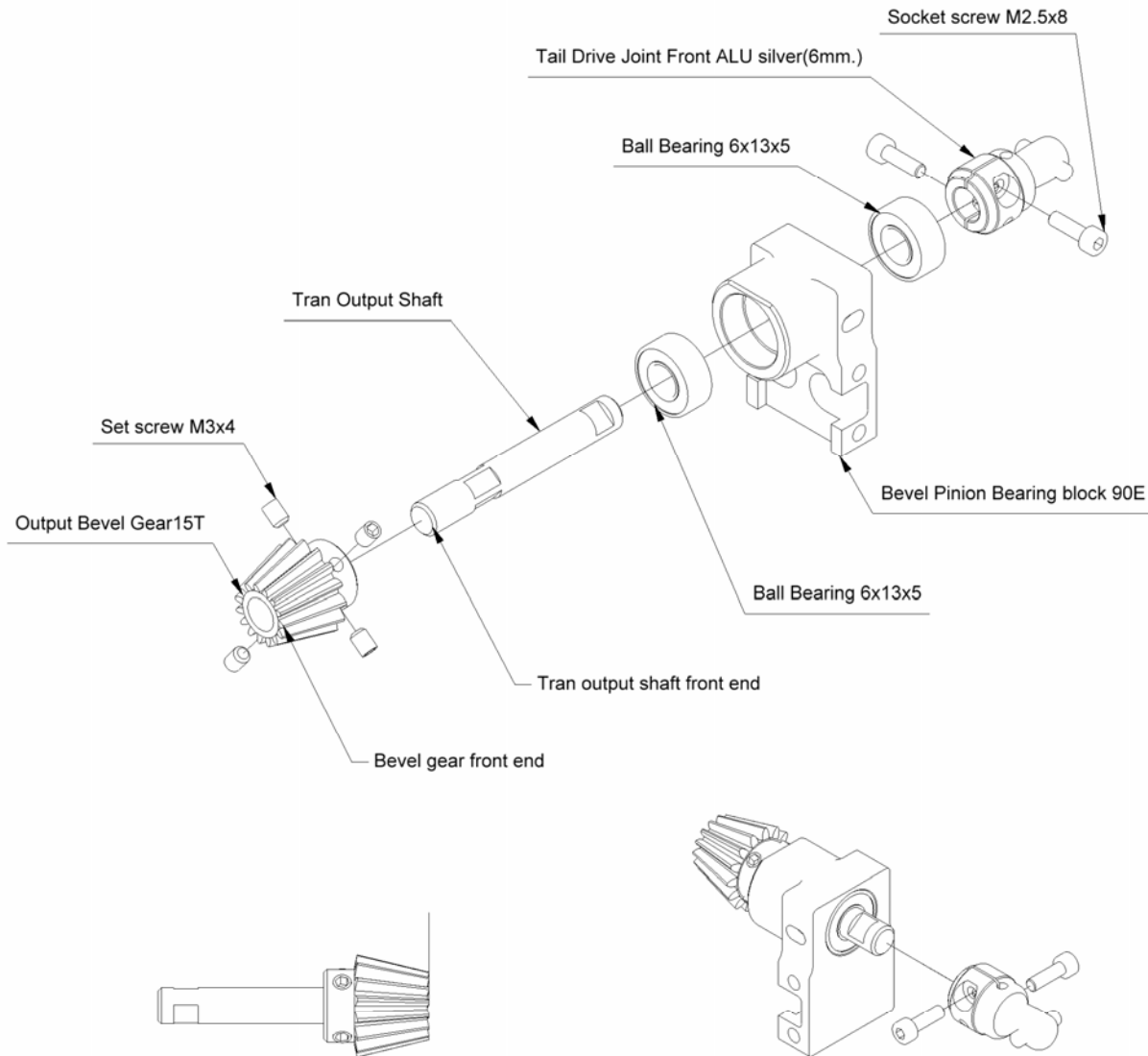

NOTICE :The pinion shaft must reach and be level with the end of the front bevel gear.

NOTICE : Press the two parts together and tighten the 4 set M3 set screws. Make sure the shaft runs smoothly.

Note: Apply Blue thread lock to all screws, balls, and threads which it be fixed to metal-parts. For non-metal parts apply CA Glue.

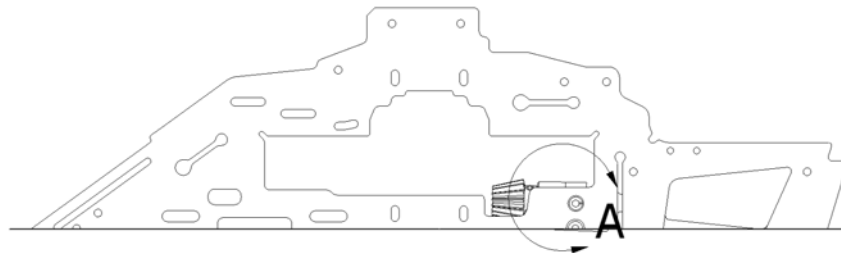

DETAIL A

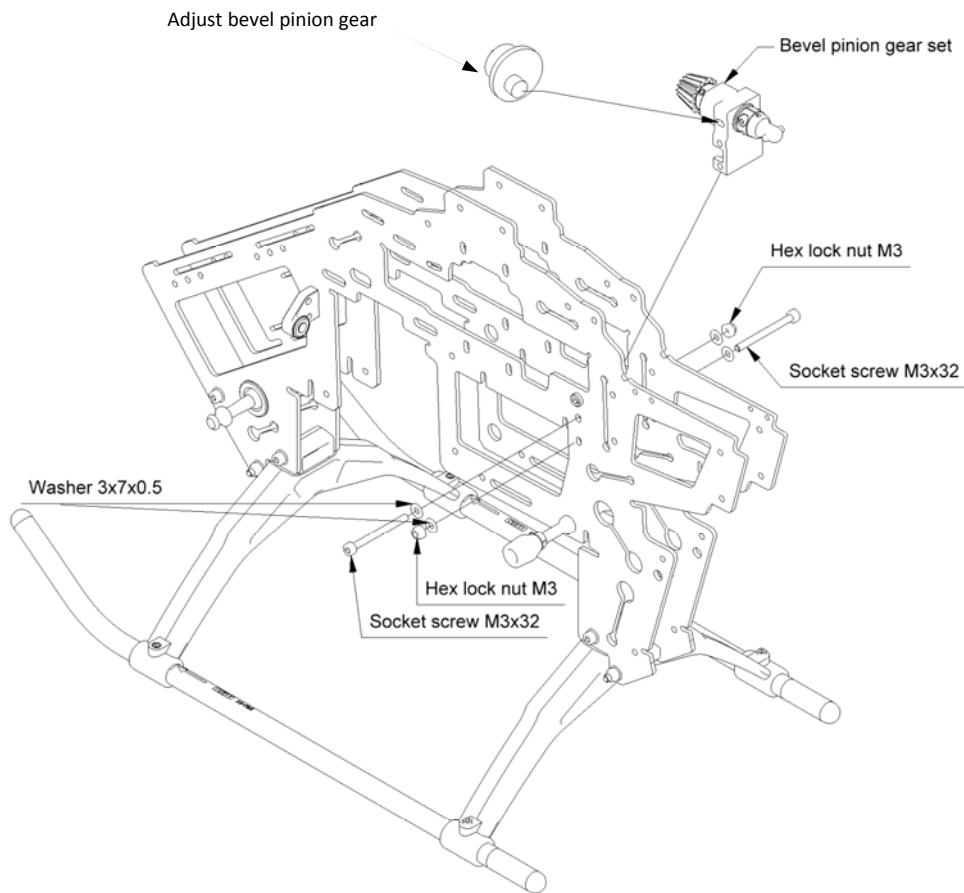
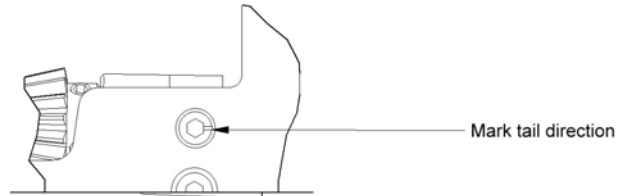

PARTS LIST			
ITEM	PART NUMBER	DESCRIPTION	QTY
1	KSM60-031	Socket screw M3x32	2
2	KSM60-029	Washer 3x7x0.5	4
3	KSM60-027	Hex lock nut M3	2

Note: Apply Blue thread lock to all screws, balls, and threads which it be fixed to metal-parts. For non-metal parts apply CA Glue.

Boom should reach to the end of the clamp and fill cutout.

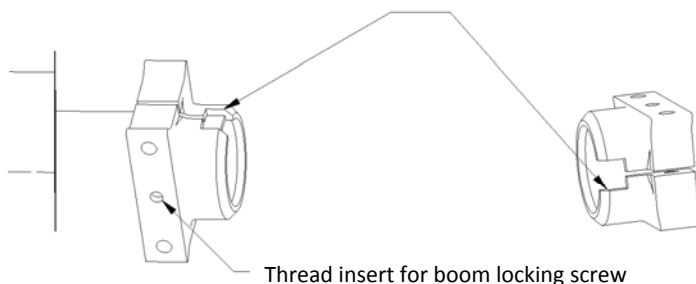

You may have to shim with thin plastic size 120x18mm.

Parts List			
ITEM	PART NUMBER	DESCRIPTION	QTY
1	KSM60-027	Hex lock nut M3	4
2	KSM60-031	Socket screw M3x32	4
3	KSM60-029	Washer M3x7x0.5	8
4	KSM10-T06	Tail boom clamp front ALU silver	1
5	KSM10-T07	Tail boom clamp rear ALU silver	1

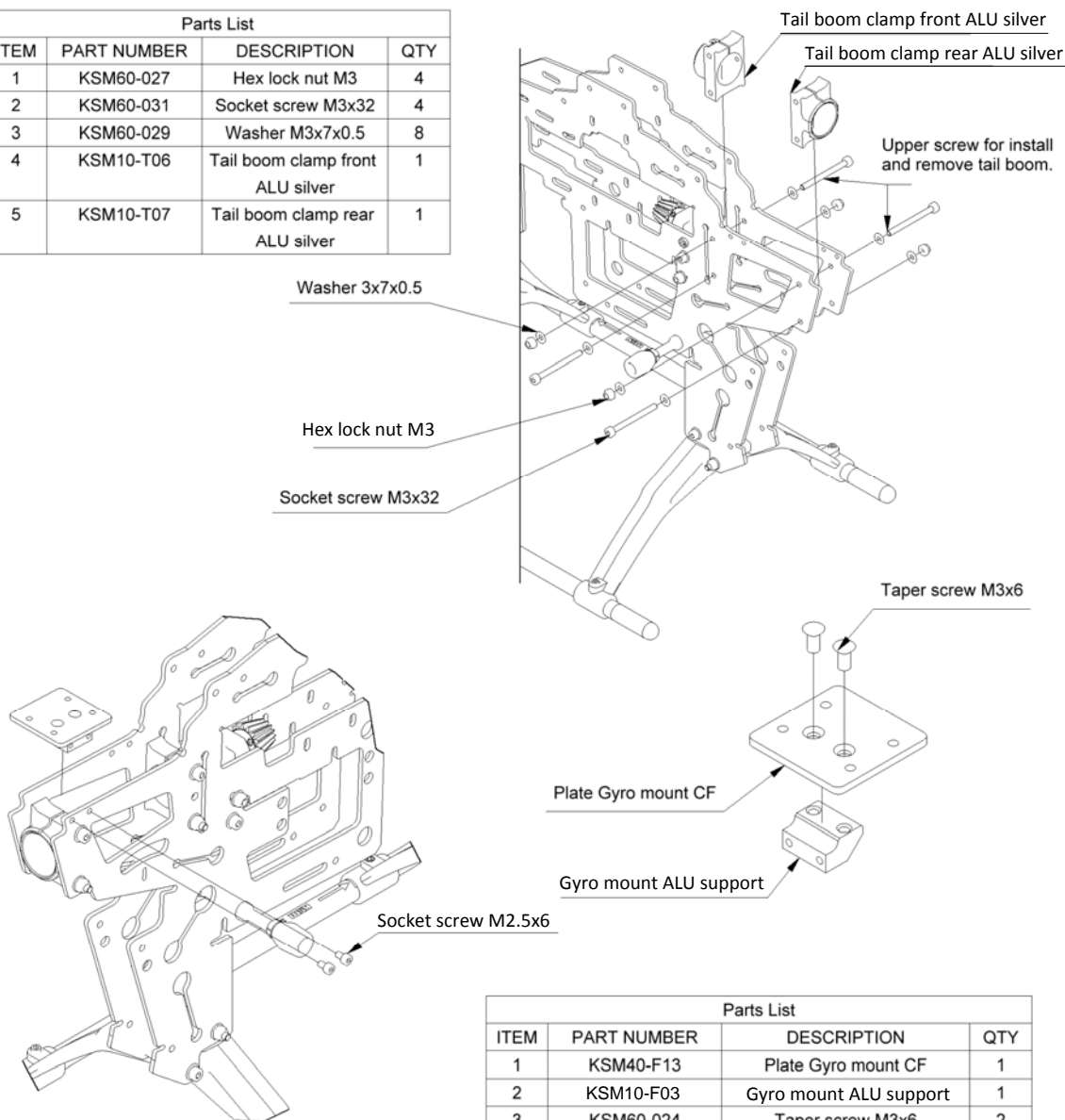

Parts List			
ITEM	PART NUMBER	DESCRIPTION	QTY
1	KSM40-F13	Plate Gyro mount CF	1
2	KSM10-F03	Gyro mount ALU support	1
3	KSM60-024	Taper screw M3x6	2
4	KSM60-048	Socket screw M2.5x6	2

Note: Apply Blue thread lock to all screws, balls, and threads which it be fixed to metal-parts. For non-metal parts apply CA Glue.

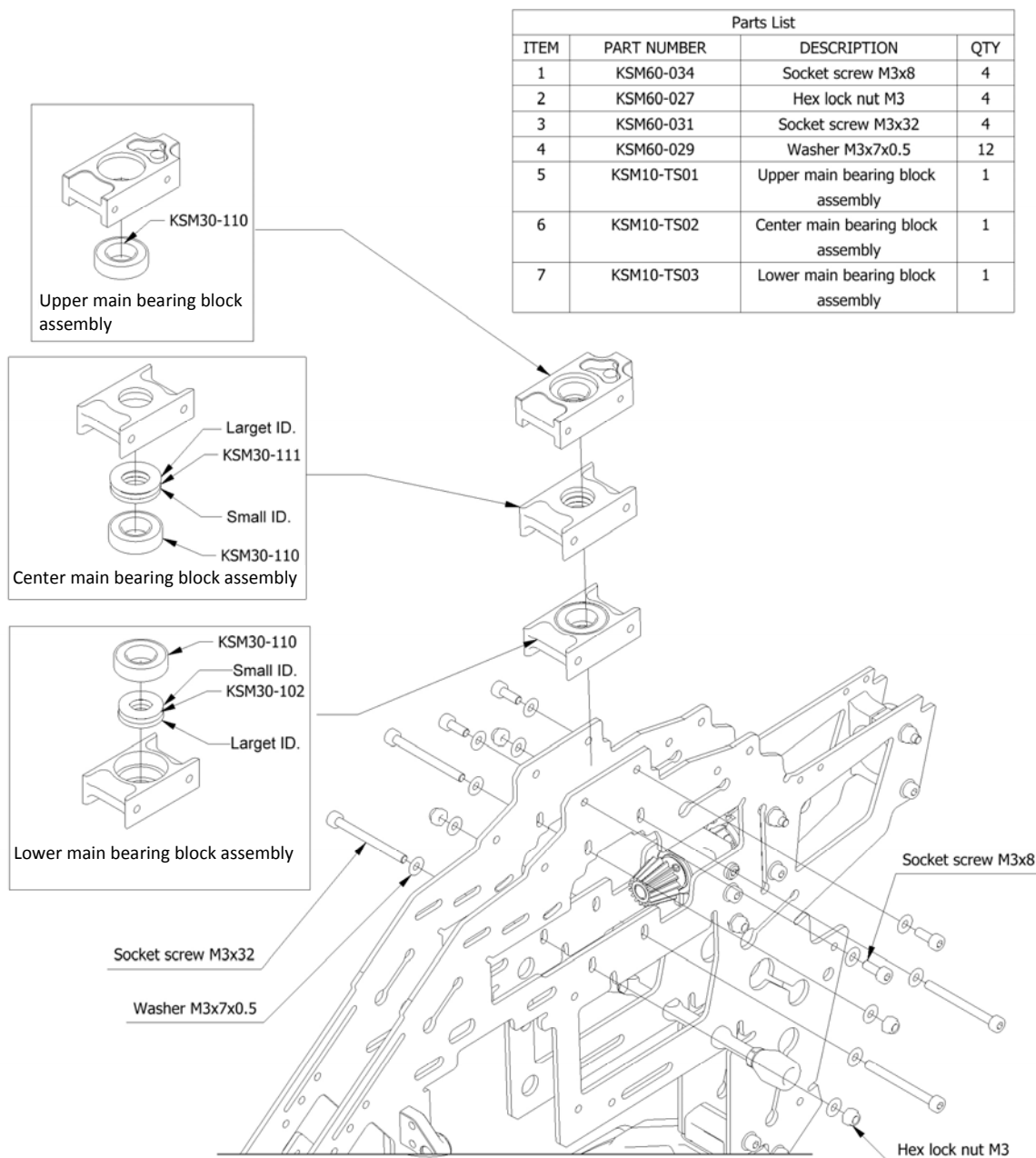

BEARING BLOCK INSTALLATION

- 1) Slide Lower and Center main bearing block assembly into place between the CF frames and insert M3x32 bolts and apply washers and nuts.
- 2) Insert Upper main bearing block assembly and insert M3x8 screws but do not tighten.
- 3) Insert mast through 3 bearing blocks.
- 4) Push DOWN on Lower main bearing block assembly and gently tighten bolts.
- 5) Push UP on Center main bearing block assembly and gently tighten bolts.
- 6) Tighten Upper main bearing block assembly with M3 bolts and remove mast - remove Upper main bearing block assembly bolts one at a time – thread lock and re-tighten.

Note: Apply Blue thread lock to all screws, balls, and threads which it be fixed to metal-parts. For non-metal parts apply CA Glue.

PARTS LIST			
ITEM	PART NUMBER	DESCRIPTION	QTY
1	KSM60-062	Set screw M3x12	2
2	KSM10-F15	Body mount 90E	2
3	KSM60-034	Socket screw M3x8	2
4	KSM10-F23	Cyclic ALU servo mount	1
5	KSM60-029	Washer 3x7x0.5	2
6	KSM40-C04	Bearing Plate cyclic Lever	1
7	KSM60-033	Socket screw M3x6	2
8	KSM30-118	Flang Bearing 4x8x3	2

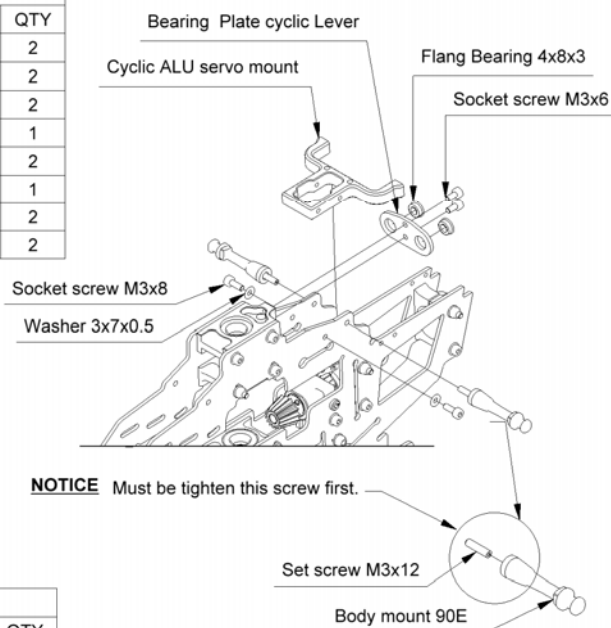
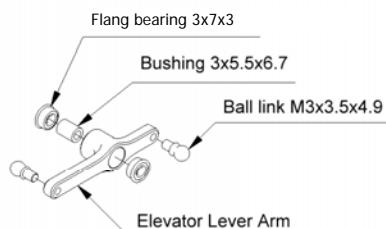

PARTS LIST			
ITEM	PART NUMBER	DESCRIPTION	QTY
1	KSM10-C04	Radius Arm Stay ALU silver	1
2	KSM40-C02	Elevator Lever Stay CF (rear)	1
3	KSM40-C03	Elevator Lever Stay CF (front)	1
4	KSM60-061	Elevator Lever Stay Spacer	1
5	KSM60-027	Hex lock nut M3	3
6	KSM60-004	Button screw M3x15	2
7	KSM30-104	Flang bearing 3x7x3	2
8	KSM60-013	Bushing 3x5.5x6.7	1
9	KSM10-C06	Elevator Lever Arm	1
10	KSM60-028	Socket screw M3x28	1
11	KSM53-110	Ball link M3x3.5x4.9	2
12	KSM60-029	Washer 3x7x0.5	3
13	KSM60-030	Washer 0.5 mm	1

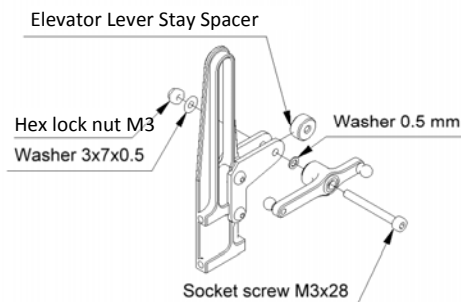
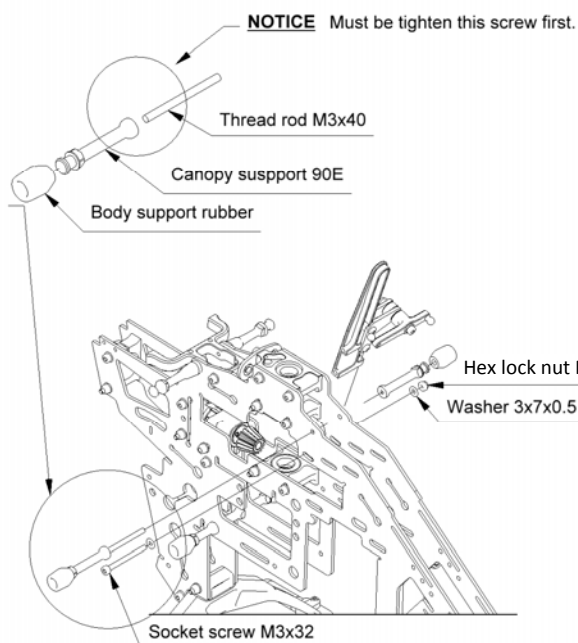
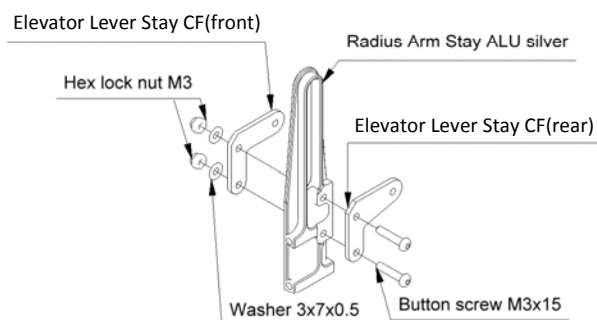

PARTS LIST			
ITE	PART NUMBER	DESCRIPTION	QTY
1	KSM60-032	Thread rod M3x40	1
2	KSM60-029	Washer 3x7x0.5	2
3	KSM60-027	Hex lock nut M3	1
4	KSM60-031	Socket screw M3x32	1
5	KSM10-F07	Canopy support 90E	2
6	KSM70F11	Body support rubber	2

Note: Apply Blue thread lock to all screws, balls, and threads which it be fixed to metal-parts. For non-metal parts apply CA Glue.

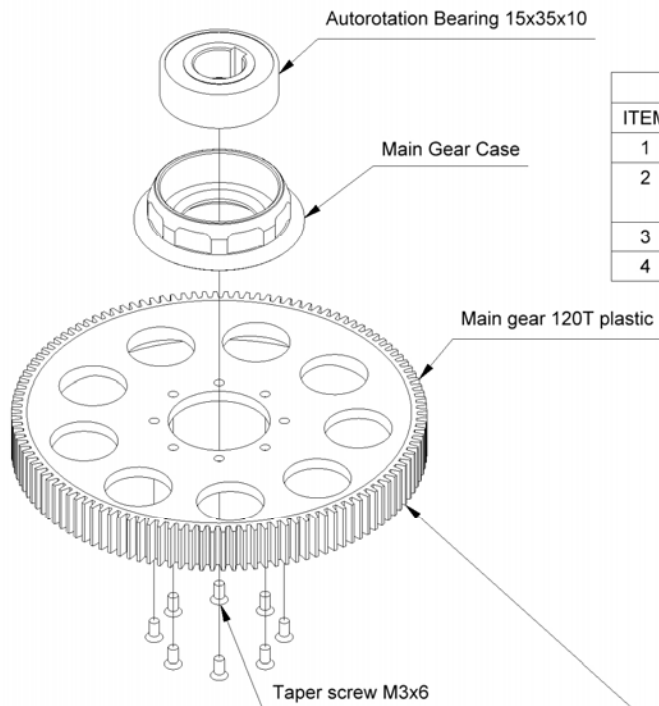

Parts List			
ITEM	PART NUMBER	DESCRIPTION	QTY
1	KSM10-TS16	Main Gear Case	1
2	KSM30-112	Autorotation Bearing 15x35x10	1
3	KSM70-TS10	Main gear 120T plastic	1
4	KSM60-024	Taper screw M3x6	8

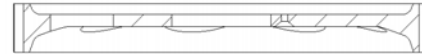

Main Gear Direction

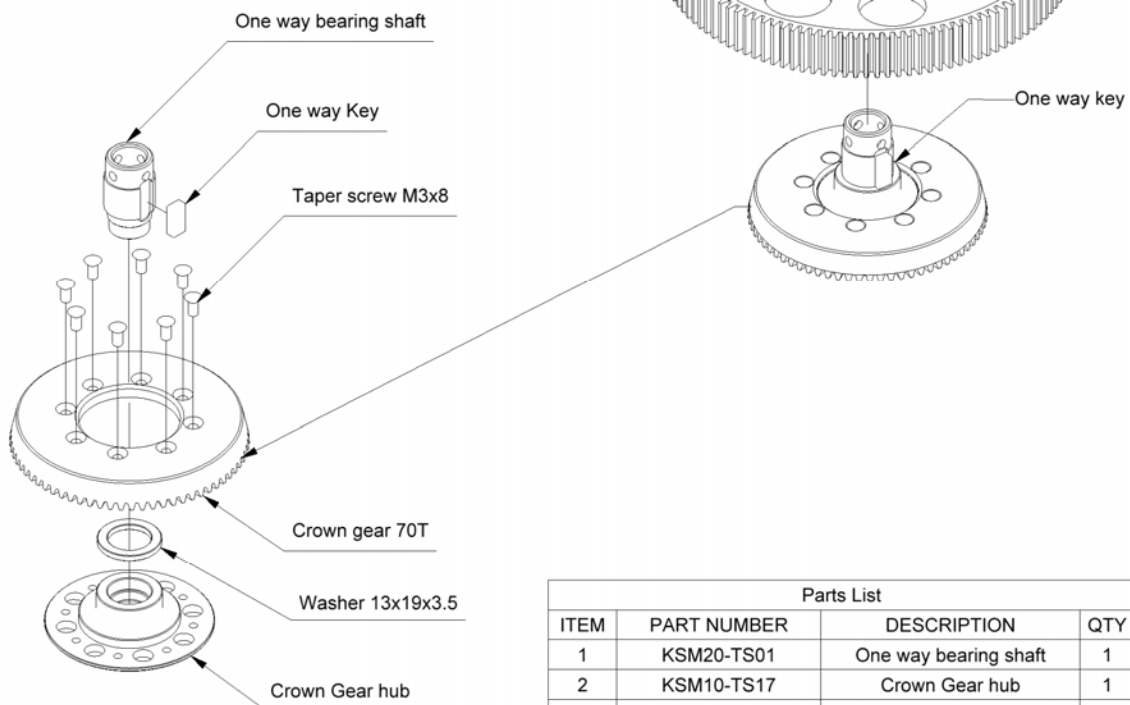

Parts List			
ITEM	PART NUMBER	DESCRIPTION	QTY
1	KSM20-TS01	One way bearing shaft	1
2	KSM10-TS17	Crown Gear hub	1
3	KSM30-125	One way Key	1
4	KSM60-025	Taper screw M3x8	8
5	KSM70-TS04	Crown gear 70T	1
6	KSM60-037	Washer 13x19x3.5	1

Note: Apply Blue thread lock to all screws, balls, and threads which it be fixed to metal-parts. For non-metal parts apply CA Glue.

Parts List			
ITEM	PART NUMBER	DESCRIPTION	QTY
1	KSM20-TS03	Mast lock Pin steel	1
2	KSM20-TS02	Main Mast 10x212.5 mm. steel hard black	1
3	KSM10-TS15	Mast lock ALU	1
4	KSM60-026	Socket screw M2.5x15	1

TEST ASSEMBLE THE MAIN SHAFT AND MAIN GEAR

1. Insert the main mast into the main gear set. Adjust the holes of the main mast, mast lock and one way shaft bearing to the same position.

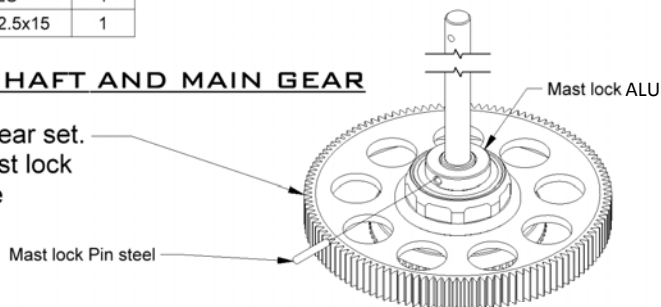

2. Insert mast lock pin into that hole. Then lock the mast lock cap by turning it at the same direction as the arrow to close that hole.

NOTICE: the Arrow mark direction was shown on the mast cap.

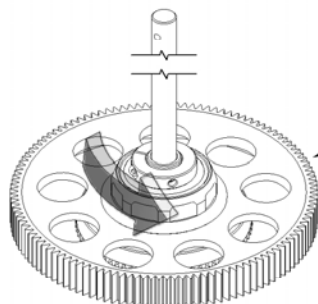

3. To close the gap between crown gear and main gear unit, push the mast cap lock downward before tightening M2.5x15 firmly.

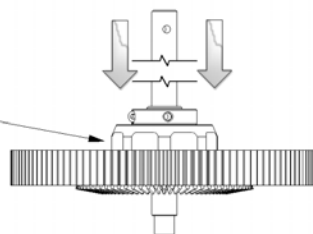

MAIN GEAR INSTALLATION TO FRAME

Main mast 10x212.5 mm. steel hard black

Slide in from this side only (Frame L)

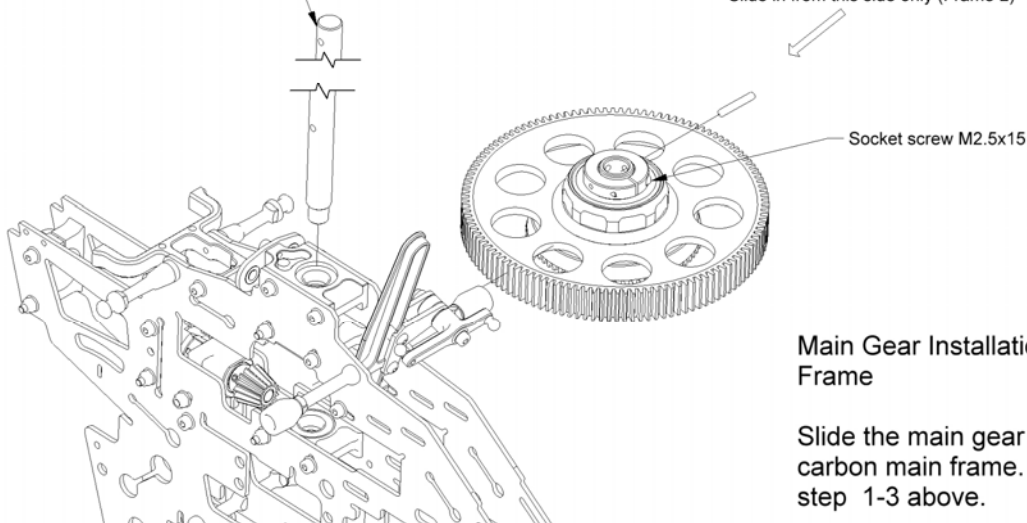

Main Gear Installation to Frame

Slide the main gear to the carbon main frame. Follow step 1-3 above.

Note: Apply Blue thread lock to all screws, balls, and threads which it be fixed to metal-parts. For non-metal parts apply CA Glue.

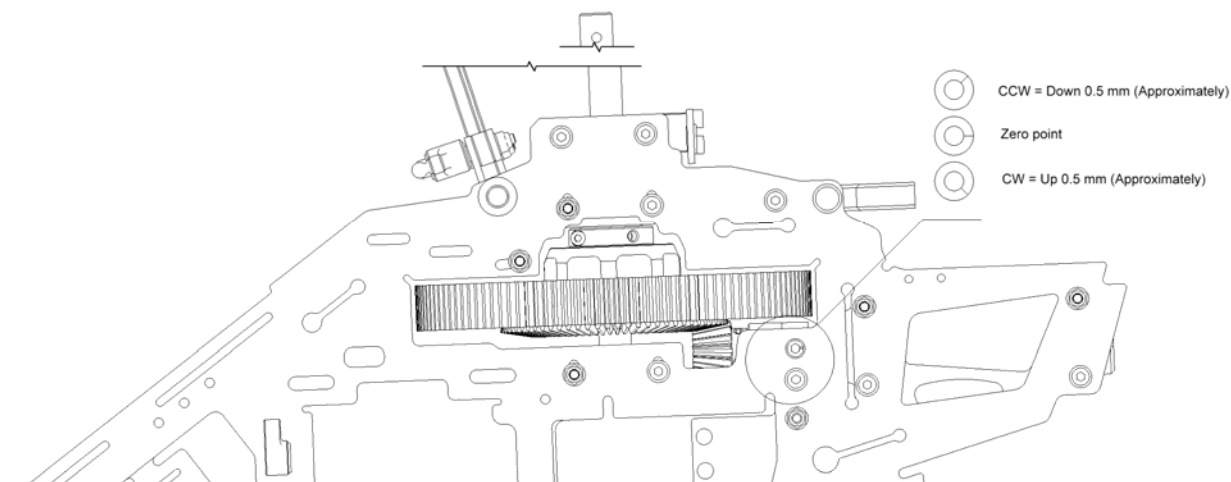

BEVEL PINION GEAR ADJUSTMENT

After Main Gear is inserted you can adjust bevel gear up and down 1mm by turning the Bevel Gear Adjuster clockwise to raise the bevel gear and anti-clockwise to lower it.

- 1) Raise the bevel gear to its highest position by turning the Adjuster clockwise - Lock bevel gear block in place by tightening the two M3x32 bolts.
- 2) Loosen Lower Bearing Block bolts and push block down to allow Main Crown Gear to sit on Bevel Gear.
- 3) Loosen Center Bearing Block bolts and push it down to sit on top of One Way Bearing then tighten M3x32 bolts firmly.
- 4) Loosen Lower Bearing Block M3 bolts and push Block up till it rests on the bottom of the OWB and tighten bolts.
- 5) Test Main Gear end-float by pulling Main Shaft up and down.
- 6) If there is no end-float tighten Lower and Center Bearing Block mounting bolts firmly - if there is movement of gear and mast repeat steps 2-4.
- 7) Loosen Bevel Gear Block M3 bolts and rotate Adjuster until Bevel Gear has ~0.3-0.5mm backlash on Main Gear. You can also 'tune it' by ear by spinning main gear till you get the smoothest and quietest sound of the gears running.

TAIL BELL CRANK ASSEMBLY

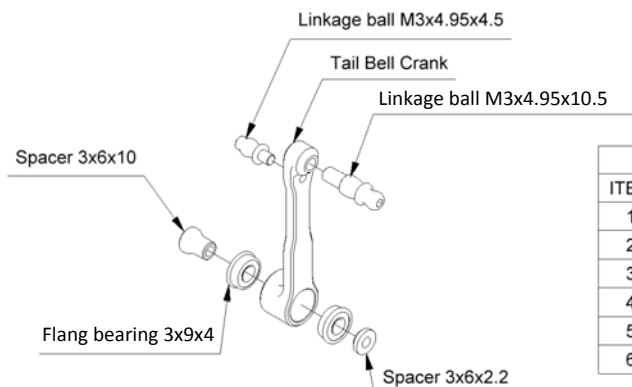

Parts List			
ITEM	PART NUMBER	DESCRIPTION	QTY
1	KSM60-064	Spacer 3x6x2.2	1
2	KSM53-108	Linkage ball M3x4.95x4.5	1
3	KSM10-T02	Tail Bell Crank	1
4	KSM53-115	Linkage ball M3x4.95x10.5	1
5	KSM30-121	Flang bearing 3x9x4	2
6	KSM60-065	Spacer 3x6x10	1

Note: Apply Blue thread lock to all screws, balls, and threads which it be fixed to metal-parts. For non-metal parts apply CA Glue.

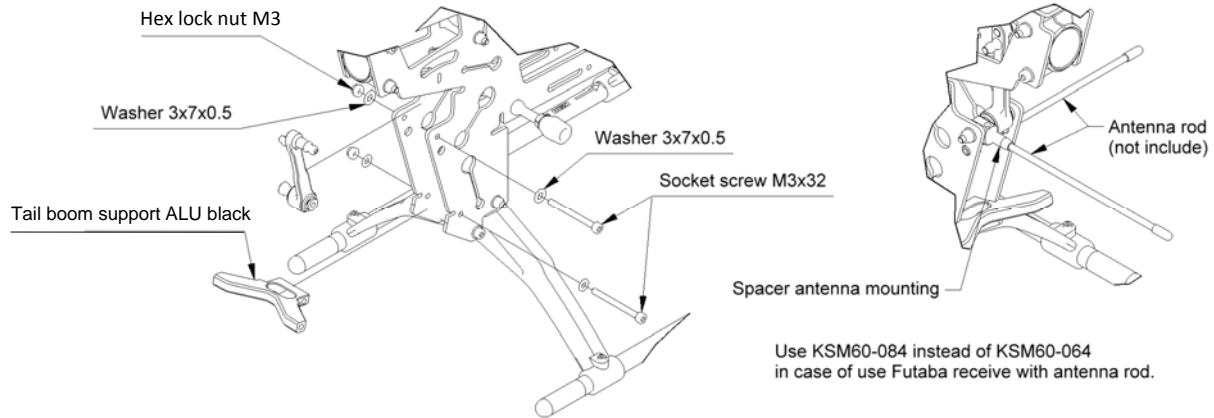

Parts List			
ITEM	PART NUMBER	DESCRIPTION	QTY
1	KSM60-027	Hex lock nut M3	2
2	KSM10-T01	Tail Boom Support ALU black	1
3	KSM60-031	Socket screw M3x32	2
4	KSM60-029	Washer 3x7x0.5	4
5	KSM60-084	Spacer antenna mounting	1

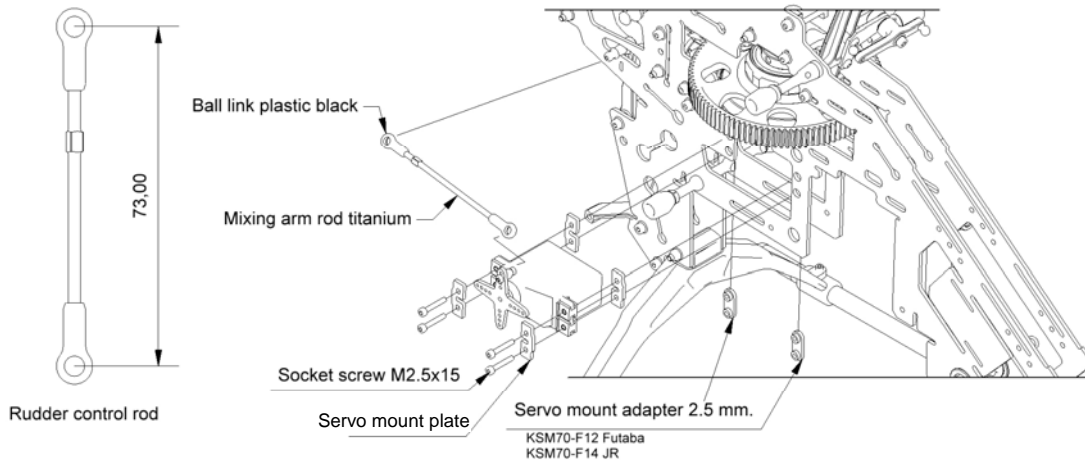
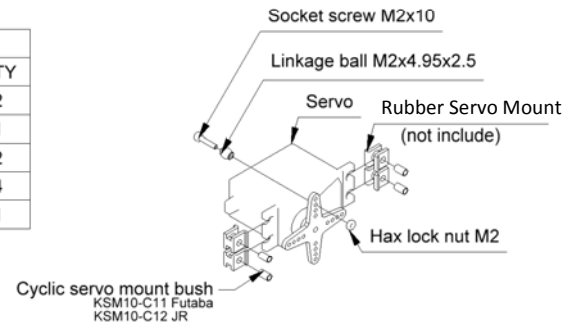

Parts List			
ITEM	PART NUMBER	DESCRIPTION	QTY
1	KSM70-F12	Servo mount adapter 2.5 mm. Futaba	2
2	KSM70-F14	Servo mount adapter 2.5 mm. JR	2
3	KSM10-C11	Cyclic servo mount bush Futaba ALU silver	4
4	KSM10-C12	Cyclic servo mount bush JR ALU silver	4
5	KSM40-C05	Servo mount plate	4
6	KSM60-026	Socket screw M2.5x15	4
7	KSM20-H01	Mixing arm rod titanium	1
8	KSM70-H03	Ball link plastic black	2
9	KSM60-041	Socket screw M2x10	1
10	KSM60-049	Hex lock nut M2	1
11	KSM53-112	Linkage ball M2x4.95x2.5	1

Note: Apply Blue thread lock to all screws, balls, and threads which it be fixed to metal-parts. For non-metal parts apply CA Glue.

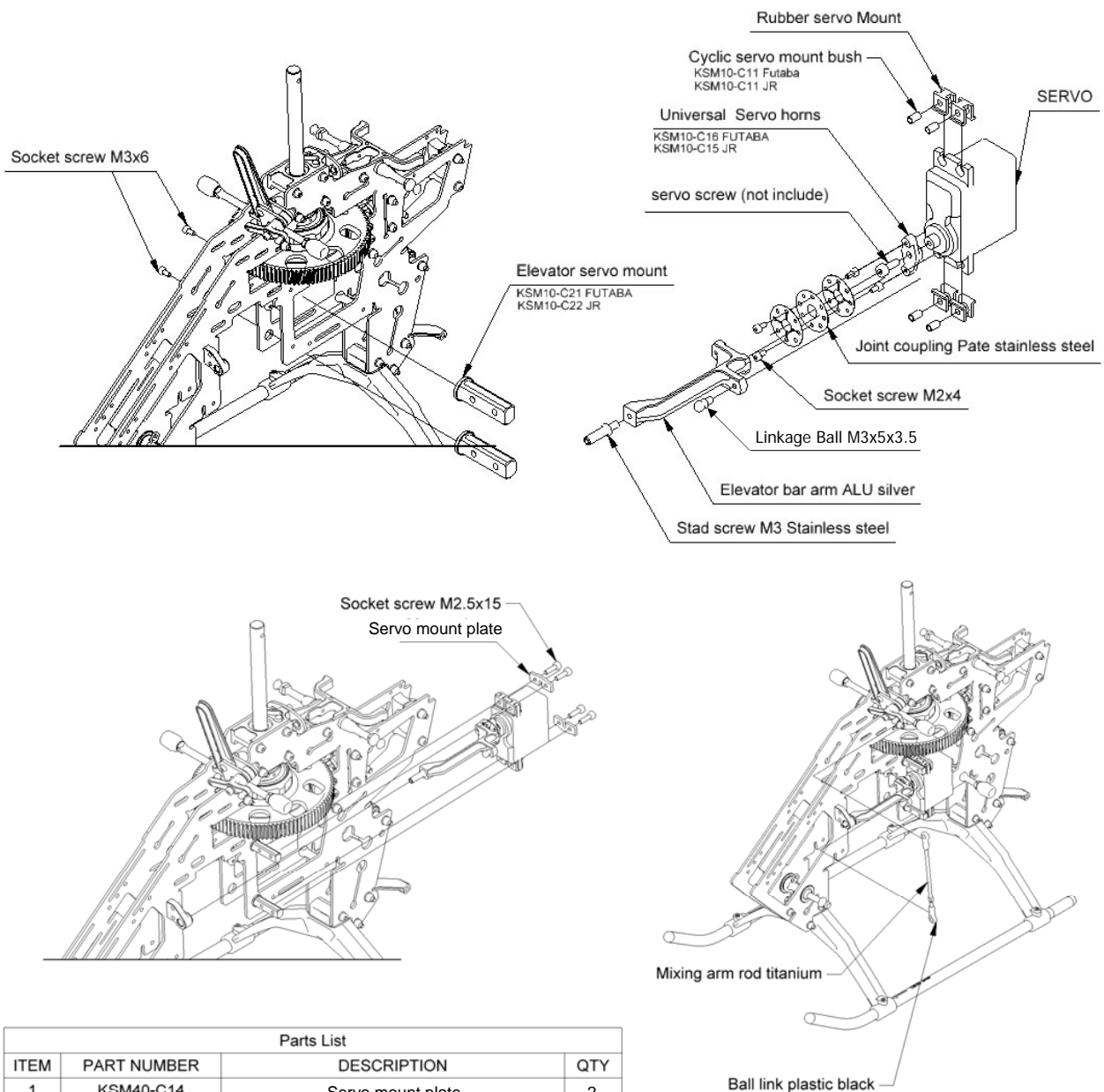

Parts List			
ITEM	PART NUMBER	DESCRIPTION	QTY
1	KSM40-C14	Servo mount plate	2
2	KSM20-C01	Joint coupling Plate stainless steel	3
3	KSM10-C15	Universal Servo horns JR	1
4	KSM10-C16	Universal Servo horns FUTABA	1
5	KSM60-050	Socket screw M2x4	4
6	KSM60-085	Stad screw M3 Stainless steel	1
7	KSM10-C11	Cyclic servo mount bush Futaba ALU silver	4
8	KSM10-C12	Cyclic servo mount bush JR ALU silver	4
9	KSM10-C20	Elevator bar arm ALU silver	1
10	KSM53-110	Linkage Ball M3x5x3.5	1
11	KSM60-026	Socket screw M2.5x15	4
12	KSM60-033	Socket screw M3x6	2
13	KSM10-C21	Elevator servo mount FUTABA	2
14	KSM10-C22	Elevator servo mount JR	2
15	KSM20-H01	Mixing arm rod titanium	1
16	KSM10-C07	Turnbuckle wrench	1
17	KSM70-H03	Ball link plastic black	2

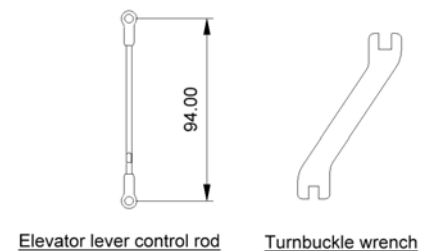

Note: Apply Blue thread lock to all screws, balls, and threads which it be fixed to metal-parts. For non-metal parts apply CA Glue.

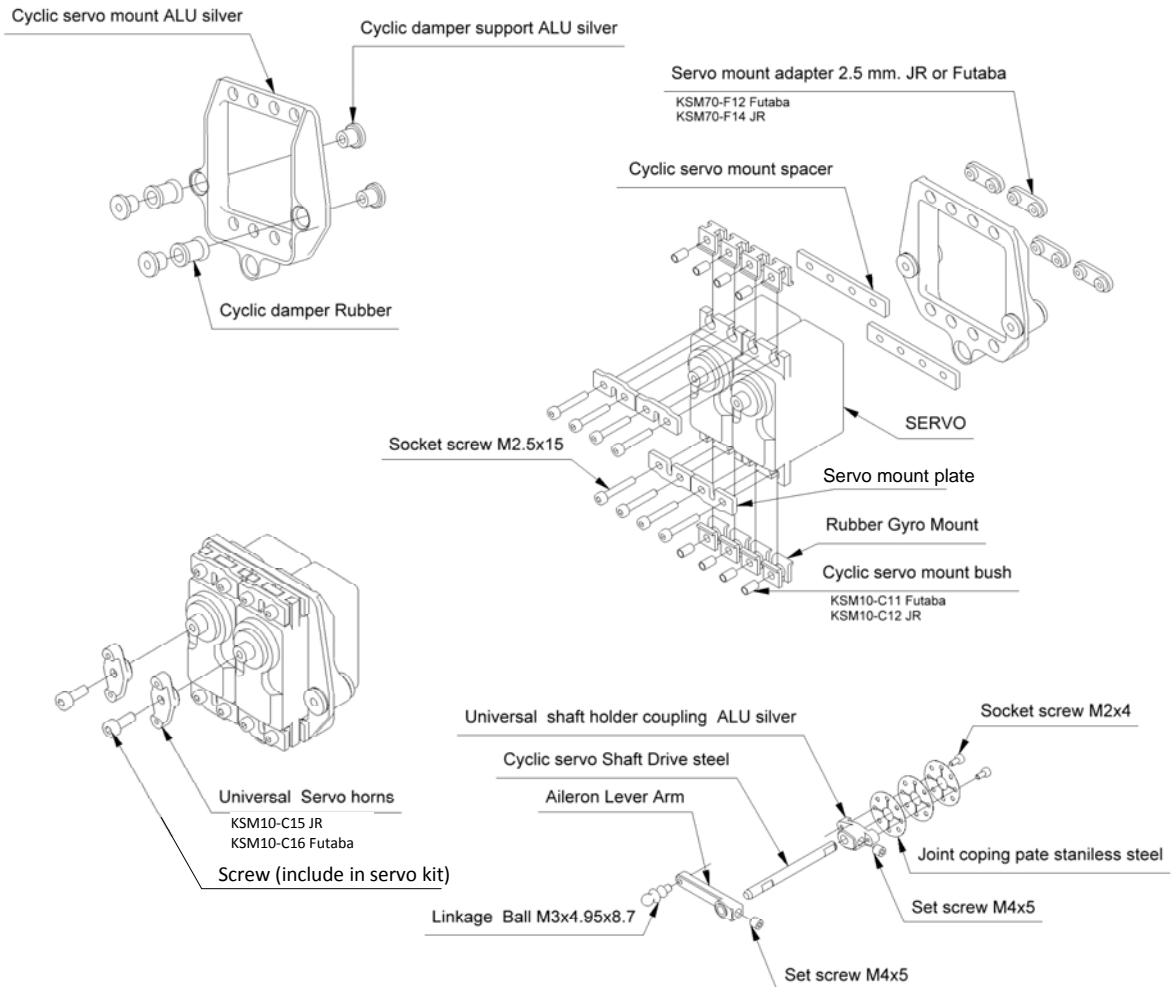

PARTS LIST			
ITE	PART NUMBER	DESCRIPTION	QTY
1	KSM70-C01	Cyclic damper rubber	2
2	KSM10-C11	Cyclic servo mount bush Futaba ALU silver	8
3	KSM10-C17	Cyclic damper support ALU silver	4
4	KSM60-026	Socket screw M2.5x15	8
5	KSM10-C15	Universal Servo horns JR ALU red	2
6	KSM10-C14	Universal shaft holder coupling ALU silver	2
7	KSM20-C01	Joint coping pate staniless steel	6
8	KSM60-050	Socket screw M2x4	8
9	KSM10-C16	Universal Servo horns Futaba ALU blue	2
10	KSM60-019	Set screw M4x5	4
11	KSM10-C13	Aileron Lever Arm	2
12	KSM53-111	Linkage Ball M3x4.95x8.7	2
13	KSM40-C01	Cyclic servo mount spacer	2
14	KSM20-C11	Cyclic servo Shaft Drive steel	2
15	KSM10-C08	Cyclic servo mount ALU silver	1
16	KSM10-C12	Cyclic servo mount bush JR ALU silver	8
17	KSM40-C05	Servo mount plate	4
18	KSM60-047	Socket screw M3x20	2
19	KSM70-F12	Servo mount adapter 2.5 mm. Futaba	4
20	KSM70-F14	Servo mount adapter 2.5 mm. JR	4

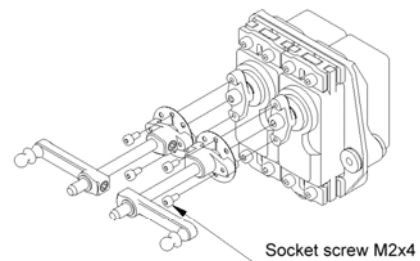

Note: Apply Blue thread lock to all screws, balls, and threads which it be fixed to metal-parts. For non-metal parts apply CA Glue.

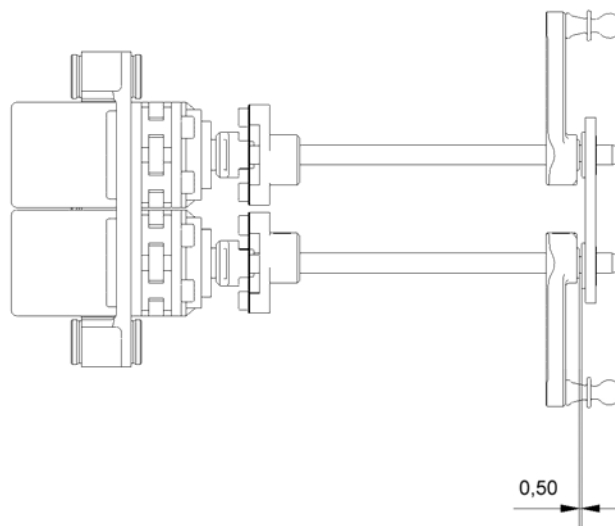
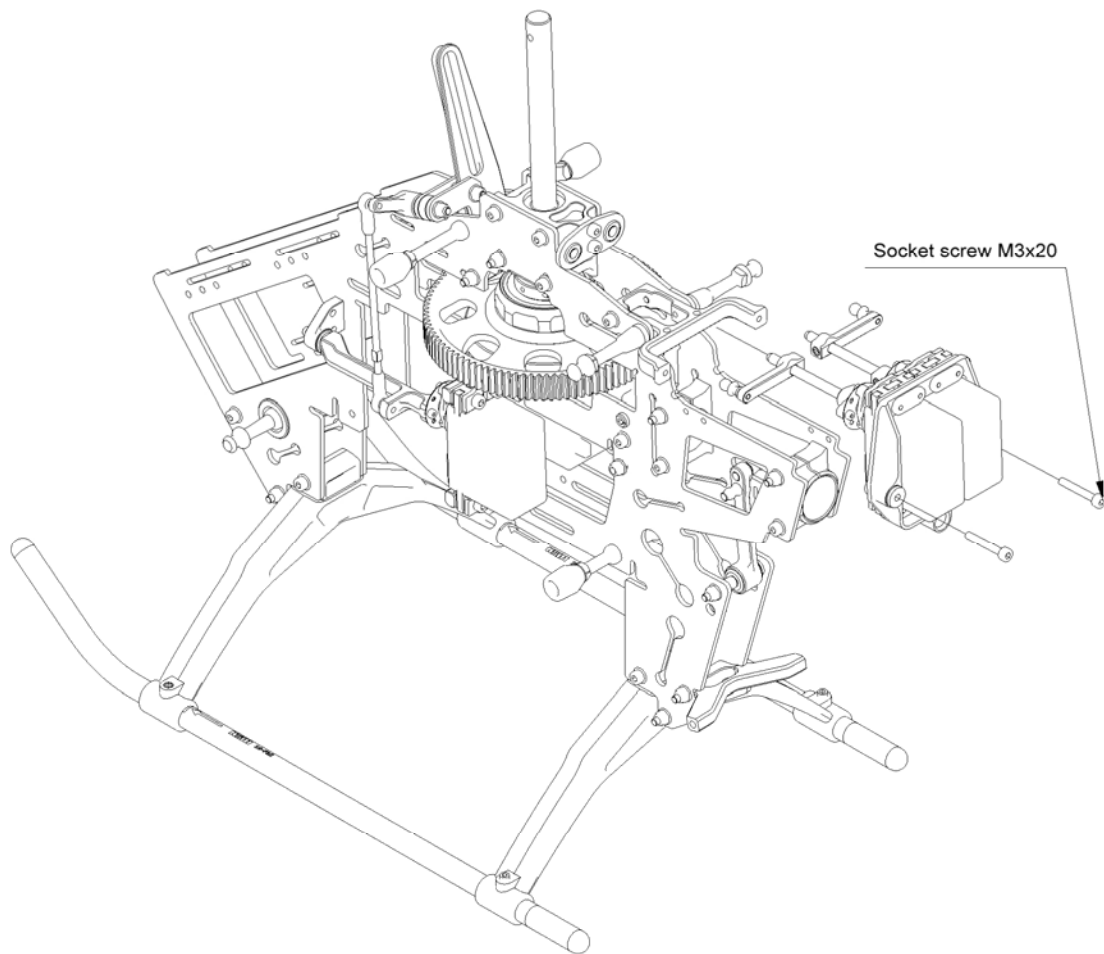

Allow 0.5mm space between Aileron
Lever Arm and bearing support.

Note: Apply Blue thread lock to all screws, balls, and threads which it be
fixed to metal-parts. For non-metal parts apply CA Glue.

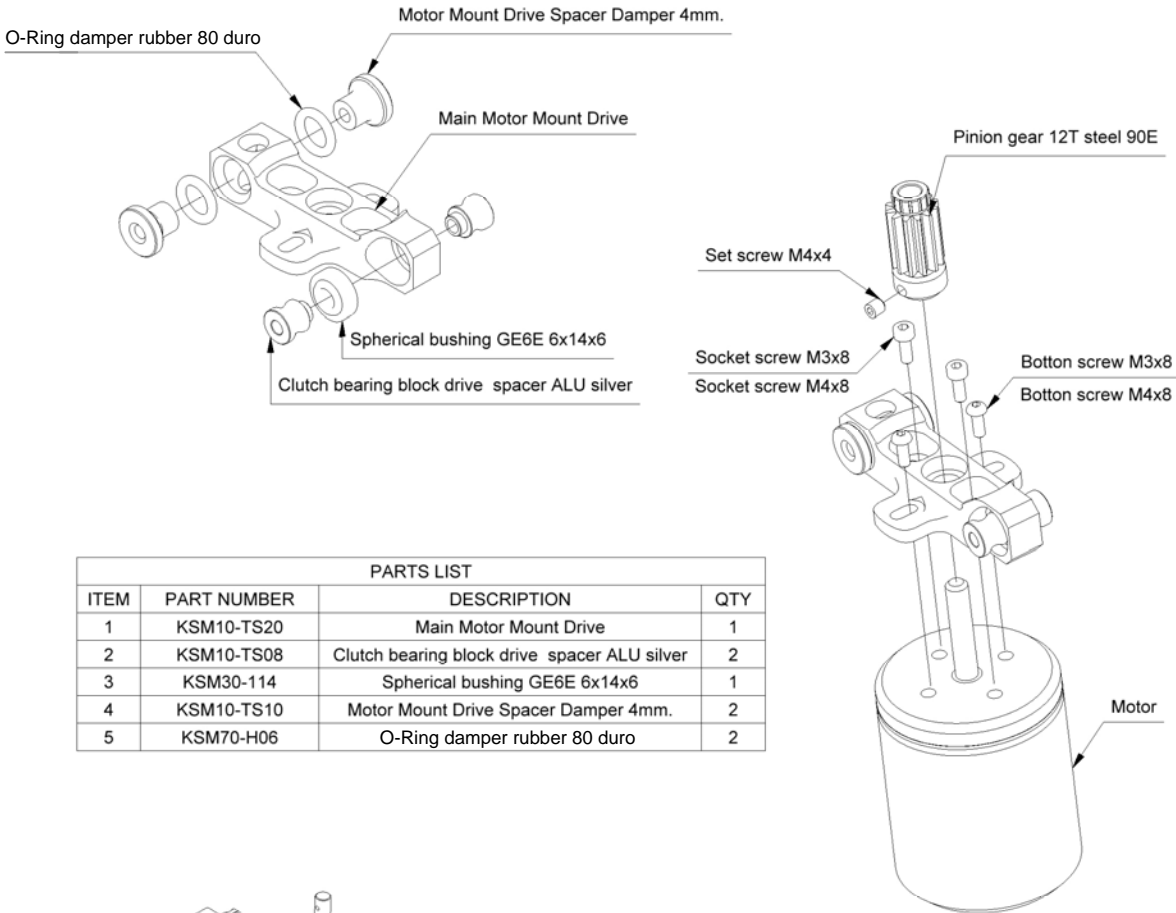

PARTS LIST			
ITEM	PART NUMBER	DESCRIPTION	QTY
1	KSM10-TS20	Main Motor Mount Drive	1
2	KSM10-TS08	Clutch bearing block drive spacer ALU silver	2
3	KSM30-114	Spherical bushing GE6E 6x14x6	1
4	KSM10-TS10	Motor Mount Drive Spacer Damper 4mm.	2
5	KSM70-H06	O-Ring damper rubber 80 duro	2

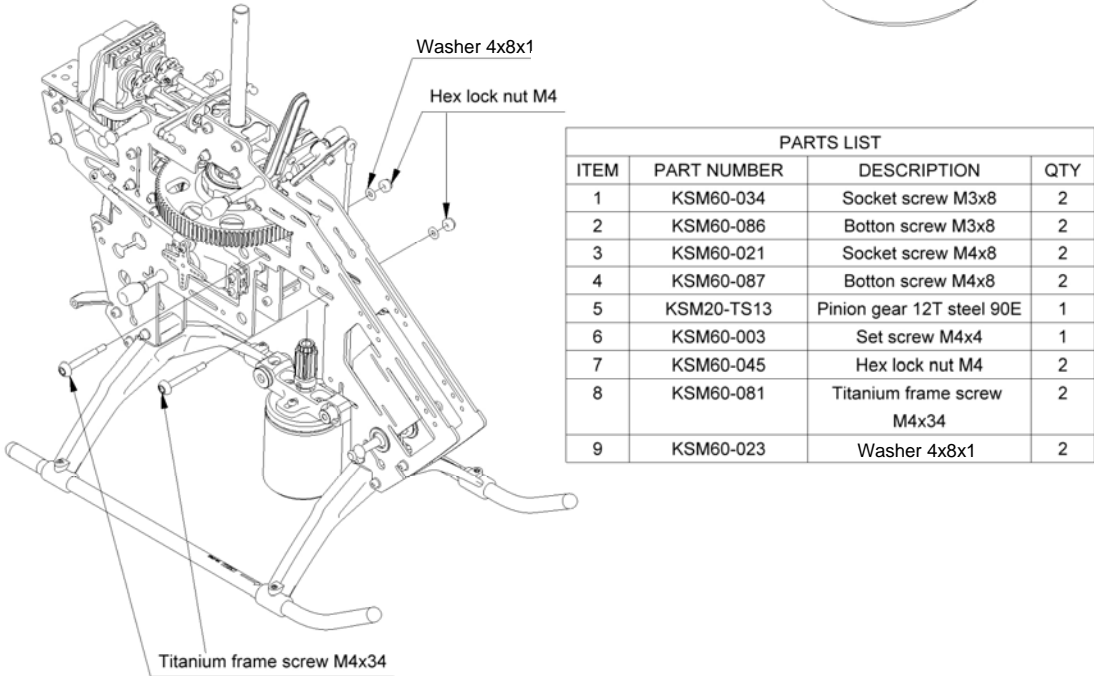

PARTS LIST			
ITEM	PART NUMBER	DESCRIPTION	QTY
1	KSM60-034	Socket screw M3x8	2
2	KSM60-086	Bottom screw M3x8	2
3	KSM60-021	Socket screw M4x8	2
4	KSM60-087	Bottom screw M4x8	2
5	KSM20-TS13	Pinion gear 12T steel 90E	1
6	KSM60-003	Set screw M4x4	1
7	KSM60-045	Hex lock nut M4	2
8	KSM60-081	Titanium frame screw M4x34	2
9	KSM60-023	Washer 4x8x1	2

Note: Apply Blue thread lock to all screws, balls, and threads which it be fixed to metal-parts. For non-metal parts apply CA Glue.

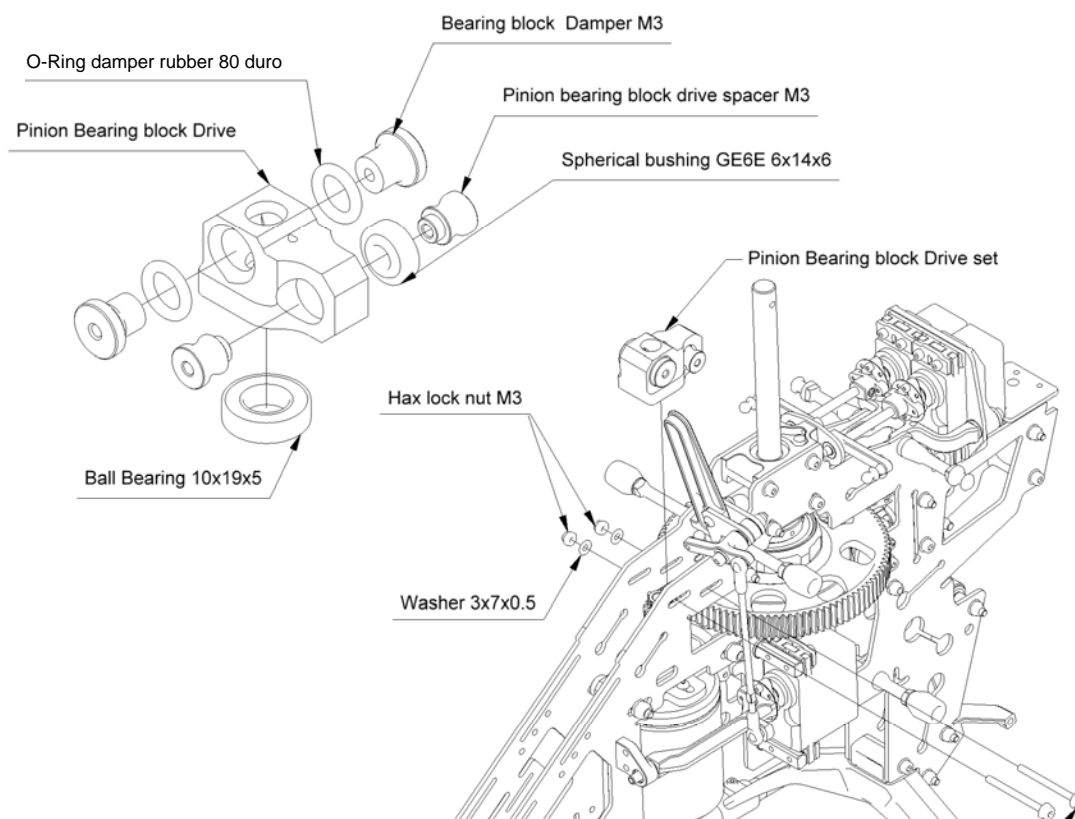

PARTS LIST			
ITEM	PART NUMBER	DESCRIPTION	QTY
1	KSM10-TS05	Pinion Bearing block Drive	1
2	KSM70-H06	O-Ring damper rubber 80 duro	2
3	KSM10-TS09	Bearing block Damper M3	2
4	KSM30-114	Spherical bushing GE6E 6x14x6	1
5	KSM10-TS04	Pinion bearing block drive spacer M3	2
6	KSM30-110	Ball Bearing 10x19x5	1
7	KSM60-029	Washer 3x7x0.5	2
8	KSM60-027	Hax lock nut M3	2
9	KSM60-078	Titanium frame screw M3x32	2

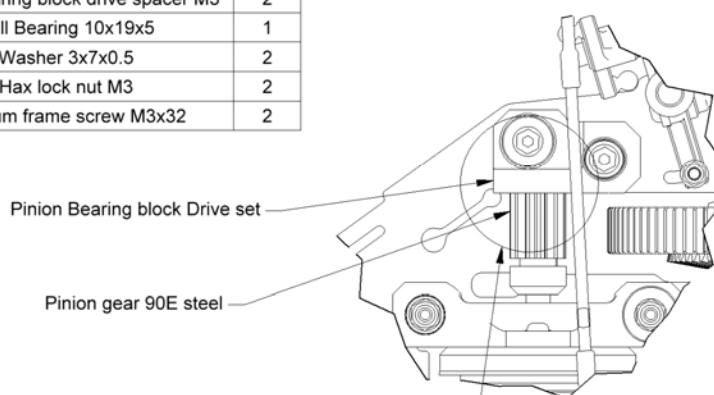

NOTE Don't lock pinion gear till the motor and pinion gearing block are installed in the frame. Then slide pinion to abut the bearing block and then tighten set screw M4x5 to lock pinion

Note: Apply Blue thread lock to all screws, balls, and threads which it be fixed to metal-parts. For non-metal parts apply CA Glue.

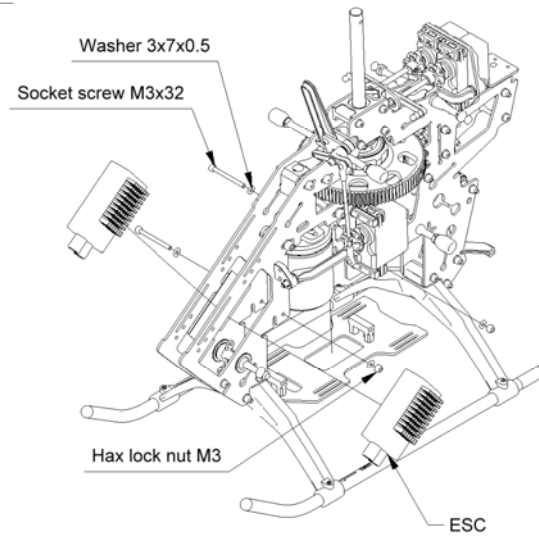
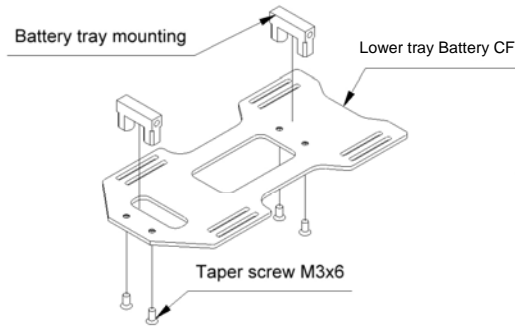

PARTS LIST			
ITEM	PART NUMBER	DESCRIPTION	QTY
1	KSM40-F12	Lower tray Battery CF	1
2	KSM60-024	Taper screw M3x6	4
3	KSM10-F04	Battery tray mounting	2
4	KSM60-031	Socket screw M3x32	2
5	KSM60-027	Hax lock nut M3	2
6	KSM60-029	Washer 3x7x0.5	4

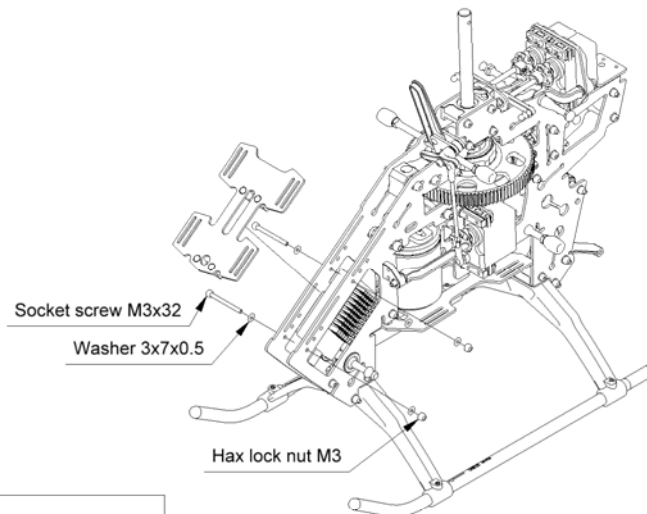
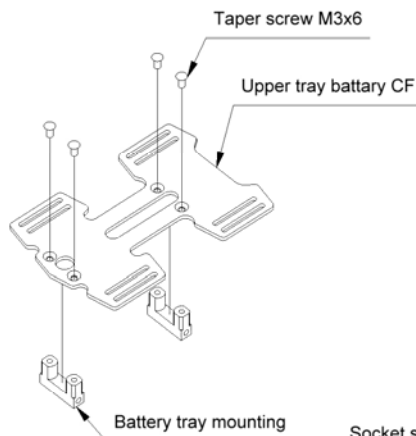

PARTS LIST			
ITEM	PART NUMBER	DESCRIPTION	QTY
1	KSM40-F11	Upper tray Battery CF	1
2	KSM60-024	Taper screw M3x6	4
3	KSM10-F04	Battery tray mounting	2
4	KSM60-031	Socket screw M3x32	2
5	KSM60-027	Hax lock nut M3	2
6	KSM60-029	Washer 3x7x0.5	4

Note: Apply Blue thread lock to all screws, balls, and threads which it be fixed to metal-parts. For non-metal parts apply CA Glue.

Parts List			
ITEM	PART NUMBER	DESCRIPTION	QTY
1	KSM10-C01	Swash plate	1
2	KSM20-C08	Swash plate control rod titanium	3
3	KSM70-H03	Ball link plastic	6

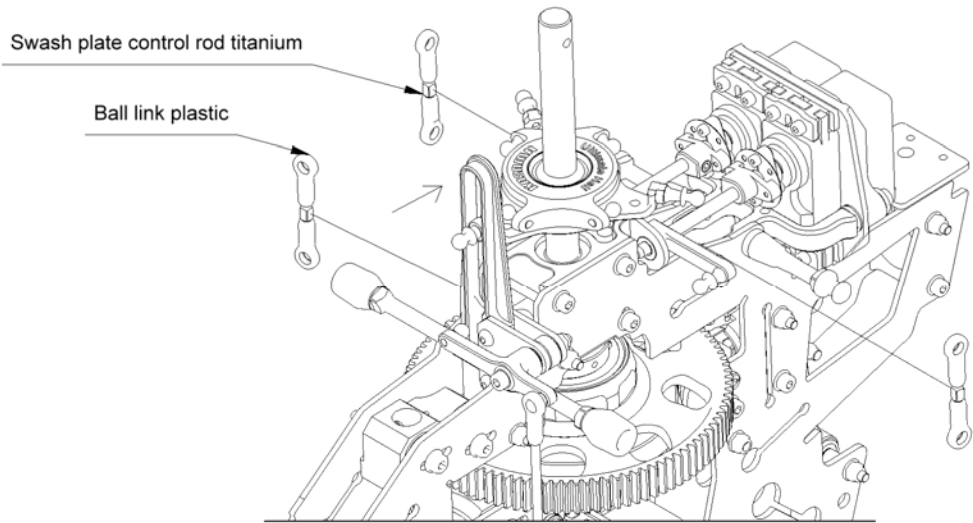
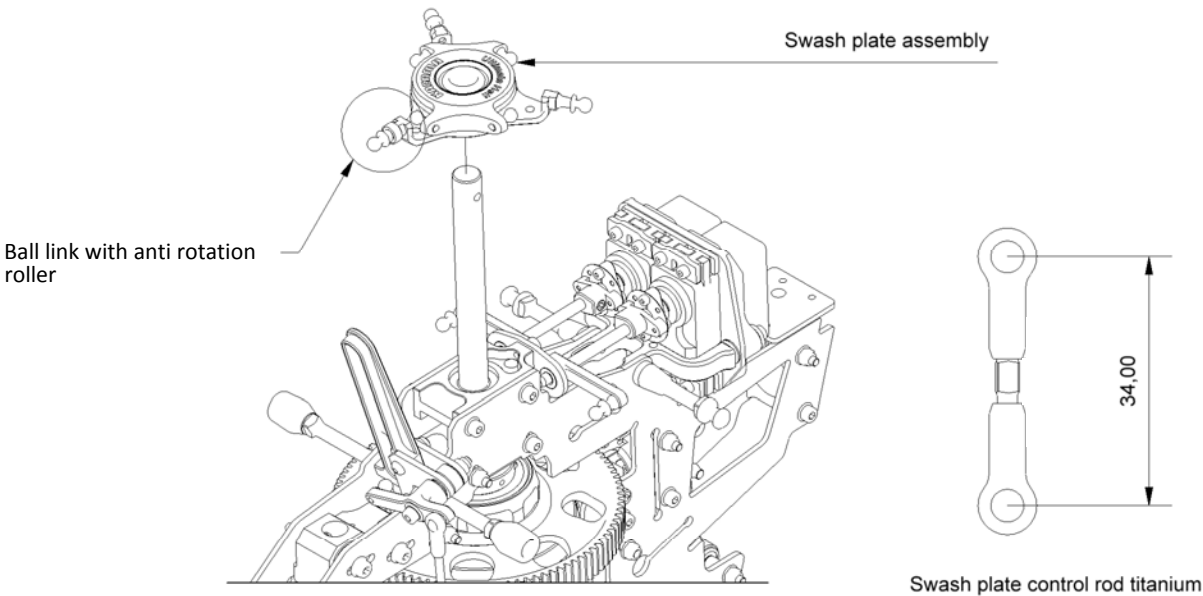

Note: Apply Blue thread lock to all screws, balls, and threads which it be fixed to metal-parts. For non-metal parts apply CA Glue.

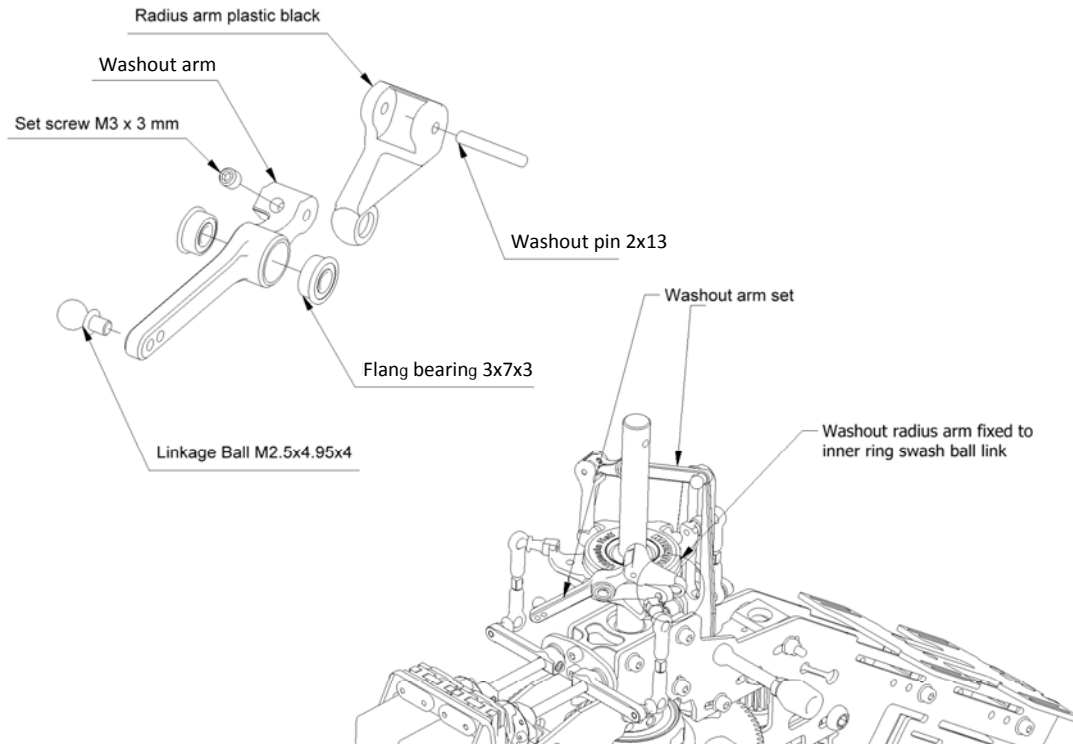

PARTS LIST			
ITEM	PART NUMBER	DESCRIPTION	QTY
1	KSM10-H08	Washout arm	2
2	KSM70-H01	Radius arm plastic black	2
3	KSM30-104	Flang bearing 3x7x3	4
4	KSM20-H05	Washout pin 2x13	2
5	KSM60-001	Set screw M3 x 3 mm	2
7	KSM10-H11	Washout Base	1
8	KSM60-004	Button screw M3x15	2

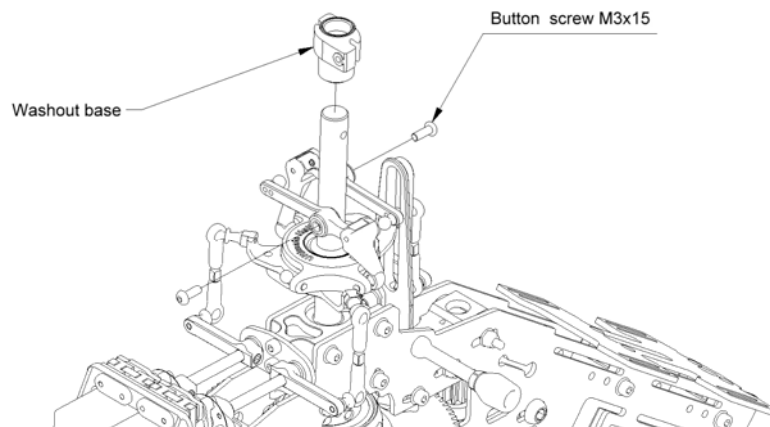

Note: Apply Blue thread lock to all screws, balls, and threads which it be fixed to metal-parts. For non-metal parts apply CA Glue.

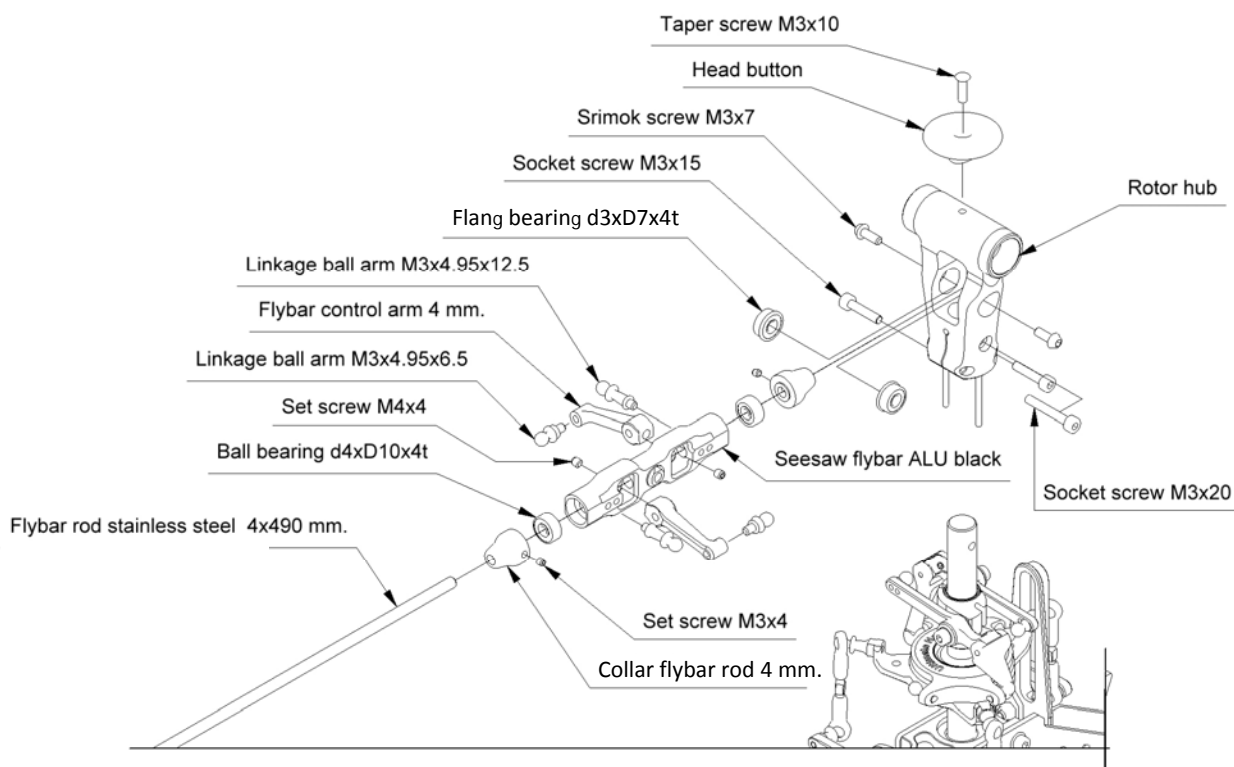

Parts List			
ITEM	PART NUMBER	DESCRIPTION	QTY
1	KSM10-90H01	Rotor Hub	1
2	KSM10-H01	Head button	1
3	KSM10-H07	Seesaw flybar ALU black	1
4	KSM10-90H07	Flybar control arm 4 mm.	2
5	KSM10-90H06	Collar flybar rod 4 mm.	2
6	KSM20-90H04	Flybar rod stainless steel 4x490 mm.	1
7	KSM60-010	Taper screw M3x10	1
8	KSM60-009	Srimok screw M3x7	2
9	KSM60-008	Socket screw M3x15	2
10	KSM60-007	Socket screw M3x20	1
11	KSM60-002	Set screw M3x4	2
12	KSM60-003	Set screw M4x4	2
13	KSM30-103	Flang bearing d3xD10x4t	2
14	KSM30-105	Ball bearing d4xD10x4t	2
15	KSM53-107	Linkage ball arm M3x4.95x12.5	2
16	KSM53-106	Linkage ball arm M3x4.95x6.5	2

CAUTION :

1. Socket Screw M3x15 in Item 9 pinch collar should be gently and evenly tightened.
2. Should use 490-520 mm flybar wire.

Note: Apply Blue thread lock to all screws, balls, and threads which it be fixed to metal-parts. For non-metal parts apply CA Glue.

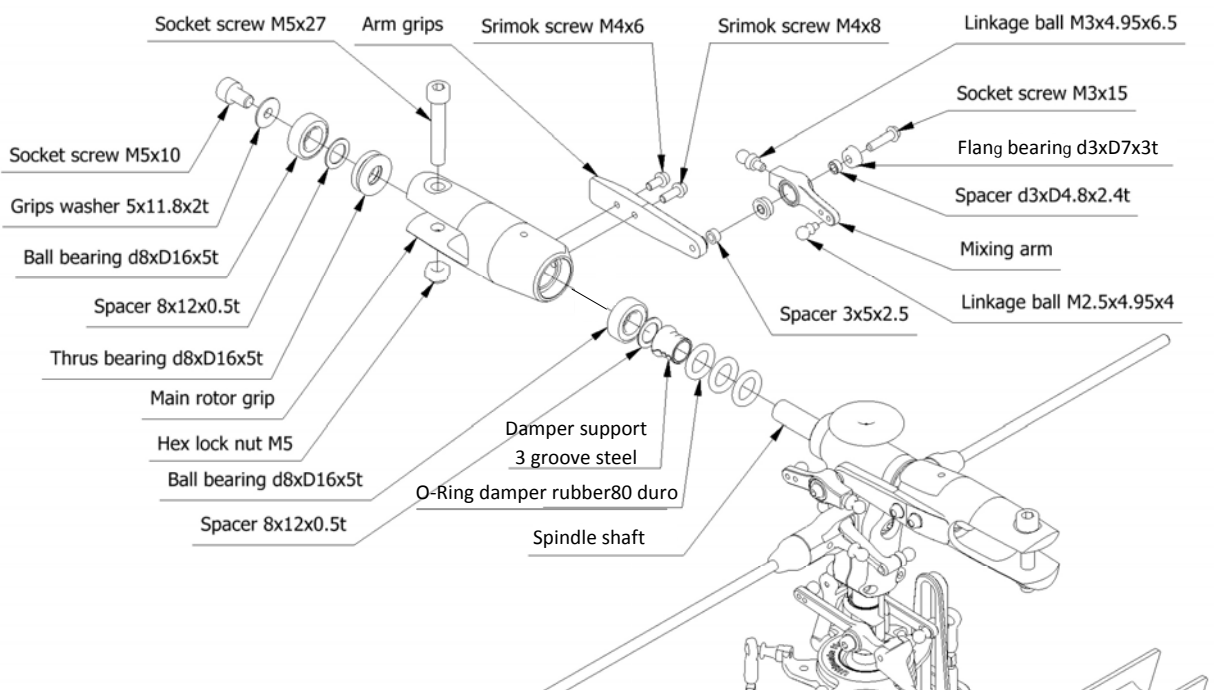

PARTS LIST			
ITEM	PART NUMBER	DESCRIPTION	QTY
1	KSM10-90H08	Main rotor grip	2
2	KSM10-90H09	Arm grip	2
3	KSM10-H04	Mixing arm	2
4	KSM20-90H02	Damper support 3 groove steel	2
5	KSM70-H06	O-Ring damper rubber 80 duro	6
6	KSM53-106	Linkage ball M3x4.95x6.5	2
7	KSM53-101	Linkage ball M2.5x4.95x4	2
8	KSM60-036	Srimok screw M4x6	2
9	KSM60-042	Srimok screw M4x8	2
10	KSM60-008	Socket screw M3x15	2
11	KSM60-017	Socket screw M5x27	2
12	KSM60-016	Socket screw M5x10	2
13	KSM60-018	Hex lock nut M5	2
14	KSM30-101	Ball bearing d8xD16x5t	4
15	KSM30-102	Thrust bearing d8xD16x5t	2
16	KSM30-104	Flang bearing d3xD7x3t	4
17	KSM20-H04	Grips washer 5x11.8x2t	2
18	KSM60-063	Spacer 8x12x0.5t	6
19	KSM60-058	Spacer 3x5x2.5	2
20	KSM60-012	Spacer d3xD4.8x2.4t	2
21	KSM20-90H01	Spindle shaft	1

CAUTION :

1. Secure O-ring (KSM70-H06) onto Damper Support (KSM20-90H02) before inserting into Center Hub.
2. Lubricate by silicone grease at DAMPER before assembly.
3. For Arm Grip Assembly, Should be tighten the long one of SRIMOK SCREW (KSM60-015) first.
4. Should check DAMPER every 30-40 flight and lubricate by grease.

Note: Apply Blue thread lock to all screws, balls, and threads which it be fixed to metal-parts. For non-metal parts apply CA Glue.

Parts List			
ITEM	PART NUMBER	DESCRIPTION	QTY
1	KSM70-H03	Ball link plastic	8
2	KSM20-H01	Mixing arm rod	2
3	KSM20-H02	Stabilizer control rod	2
4	KSM70-H02	Pitch rod	2

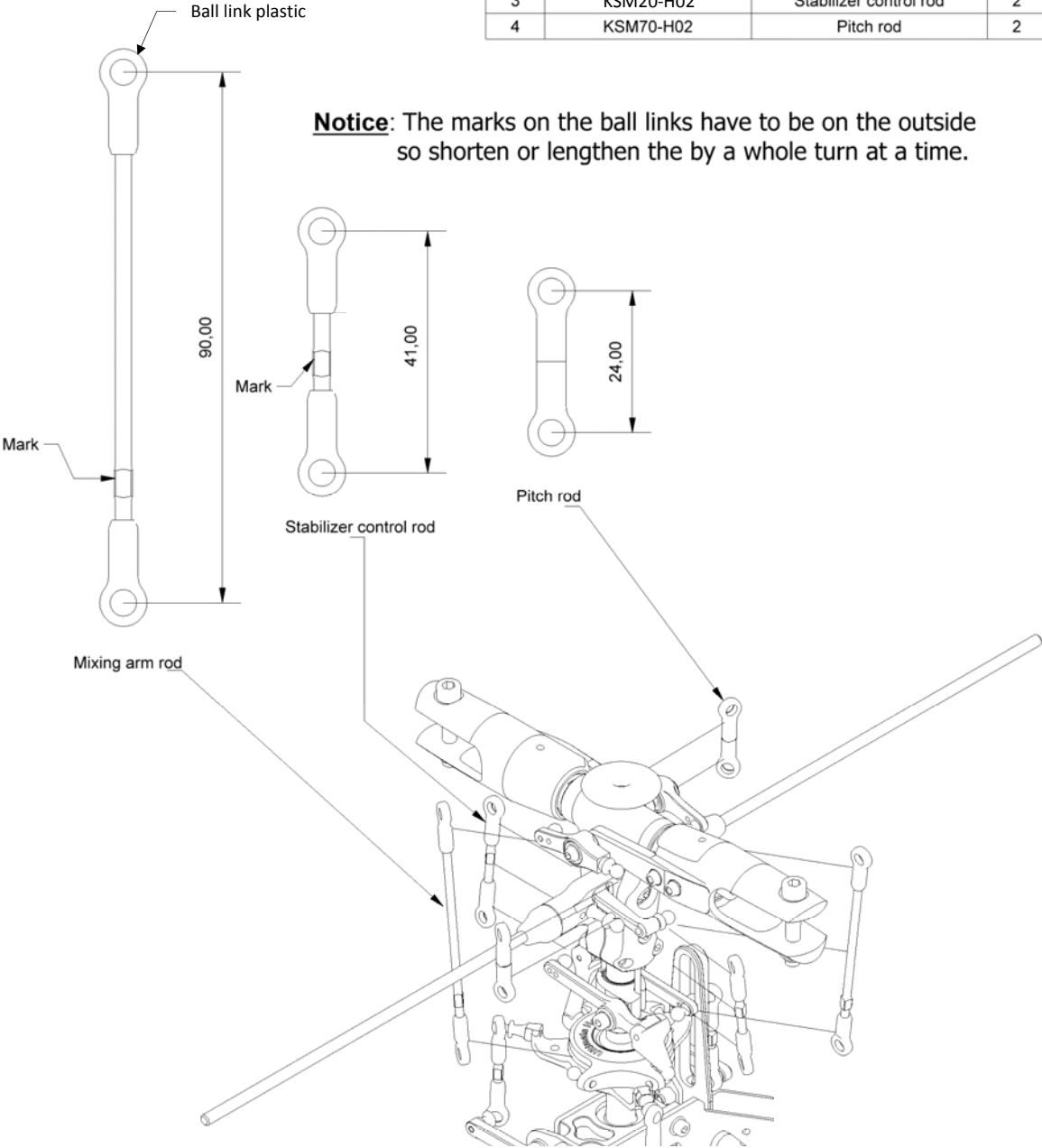

Note: Apply Blue thread lock to all screws, balls, and threads which it be fixed to metal-parts. For non-metal parts apply CA Glue.

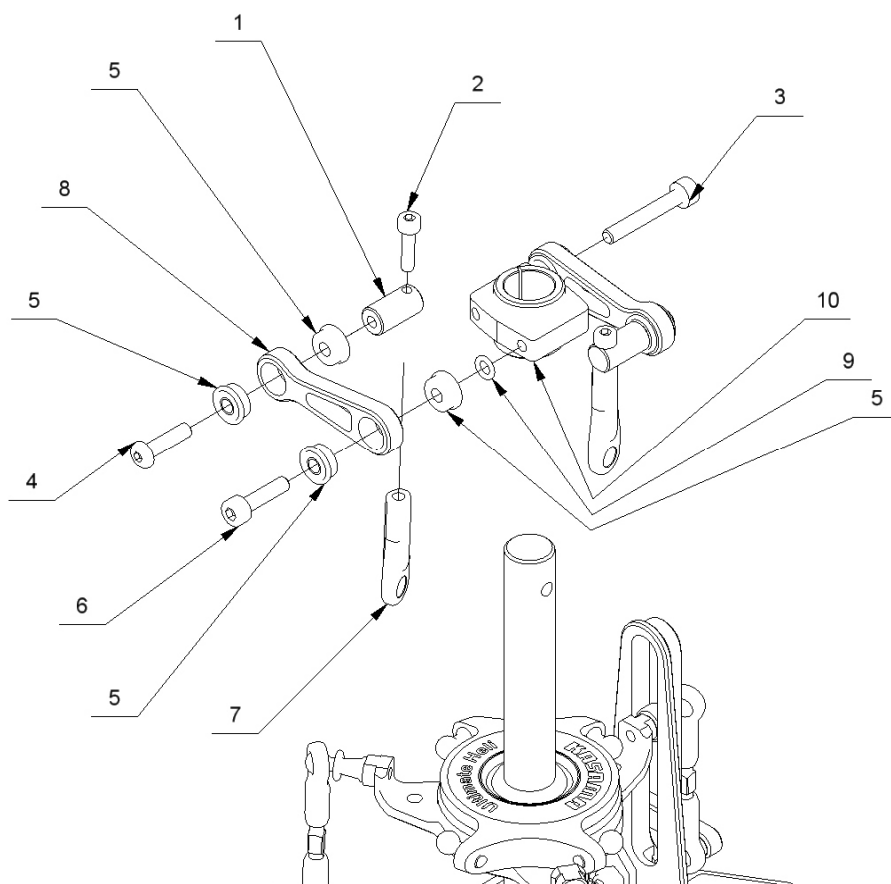

PARTS LIST			
ITEM	PART NUMBER	DESCRIPTION	QTY
1	KSM20-H08	Swash Plate Drive Pose	2
2	KSM60-054	Socket Screw M3x10	2
3	KSM60-074	Socket Screw M3x24	1
4	KSM60-076	Button Screw M3x10	2
5	KSM30-104	Flang Bearing d3xD7x3t	8
6	KSM60-020	Socket Screw M3x12	1
7	KSM70-H03	Ball Link plastic	2
8	KSM10-90H05	Swash Plate Drive Arm	2
9	KSM60-030	Washer d3xD5x0.5t	2
10	KSM10-H05	Swash Plate Drive	1

Note: Apply Blue thread lock to all screws, balls, and threads which it be fixed to metal-parts. For non-metal parts apply CA Glue.

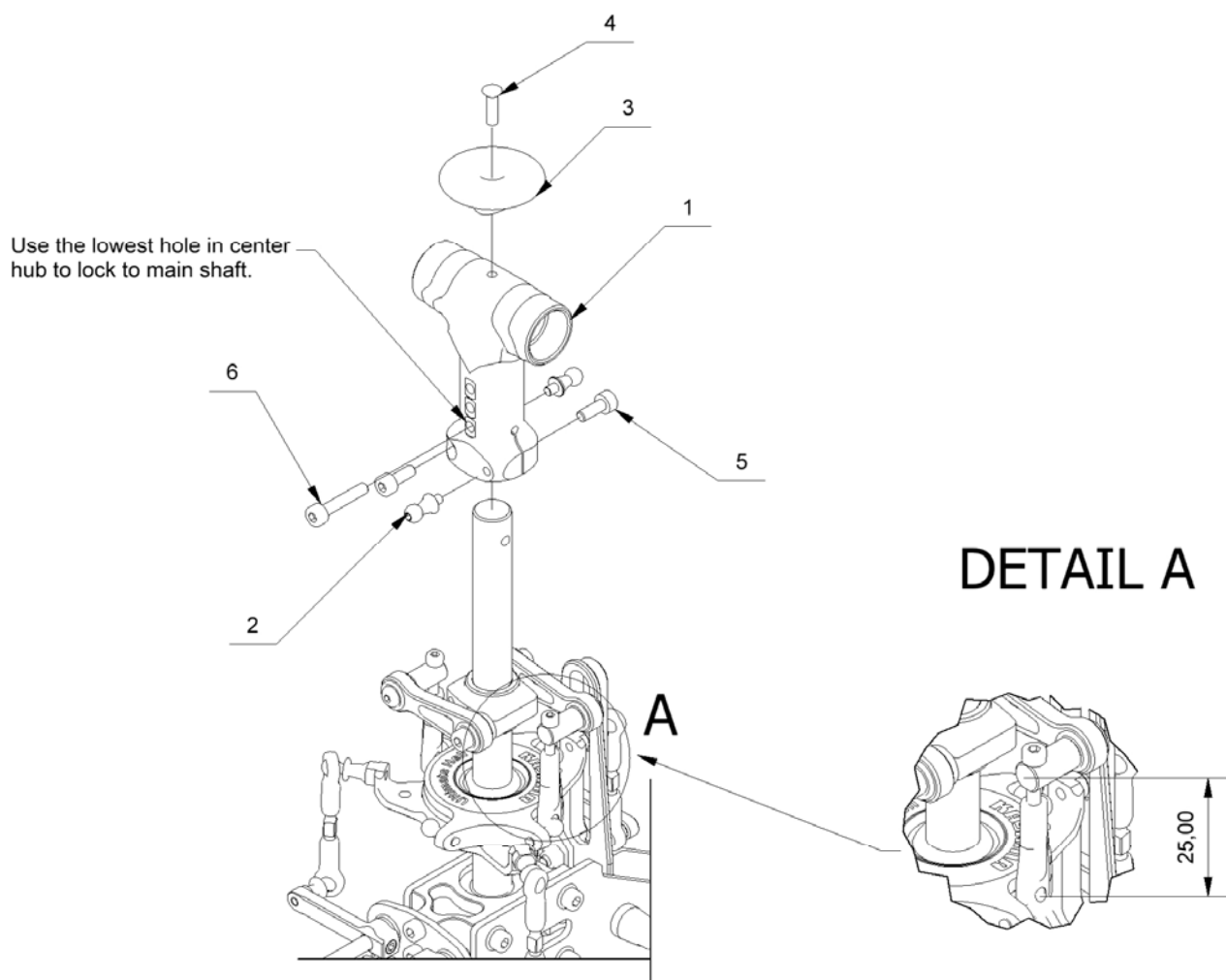

PARTS LIST			
ITEM	PART NUMBER	DESCRIPTION	QTY
1	KSM10-90H04	10 mm. Cyber center hub	1
2	KSM53-103	Linkage ball M3x4.95x5	2
3	KSM10-H01	Head button	1
4	KSM60-010	Taper screw M3x10	1
5	KSM60-054	Socket screw M3x10	2
6	KSM60-075	Socket screw M3x16	1

Note: Apply Blue thread lock to all screws, balls, and threads which it be fixed to metal-parts. For non-metal parts apply CA Glue.

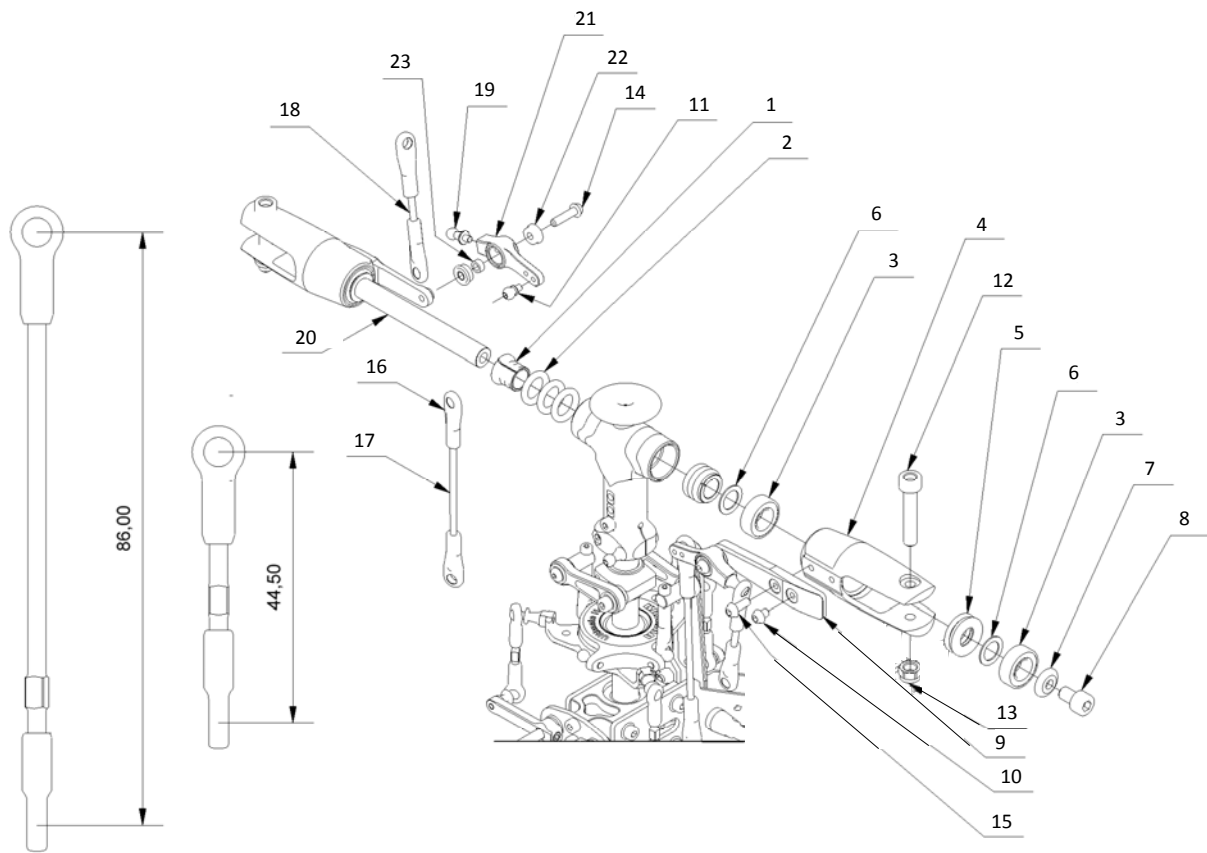

PARTS LIST			
ITEM	PART NUMBER	DESCRIPTION	QTY
1	KSM20-90H02	Damper Support 3 groove	2
2	KSM70-H06	O-Ring Damper rubber 80 duro	6
3	KSM30-101	Ball Bearing d8xD16x5t	4
4	KSM10-90H08	Main Rotor Grip Holder 90	2
5	KSM30-102	Thrust Bearing d8xD16x5t	2
6	KSM60-063	Spacer 8x12x0.5t	4
7	KSM20-H04	Grips Washer 5x11.8x2t	2
8	KSM60-016	Socket Screw M5x10	2
9	KSM10-90H09	Arm Grips 90	2
10	KSM60-36	Srimok screw M4x6	2
11	KSM 53-101	Linkage Ball M2.5x4.95x4	2
12	KSM60-017	Socket Screw M5x27	2
13	KSM60-018	Hex Lock Nut M5	2
14	KSM60-008	Socket Screw M3x15	2
15	KSM60-042	Srimok screw M4x8	2
16	KSM70-H03	Ball link plastic	8
17	KSM20-H07	Mixing arm rod 75 mm.	2
18	KSM20-H02	Stabilizer control rod	2
19	KSM53-106	Linkage Ball M3x4.95x6.5	2
20	KSM20-90H01	Spindle Shaft	2
21	KSM10-H04	Mixing Arm	2
22	KSM30-104	Flang Bearing d3xD7x3t	4
23	KSM60-012	Spacer d3xD4.8x2.4t	2

Note: Apply Blue thread lock to all screws, balls, and threads which it be fixed to metal-parts. For non-metal parts apply CA Glue.

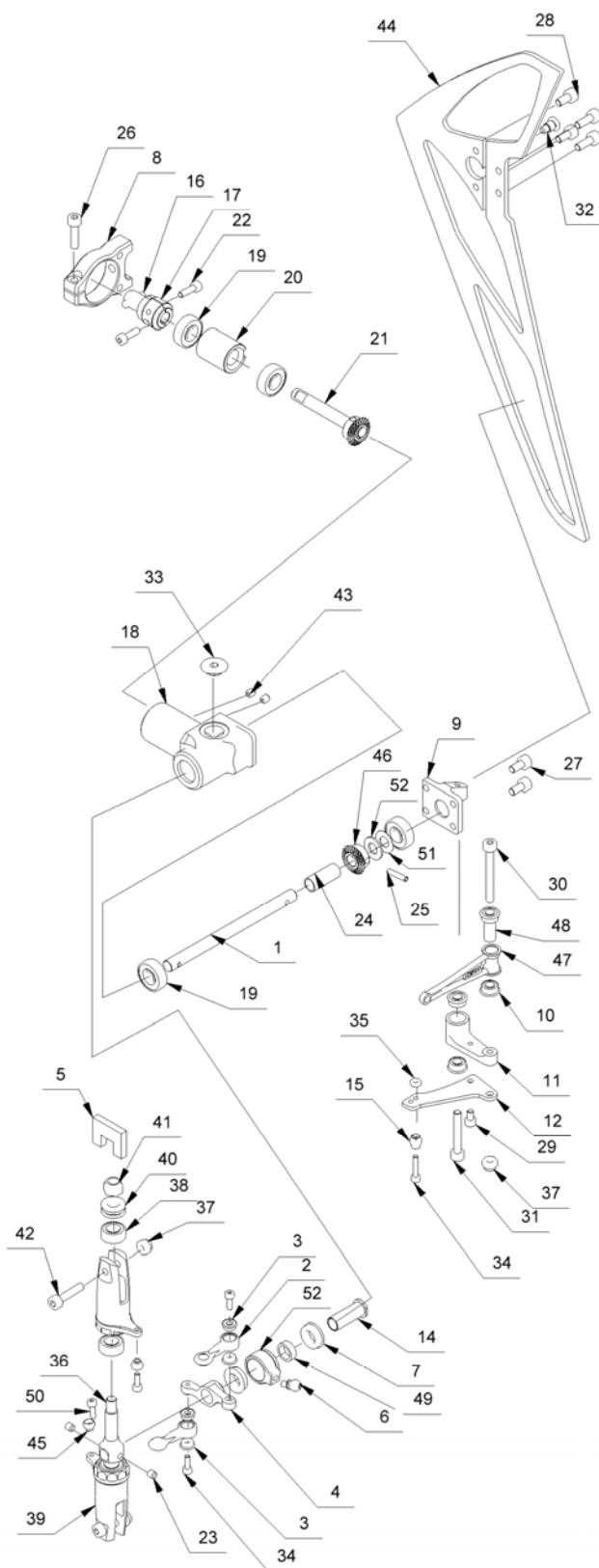

Parts List			
ITEM	PART NUMBER	DESCRIPTION	QTY
1	KSM20-T02	Tail rotor shaft steel	1
2	KSM70-T06	Tail Pitch Link	2
3	KSM30-106	Flang Bearing 2x5x2.5t	4
4	KSM10-T24	Tail slider pitch	1
5	KSM10-T04	Tail grip wrench	1
6	KSM53-102	Linkage ball M3x4.75x3.2	1
7	KSM30-122	Frang Bearing d6xD10x3t	2
8	KSM10-T10	Tail Gear Box Holder	1
9	KSM10-T16	Tail Gear case cap	1
10	KSM30-104	Frang Bearing d3xD7x3t	4
11	KSM10-T17	Tail rotor control arm	1
12	KSM40-T09	Tail control arm CF	1
13	KSM20-T25	Tail gear spacer	1
14	KSM20-T10	Tail Pitch Control Slide Bushing	1
15	KSM53-112	Linkage Ball M2x4.95x2.5	1
16	KSM20-T04	Tail input Shaft Cola Pin	1
17	KSM10-TS18	Tail drive joint rear 5 mm.	1
18	KSM10-T13	Tail Gear Box case	1
19	KSM30-116	Ball bearing d5xD13x4t	4
20	KSM10-T03	Tail Gear Box	1
21	KSM20-T21	Tail Input Shaft and gear set CNC	1
22	KSM56-056	Socket screw M2.5x8	2
23	KSM60-002	set screw M3x4	2
24	KSM20-T24	Tail gear bush bronz	1
25	KSM20-T03	Spring pin	2
26	KSM60-020	Socket screw M3x12	1
27	KSM60-033	Socket screw M3x6	2
28	KSM60-034	Socket screw M3x8	4
29	KSM60-048	Socket screw M2.5x6	1
30	KSM60-028	Socket screw M3x28	1
31	KSM60-047	Socket screw M3x20	1
32	KSM60-043	Stap screw Tail gearbox lock M4	1
33	KSM10-T18	Service Cap Tail Gear Box	1
34	KSM60-041	Socket screw M2x10	3
35	KSM60-049	M2 nut	1
36	KSM20-T01	Tail Center Hub	1
37	KSM60-027	Hex lock nut M3	3
38	KSM30-123	Ball bearing 5x10x4	4
39	KSM10-T25	Tail grip blade	2
40	KSM30-124	Thrust bearing 5x10x4	2
41	KSM60-045	Hex lock nut M4	2
42	KSM60-008	Socket screw M3x15	2
43	KSM60-001	Set screw M3x3	2
44	KSM40-T08	Vertical Fin	1
45	KSM53-113	Linkage Ball 4.95x3.7	2
46	KSM20-T20	Tail bevel gear (L) steel CNC	1
47	KSM70-T05	Tail control arm holder	1
48	KSM60-067	Spacer 3x4.7x9.8	1
49	KSM60-068	Spacer 6x8x2.7	1
50	KSM60-046	Socket screw M2x6	2
51	KSM20-T26	Shim (0.1-0.3)	1
52	KSM10-T23	Bearing ring control pitch	1

Note: Apply Blue thread lock to all screws, balls, and threads which it be fixed to metal-parts. For non-metal parts apply CA Glue.

Parts List			
ITEM	PART NUMBER	DESCRIPTION	QTY
1	KSM40-T02	Tail boom CF	1

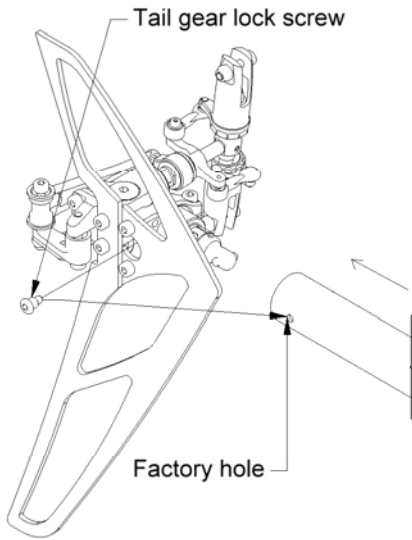

1) Assemble tail gear case to boom using Tail Gear lock screw.

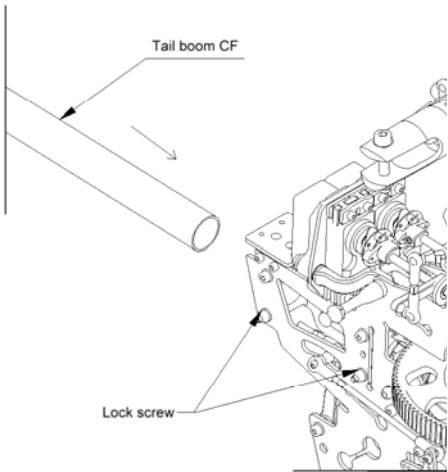

2) Put tail boom in frame boom case and lightly tighten bolts.

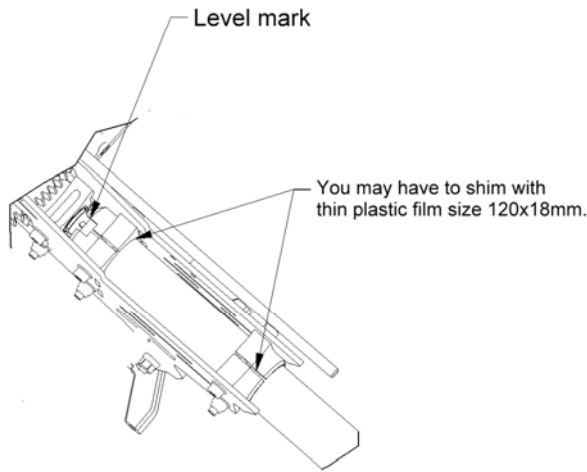

3) Insert tail boom into frame case until it fills the boom mount cutout and is flush with the end of the boom mount.

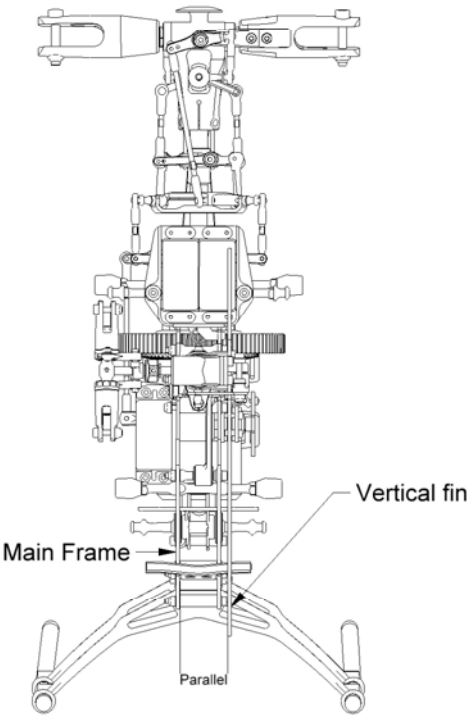

4) Rotate fin until it is vertical in line with main shaft then tighten tail case bolts.

Note: Apply Blue thread lock to all screws, balls, and threads which it be fixed to metal-parts. For non-metal parts apply CA Glue.

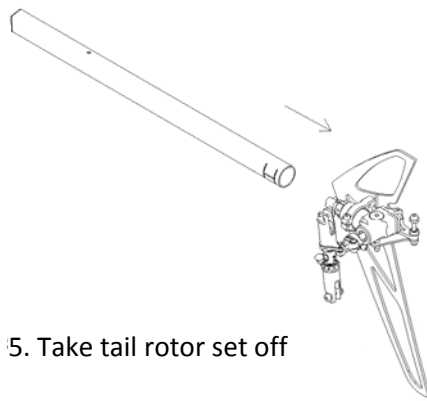

5. Take tail rotor set off

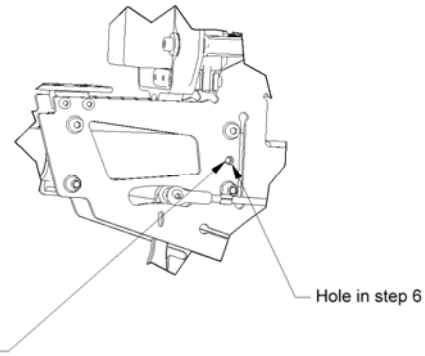

6. Drill a 2.5mm hole in tail boom through frame and boom mount being careful not to damage the thread in the alloy mount.

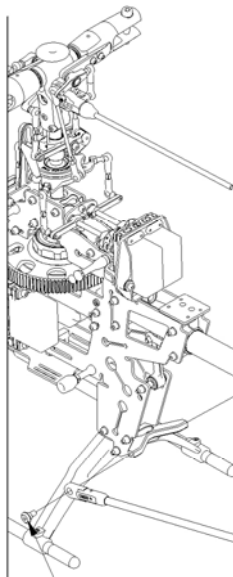

Parts List			
ITEM	PART NUMBER	DESCRIPTION	QTY
1	KSM40-T03	Tail boom brace	2
2	KSM60-039	Srimok screw M3x4	1
3	KSM60-040	Socket screw M3x5	1
4	KSM10-T21	Tail boom support	1
5	KSM60-005	Tail boom support screw M4x12	3
6	KSM60-006	Tail boom support screw M4x20	1

7. Install tail boom support drive and tail boom braces in place. And Turn tail boom support drive until parallel to main frame.

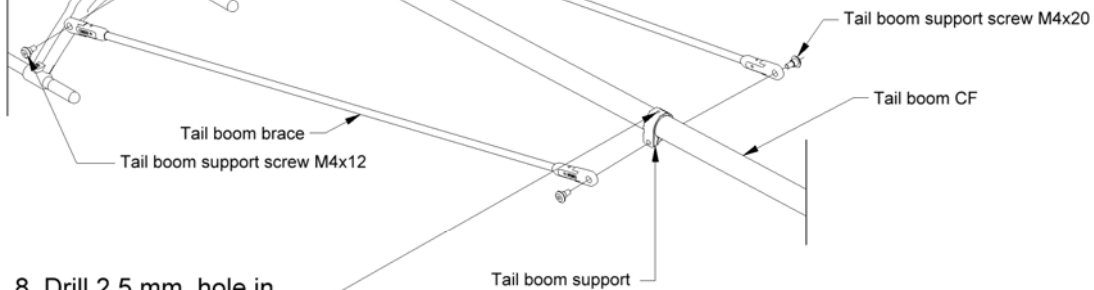

8. Drill 2.5 mm. hole in tail boom support.

9. Disassemble all step 7 and tail boom.

10. Drill 3mm holes in the previously drilled 2.5mm holes in the boom from steps 6 & 8. Clean swarf from inside of boom.

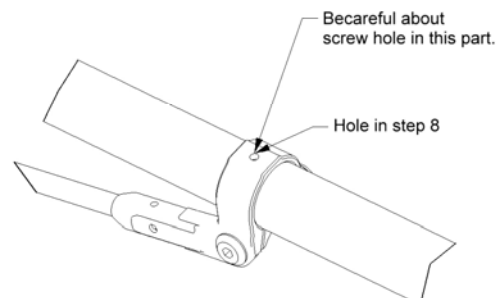

Note: Apply Blue thread lock to all screws, balls, and threads which it be fixed to metal-parts. For non-metal parts apply CA Glue.

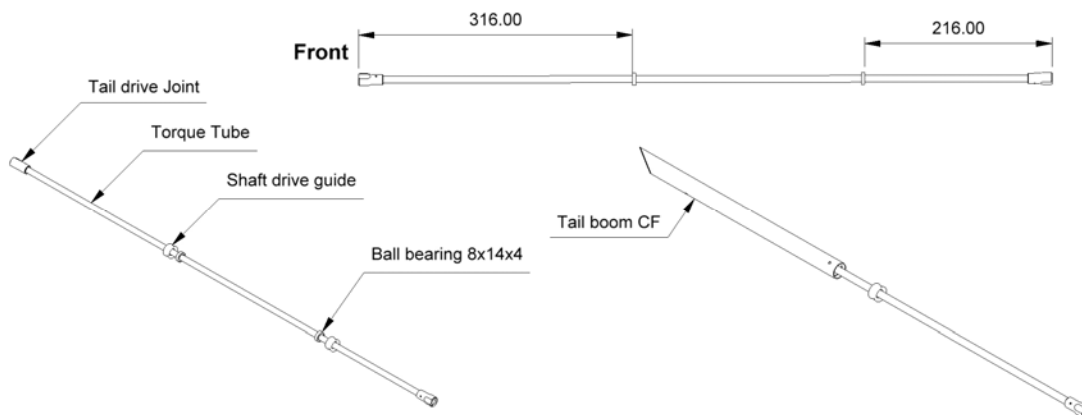

Tip to fix the torque tube

- 1) When inserting torque tube into boom lubricate rubber shaft guides with some light oil or silicon spray.
- 2) To insert the torque tube may take multiple passes pushing & pulling to work the rubber guides down the tube. Check the TT for smooth rotation when finished.
- 3) Push the tail boom into the tail boom clamp.

Parts List			
ITEM	PART NUMBER	DESCRIPTION	QTY
1	KSM10-T27	Torque Tube	1
2	KSM70-T04	Tail drive Joint	2
3	KSM30-120	Ball bearing 8x14x4	2
4	KSM70-T08	Shaft drive guide	2

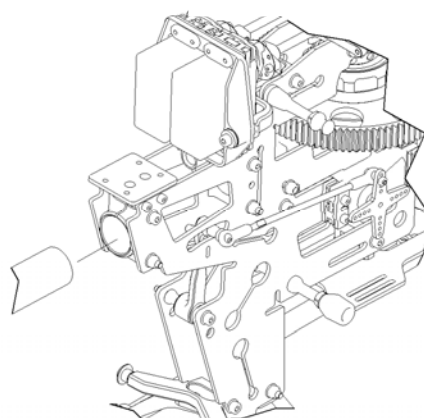
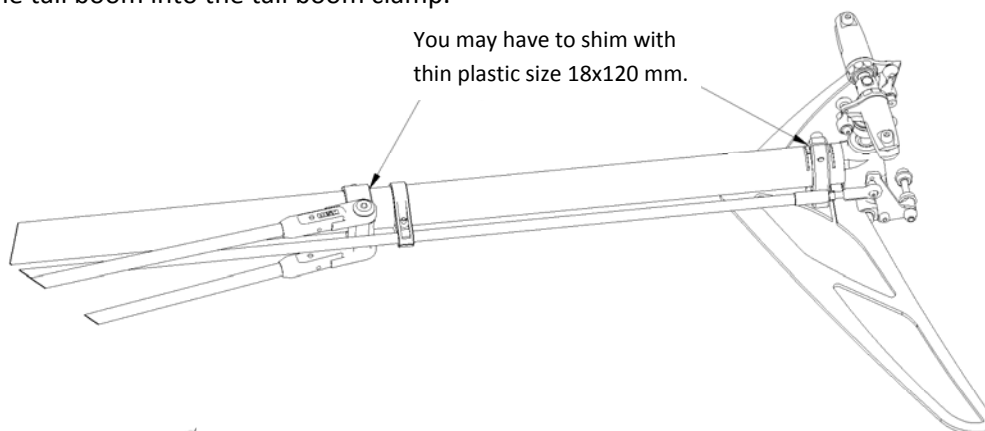

Parts List			
ITEM	PART NUMBER	DESCRIPTION	QTY
1	KSM70-T07	Rudder control rod guide	2
2	KSM70-T09	Teflon tube	2
3	KSM60-049	Nut M2	2
4	KSM60-041	Socket Screw M2x10	2
5	KSM40-T05	Unique rudder control rod	1

Note: Apply Blue thread lock to all screws, balls, and threads which it be fixed to metal-parts. For non-metal parts apply CA Glue.

TAIL BOOM ASSEMBLY

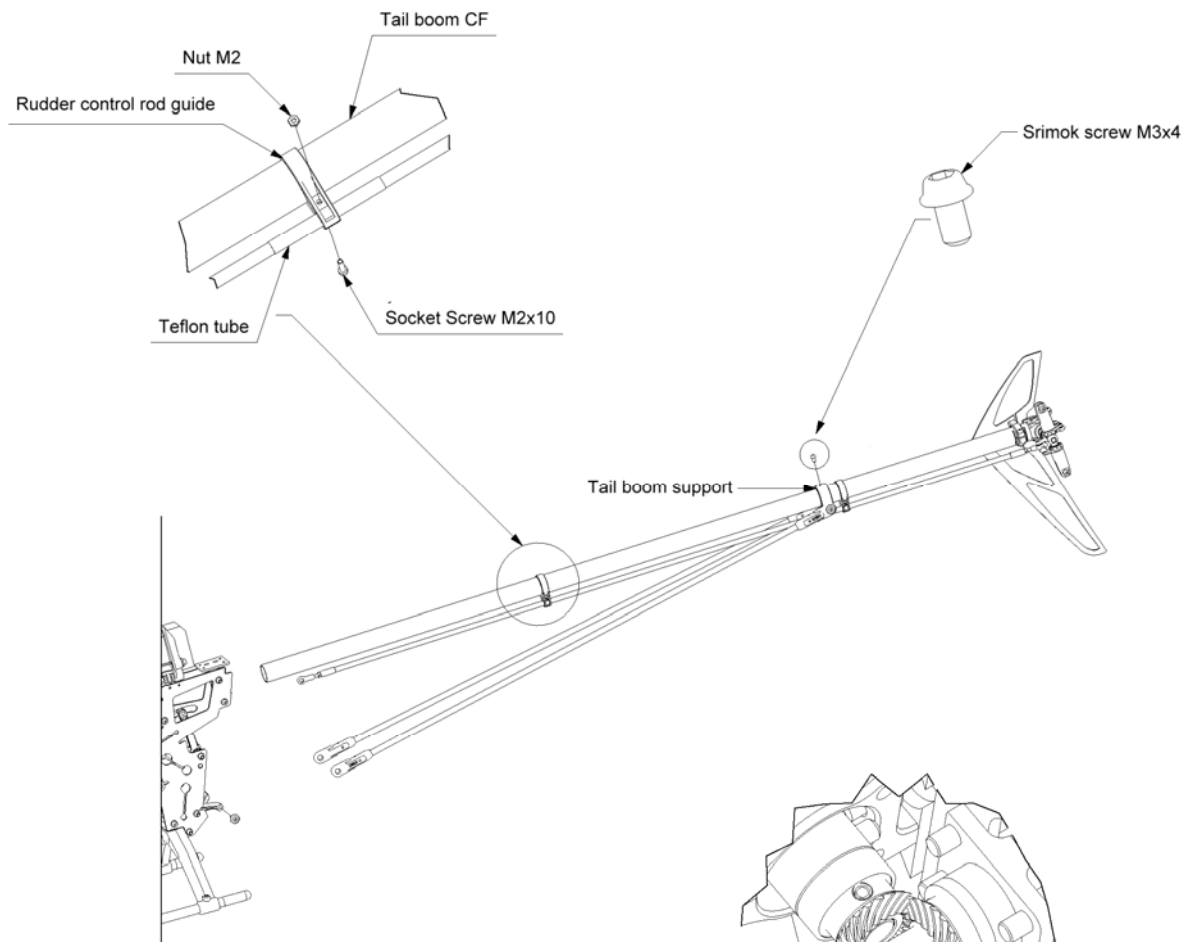

Note : Apply a drop of grease on four quadrants of the spiral whilst turning. Every 15-25 flights re-grease gears and drop oil onto ball bearings.

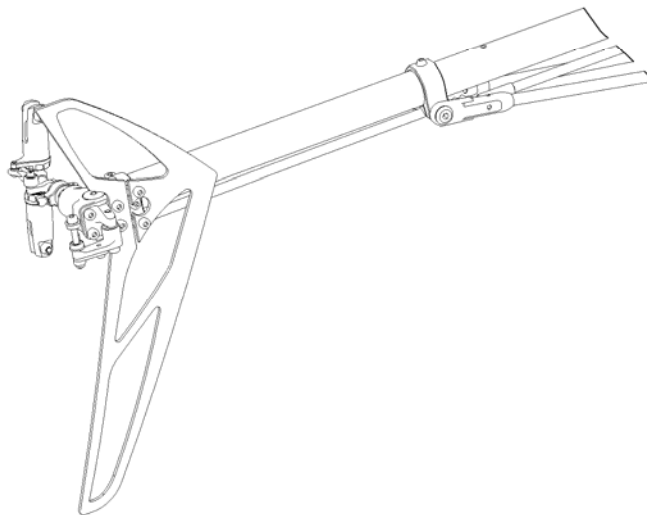

Note: Apply Blue thread lock to all screws, balls, and threads which it be fixed to metal-parts. For non-metal parts apply CA Glue.

PARTS LIST			
ITEM	PART NUMBER	DESCRIPTION	QTY
1	KSM 53-101	Canopy fiber glass for electric	1
2	KSM70-F04	Rubber grommet	4

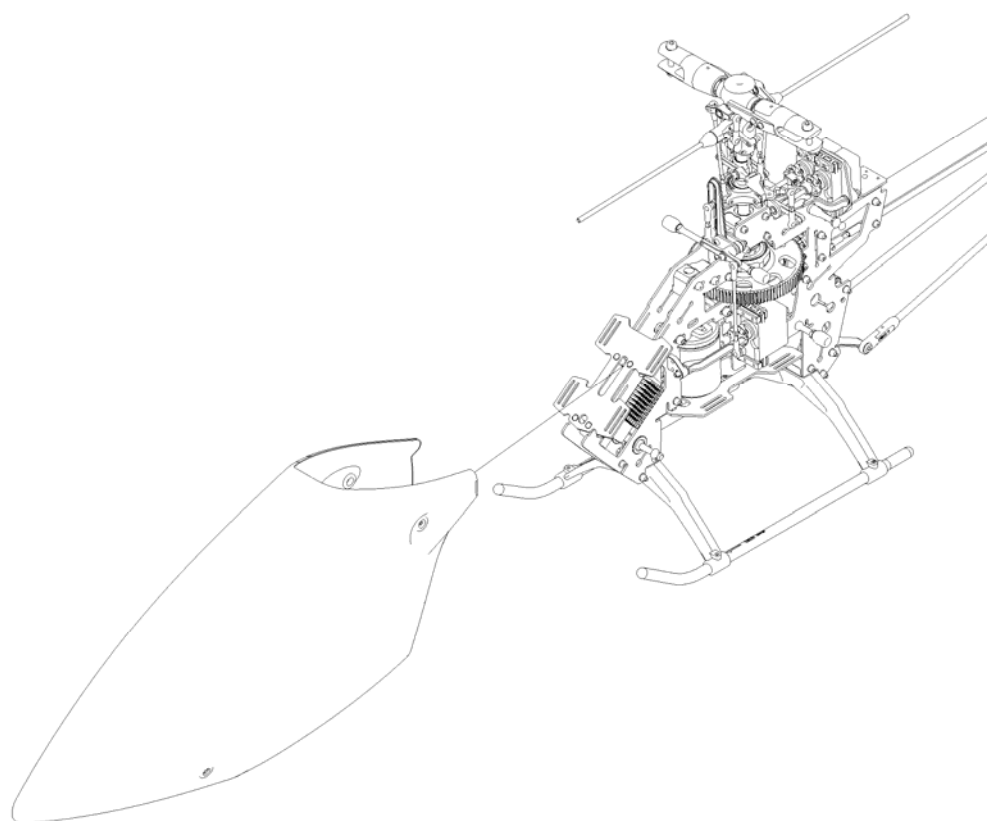
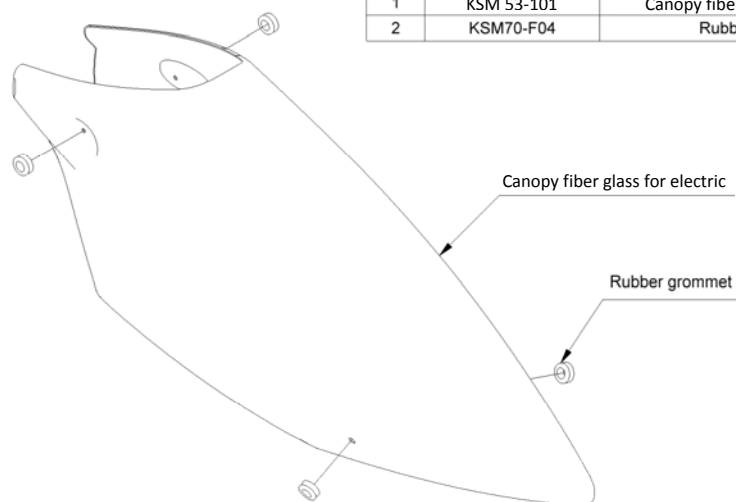

Note: Apply Blue thread lock to all screws, balls, and threads which it be fixed to metal-parts. For non-metal parts apply CA Glue.