

BILATERAL LOADING CONTAINER

2SIDE SYSTEM 2000

2000 L

Capacity

800 Kg

Load

1180 mm

Opening height



TECHNICAL SPECIFICATIONS

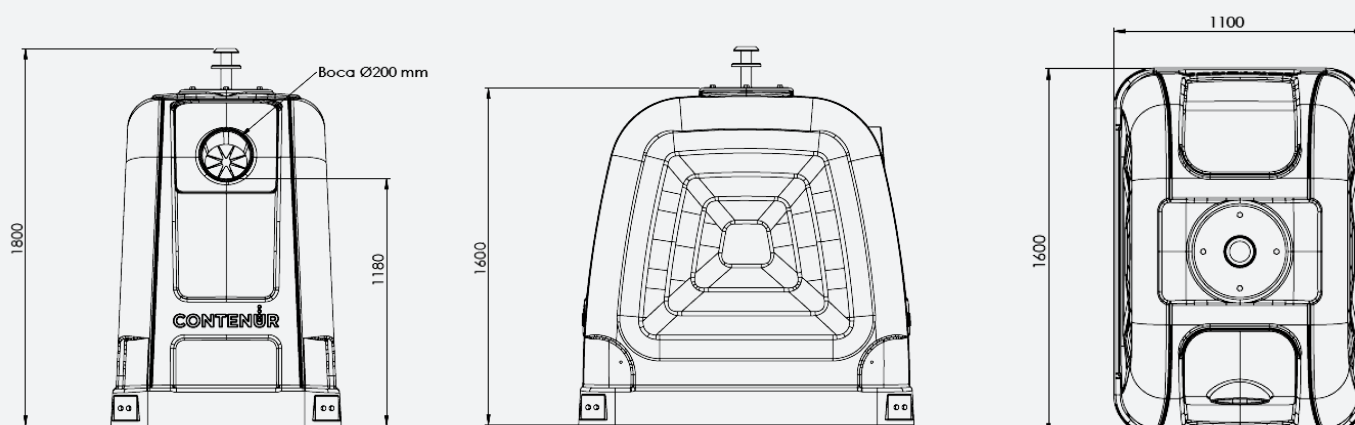

BILATERAL LOADING CONTAINER

2SIDE SYSTEM 2000

FEATURES

- Manufactured by rotational moulding with high-density linear polyethylene, mass-coloured and stabilised against the combined action of water and UV rays.
- Recyclable and environmentally friendly materials are used in their production.
- The pigments used do not contain heavy materials.
- The body is provided with ribs for strength and resistance. Exclusive CONTENUR design.
- Versions for each type of collection: paper, glass, packaging and organic.
- Recyclability rate: 100%..
- Treatment of the components by white zinc plating.

EQUIPMENT AND ACCESSORIES

- Lifting system: double hook or Kinshofer.
- Circular loading opening at a height of 1180 mm.
- Corrosion-protected metal lifting-emptying system.
- Large personalisation space with maximum dimensions of 445 x 480 mm (upper area) and 480 x 215 mm (lower area).
- Overlapping bottom gates to prevent spillage and to store leachate (compliance with EN 13071, 2% capacity).

CERTIFICATIONS

- This product has the following official certifications:
 - EN 13071-1 European Standard.
 - 170001 Universal Accessibility Standard.
 - Ecodesign Certificate, UNE-EN ISO 14006 standard.



2000



2800



3600

BILATERAL LOADING CONTAINER

2SIDE SYSTEM 2000

CUSTOMISATION AND EQUIPMENT

Possibility of customising the container with different accessories to offer solutions adapted to every need: lid opening pedal, hinged lid, manual lock, customisation.



PEDAL



CUSTOMISATION

Upper area: 445 x 480 mm
Lower area: 480 x 215 mm



MANUAL LOCK



LID OPTIONS

Hinged lid
Opening Ø200 mm



LENGTHWISE AND CROSSWISE POSITIONING



OPENINGS ON BOTH SIDES

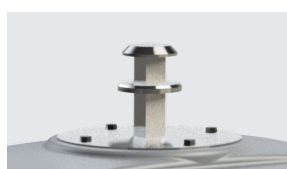

LIFTING SYSTEMS

Double hook
Kinshofer



OVERLAPPING GATES



TELESCOPIC ROD