

Zone 2 A60 Office Modules 10ft to 16ft



Dimensions and weight

16' Unit

4,875 (L) x 2,438 (W) x 2,591 (H)
 Tare Weight: 6,400 kg

14' Unit

4,260 (L) x 2,438 (W) x 2,591 (H)
 Tare Weight: 6,000 kg

12' Unit

3,645 (L) x 2,438 (W) x 2,591 (H)
 Tare Weight: 5,800 kg

10' Unit

3,048 (L) x 2,438 (W) x 2,591 (H)
 Tare Weight: 4,800 kg

Description

Centurion Accommodation & Modular Office Modules are manufactured in-house to the highest industry standards. All units are designed to optimise workspace efficiency, meet environmental and acoustic requirements and house your specialist equipment and resources in a safe and comfortable environment. Our Office Modules can be outfitted and modified to perform any number of functions to suit your specific project requirements. These modules provide a high quality for you and your clients.

Technical specifications

- **Fire Rating:** A60 SOLAS
- **HVAC:** 2 x 18,000 BTU Split Units – duty and standby
- **Detection and Alarm System:** Connection to main Rig / Vessel Alarm System included
- **Framework Design Temperature:** -20°C to +50°C
- **Electrical Connection:** Connection is 380-690Vac, 3Ph+E, 50/60Hz. Module is supplied with a 30m power cable as standard.

Global compliance

ATEX, IECEx, EN 12079, DNV 2.7-1, DNV 2.7-2, A60 SOLAS (CSC for 10' units)

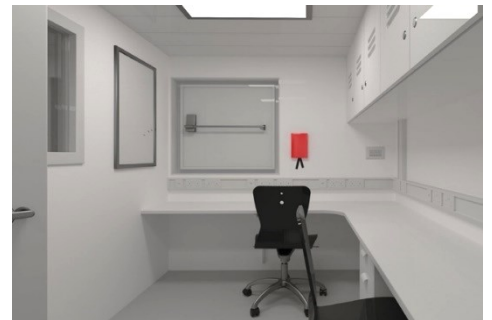

**Efficient, Safety-driven equipment, sales and rentals for
 our customers in the global critical industries**

Features & Benefits

- Detection and alarm system with Combined Pressurisation, Fire and Gas detection (CPFG) system with all ancillary items for Zone 2 use.
- Includes H₂S and HC gas detection, smoke detection, manual call point, pressurisation fan, loss of pressure and flow devices.
- 2 split type AHU inline HVAC systems developed by Centurion Accommodation & Modular to condition incoming pressurised air (hot, humid and cold).
- A60 Fire Dampers.
- A60 window and A60 escape hatch (800mm x 800mm) are provided as per DNV 2.7-2 requirement.
- Optional sprinkler head and piping can easily tie in to rig sprinkler system.
- Fitted with non-combustible B15 wall panels to ensure high thermal resistance and maximum noise reduction.
- CSC frame for minimised mobilization costs
- Easy access to all serviceable equipment for maintenance.
- CO₂ dry powder fire extinguisher provided.
- Non-porous topstone epoxy desktop, easy to clean, stain resistant and impermeable to most chemicals.

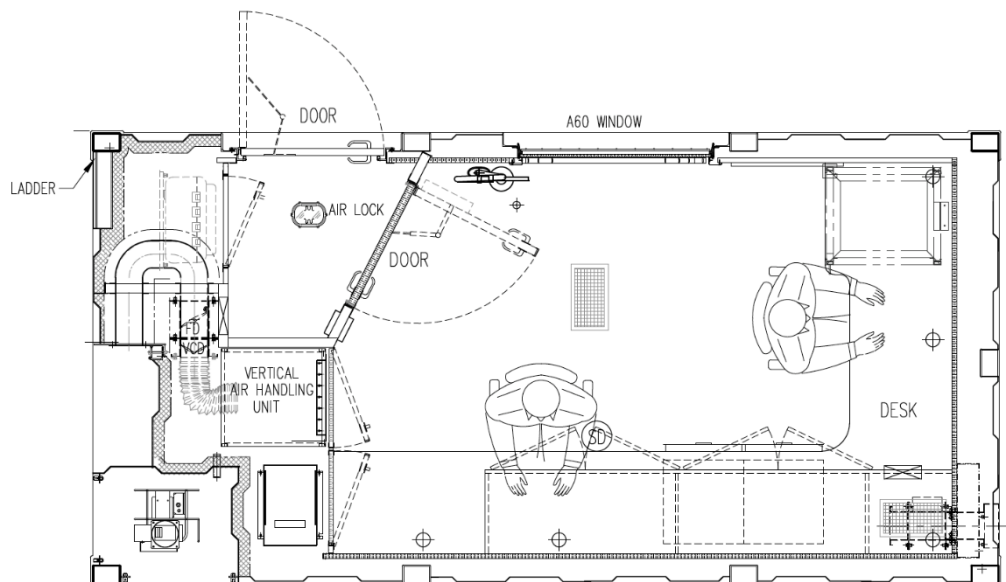
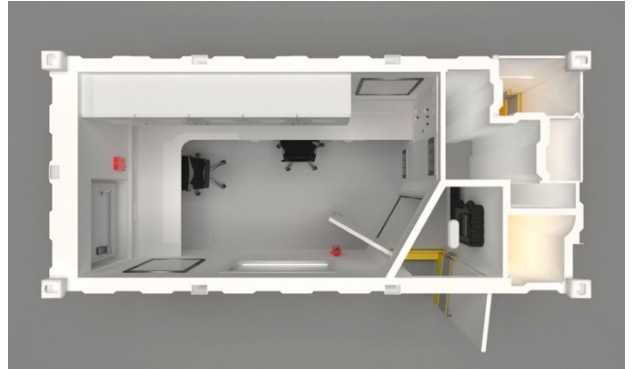

**Efficient, Safety-driven equipment, sales and rentals for
our customers in the global critical industries**