

ITEM	DESCRIPTION	QTY
D1	2040H X 870W METAL CLAD EXTERNAL DOOR	2
D2	2040H X 900W OPEN DOORWAY THROUGH TO KITCHEN	2

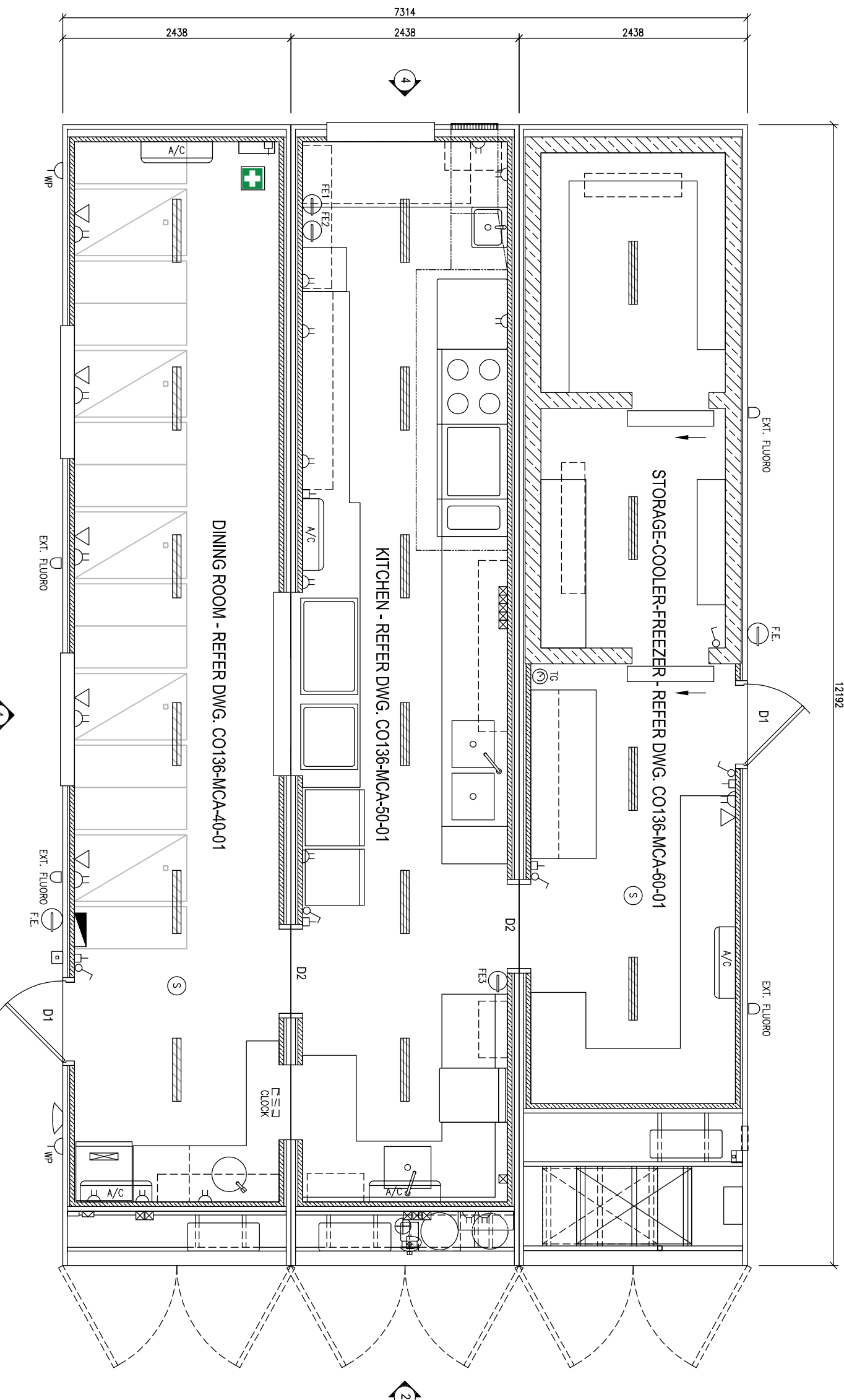

COMBINED PLAN LAYOUT
DINING-KITCHEN-STORAGE-COOLER-FREEZER

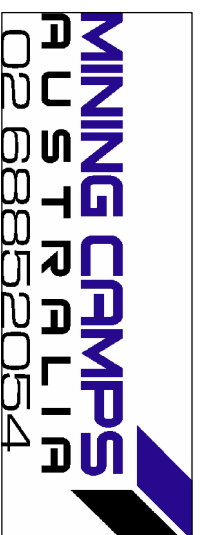

R.S.	18.02.14	ISSUE FOR USE	B
R.S.	15.01.14	ISSUE TO CLIENT	A
APPD.	DATE	DETAILS	ISS.
DATE:	14.01.14	APPROVED:	RS
DRAWN:	P.G.	CHECKED:	RS
SCALES:	1-25 (A1); 1-50 (A3) U.N.O.		

STAFFORD ADAMSON
PROJECT MANAGERS & CONSULTING ENGINEERS
PO BOX 7120
TOOWOOMBA SOUTH
QLD 4352
Phone: (07) 4639 6600 Fax: (07) 4639 6300
Email: staffadam@staffadam.com.au

PROJECT:	MINING CAMPS AUSTRALIA - TRANSFIELD-1 CAMP
TITLE:	DINING-KITCHEN STORAGE-COOLER-FREEZER COMBINED FLOOR PLAN
DRAWING No.	CO136-MCA-65-01
REVISION	B