

VPFlowScope 35 bar

User manual
© 2018 Van Putten Instruments BV



VPFlowScope 35 bar

© 2018 Van Putten Instruments BV

All rights reserved. No parts of this document may be reproduced in any form or by any means - graphic, electronic, or mechanical, including photocopying, recording, taping, or information storage and retrieval systems - without the written permission of the publisher.

Products that are referred to in this document may be either trademarks and/or registered trademarks of the respective owners. The publisher and the author make no claim to these trademarks.

While every precaution has been taken in the preparation of this document, the publisher and the author assume no responsibility for errors or omissions, or for damages resulting from the use of information contained in this document or from the use of programs and source code that may accompany it. In no event shall the publisher and the author be liable for any loss of profit or any other commercial damage caused or alleged to have been caused directly or indirectly by this document.

Creation date: 23-02-2018 in Delft

Publisher

*Van Putten Instruments BV
Buitenwatersloot 335
2614 GS Delft
The Netherlands*

Table of Contents

1 Warning - Read this first	4
2 Installation step by step	5
3 Specifications	7

1 Warning - Read this first

	<p>Compressed air can be dangerous! Please familiarize yourself with the forces under pressurized conditions. Respect the local guidelines and regulations for working with pressurized equipment.</p> <p>The pressure on the probe at 35 bar / 500 psi is around 40 Kilogram / 88 pounds force</p>
	<p>! WARNING Mounting of this unit should be in De-Pressurized lines only !</p>
	<p>Mount two safety chains, one to keep the probe in place, one for safety. Make sure the hooks are completely closed. Make sure that the chains are strained as these chains will keep the probe in position.</p>
	<p>Use both safety eyes, to keep the force on the probe equal. Securing the probe on one side will cause the probe to bend.</p>
	<p>Use compression fittings with stainless steel ferrules. Please note that stainless steel will permanently indent the probe and it cannot be used for any other installation anymore.</p>
	<p>Pressurize the system gently, 250 mbar per second. Fast pressurization may result in shifting of the probe due to the pressure shock.</p>
	<p>INSPECT the system after 30 minutes to see if the probe is still at the same height. Systems with VIBRATIONS may be causing shifting of the probe.</p>

Order numbers:

High pressure option for VPFlowScope probe VPA.0001.092

Compression fitting with stainless steel ferrule VPA.0001.003

2 Installation step by step

The following cartoons show how to install the probe in a 35 bar system. In addition to the compression fitting with stainless steel ferrules (rated well over 35 bar) we recommend to use two safety chains, for redundancy.

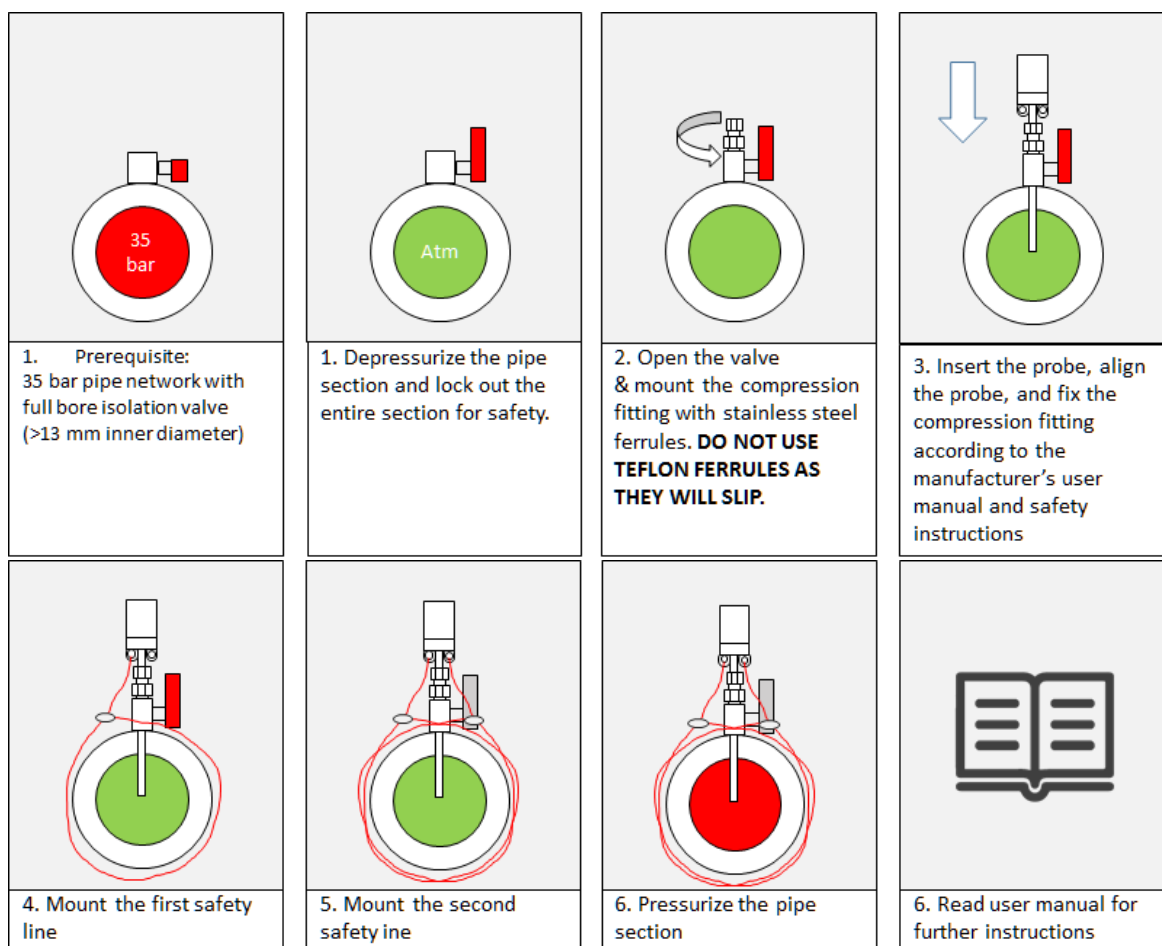

Compression fitting instructions

NOTE: the following instructions apply to stainless steel ferrules only. For use with teflon ferrules, there are no specific guidelines. This is why we do NOT recommend to use teflon ferrules in high pressure systems.

Step 1:

Before tightening the nut, mark the 6 o'clock position

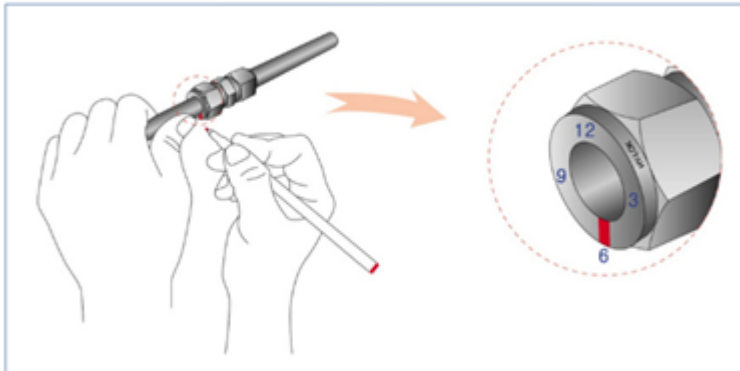

Step 2:

When fixing, use a wrench. Tighten the nut 1 ¼ turns. The mark on the nut turns 1-1/4 and will end at the 9 o'clock position. **Make sure the probe stays aligned during the process.**

If not, gently loosen the nut, align the probe and tighten it again. Rough turning of the probe can cause scratches in the stainless steel and this might result in leakage.

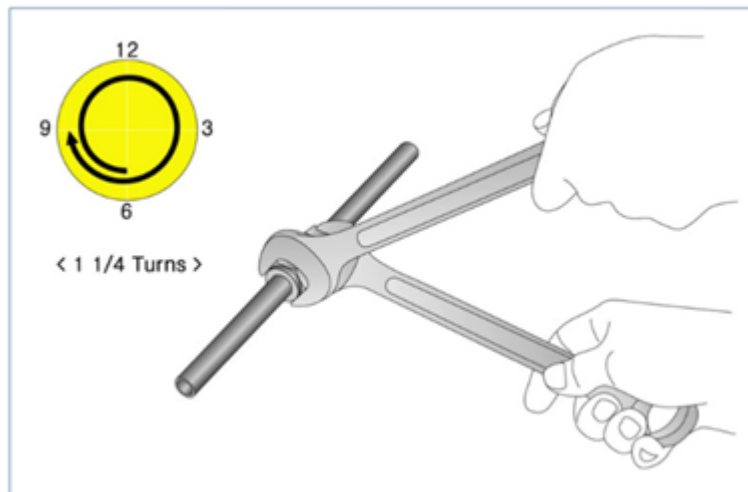

3 Specifications



Please always check the label of your product for the specifications.

Specifications are subject to change as we are continuously improving our products. Please contact us to obtain the latest specification sheet.

Flow sensor

(minimum detection level and max flow rate shown)

Flow range	0.5...150 m _n /sec	1.7...492 sfps
Accuracy	2% of reading under calibration condition	
	Recommended pipe diameter: 40mm 1.5 inch and up	
Reference conditions	0°C, 1013.25 mbar - DIN1343	32°F, 14.65 psi
Gas temperature	0...60°C	32...140°F
Gases	Compressed air, non aggressive gases and non combustible gases, 95% non condensing gases	

Pressure sensor

Range	0...35 bar gauge	0...500 psi gauge
Accuracy	+/- 1.5% FSS (0...60°C)	+/- 1.5% FSS (32...140°F)

Temperature sensor

Range	0...60°C	32...140°F
Accuracy	+/- 1° (from 10 m _n /sec and up) (At zero flow conditions, temperature reading increases due to self-heating by the flow sensor)	

Display

Technology	Liquid crystal
Back light	Blue with auto power save
Memory	2.000.000 point memory

Mechanical

Probe length	400 mm	15 inch
Probe diameter	12.7 mm	0.5 inch
Process connection	Compression fittings, 0.5 inch, NPT thread	
Pressure rating	See product label. Only rated for high pressure when fixed with stainless steel ferrules.	
IP grade	IP52 when mated to display module IP63 when mated to connector cap	
Wetted materials	Alu, SS316, epoxy	
Ambient temperature	0...60°C	32...140°F
Ambient humidity	10 - 95%. Avoid condensation at all times	

Inputs and outputs

Analog	4..20mA or pulse, selectable via installation software
Serial IO	Modbus RTU
Supply	12..24 VDC +/-10% CLASS 2 (UL)
Power consumption	150mA at 24VDC

EASY INSIGHT INTO ENERGY FLOWS

Trido Energy Services
#1425 407 2nd Street SW,
Calgary, AB T2P 2Y3
Canada
info@tridoes.com
+1 (855) 368-7438

AN-VP-SP35-UK-1800

Date: 23-02-2018



INSTRUMENTS

