

# A 2

---

46.90m Feadship 1983 (2022)



**CECIL WRIGHT**

# A 2

**BUILDER:** FEADSHIP

**YEAR BUILT:** 1983 (2022)

**LOA:** 46.90M

**PRICE:** \$16,900,000



Main Salon





Dining Area





Sky Lounge & Hallway





Master Stateroom & Bathroom



Guest Cabin & Bathroom





Guest Cabins & Bathroom





Guest Cabin & Bathroom





Bridge & Exterior Decks





Exterior Decks





Exterior Decks





Exterior Profile





Exterior Profile





Exterior Profile

# Specifications

## Main Characteristics

TYPE:	DISPLACEMENT MOTOR YACHT
BUILDER:	FEADSHIP
HULL NO:	627
IMO NUMBER:	1008035
NAVAL ARCHITECT:	DE VOOGT NAVAL ARCHITECTS BMT NIGEL GEE
EXTERIOR DESIGN:	DE VOOGT NAVAL ARCHITECTS
INTERIOR DESIGN:	PETER MARINO ARCHITECTS
YEAR:	1983
REBUILT:	2012
REFIT:	2022
CLASSIFICATION:	LLOYD'S REGISTER
CONSTRUCTION:	STEEL HULL ALUMINIUM SUPERSTRUCTURE TEAK DECKS
FLAG:	CAYMAN ISLANDS
ENGINES:	2 X MTU 16V 2000 M61

GT:	458
NT:	137
DISPLACEMENT APPROX:	412 TONS
LOA:	46.90M / 153' 10"
LWL:	40.90M / 134' 2"
BEAM:	8.08M / 26' 6"
DRAFT:	2.41M / 7' 11" MAX
MAXIMUM SPEED:	15.00 KNOTS
CRUISING SPEED:	12.00 KNOTS
RANGE:	3,500NM AT 12.00 KNOTS
FUEL CONSUMPTION:	156 LITRES / 41 US GALLONS PER HOUR (2 ENGINES @ 1,250 RPM + 1 GENERATOR)
ACCOMMODATION:	12 + 3 GUESTS IN 5 CABINS
CREW:	9 X CREW IN 5 CABINS
FUEL:	50,000 LITRES / 13,209 US GALLONS
FRESH WATER:	18,300 LITRES / 4,834 US GALLONS



# General Arrangement



Side Profile

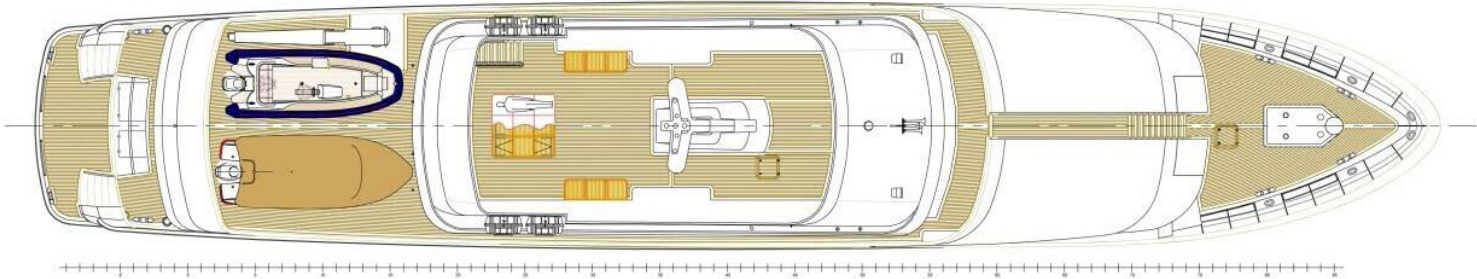

Sun Deck

# General Arrangement

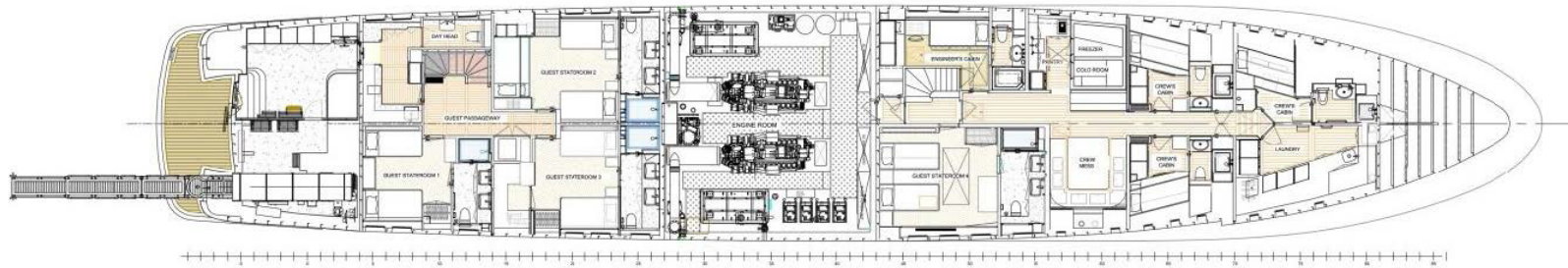



## **CECIL WRIGHT**

### **LONDON**

73 St James's Street  
London  
SW1A 1PH  
Tel: +44 20 7408 1001

### **MONACO**

Le Beau Rivage  
9 avenue d'Ostende  
MC 98000 Monaco  
Tel: +377 97 98 76 60

### **JERSEY**

The Coach House  
Waldegrave  
Jersey JE3 8BA  
Tel: +44 20 7408 1001