

# Alfa-V VDD

## Industrial dry coolers V-type

### General information & application

The Alfa-V VDD series is a wide range of heavy duty V-type dry coolers for HVAC, refrigeration and various industrial applications such as water/glycol cooling.

For industrial applications, dry coolers are suitable for closed circuit cooling of various process liquids in f.i. food, power, process and general industries. Alfa-V VDD dry coolers provide high capacities at reduced power consumption and a compact footprint.

Capacity range\* 100 up to 1800 kW

\*water, EN1048.

### Coil

The coil design provides excellent heat transfer. In standard execution dry coolers are fitted with smooth copper tubing  $\varnothing$  12 and 16 mm (VDD) or stainless steel tubing 16 mm (VDDY).

Fins in aluminium or sea water resistant AlMg, plain fin design for easy cleaning and long-lasting performance.

Separate connections provide the opportunity for independent operation of both cooling coils.

### Casing

Frame construction provides high rigidity for protection against vibration and thermal expansion. Casing, supports and frame made of corrosion resistant galvanized steel (class C4-H).

Separated fan sections and removable fan rings.

### Fan motors

ErP compliant fan AC & EC motors, available in three fan diameters (800, 910 & 1000 mm) and different noise levels. Motors with external rotor, protection class IP54 according to DIN 40050.

AC power supplies 400/50/3, 400/60/3 and 460/60/3 with integrated thermo contacts to provide reliable protection against thermal overload. EC power supply 380-480/50-60/3.



Alfa-V VDD

### Design pressure

Design pressure 10 bar. Each heat exchanger is leak tested with dry air.

### Benefits

- Heavy duty design with high corrosion resistance.
- Favorable capacity/footprint ratio.
- Available with easily cleanable industrial fins.
- Excellent sound characteristics.
- Reliable performance, Eurovent certified.
- Easy installation & maintenance.
- Energy efficient - low total cost of ownership.
- Two-year product guarantee.
- Easy access to additional on-line product information (QR code).



Alfa-V VDD

## Options

- Fin spacing up to 3.0 mm
- Coil corrosion protection
  - Epoxy coated aluminium fin (EP)
  - F-coat (FC)
  - Seawater resistant aluminium AlMg (SWR)
  - Industrial R-fin (RIF)
  - Epoxy coated aluminium R-fin (REP)
  - Seawater resistant aluminium AlMg R-fin (RSWR)
- Coil protection grid (GR)
- Spray Water kit (KW)
- Water Spray system including pumping station (SWS)
- Casing coated RAL 9002 (other colors on special request)
- Container skid (SK)
- Ladder and railings
- Vibration dampers (VD)
- Expansion tank (ET)
- Special fan motors
  - Protection class IP55
  - High-temperature motors
  - IEC standard motors
- Electrical accessories
  - Isolating switch (SW)
  - EC Motors wired to a common terminal box (CBP=connection box, CBMT=connection box and master controller+temperature signal)
  - Switchboard IP54 (BS)
  - AC fan speed control cabinet (BST)
  - EC fan speed control cabinet (ICM)
  - Basic EC switchboard panel (ECCB)

## Code description

VDD	SE	90	4	.1	B	D	72	SK	C4	*	-	AL	2.1	CU	*
1	2	3	4	5	6	7	8	9	10	11		12	13	14	15

- Alfa-V dry cooler (VDD = standard Cu tube, VDD6 = 5/8" Cu, VDDY = 5/8" SS304)
- Sound level/fan code (T=turbo, S=standard, L=low, Q=quiet, R=residential, E=EC fan motor)
- Fan diameter (80=800, 90=910, 100=1000 mm)
- Number of fan pairs (2 to 9)
- Alfa-V series II
- Tube rows code (A, B, C, D)
- Fan motor connection (D=delta, Y=star)
- No of circuits
- Packing (SK=container skid)
- Case material
- Electrical accessories
- Fin material/coating (AL=aluminium, IF=industrial fins, SWR=AlMg, EP=epoxy coated aluminium, FC=F-coat, RIF=industrial R-fin, REP=epoxy coated aluminium R-fin, RSWR=AlMg R-fin)
- Fin spacing (2.0, 2.1, 2.3, 2.5, 3.0 mm)
- Tube material (CU=copper, SS=stainless steel)
- Options

Nr. of fan pairs	Dimensions mm		
	L	H	W
2	2940	2500	2230
3	4250	2500	2230
4	5560	2500	2230
5	6870	2500	2230
6	8190	2500	2230
7	9490	2500	2230
8	10800	2500	2230
9	12100	2500	2230

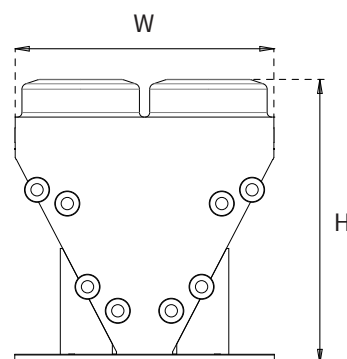
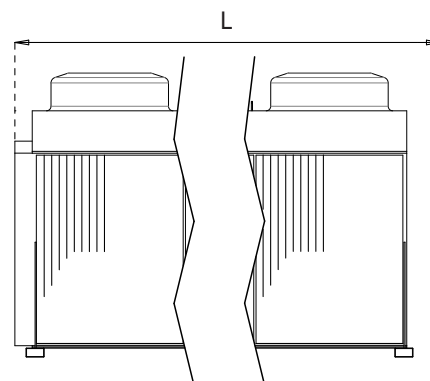

## Selection

Selection and pricing is to be performed with our Alfa LU-VE air heat exchanger selection software. Selection output includes all relevant technical data and dimensional drawings.

## Certifications

All VDD dry cooler models are "Eurovent Certify All" certified. The Alfa LU-VE quality system is in accordance with ISO 9001 and ISO 14001. All products are manufactured according to PED regulations.



AHE00016EN 2101

Alfa LU-VE is a trademark registered and owned by LU-VE Group. Alfa LU-VE reserves the right to change specifications without prior notification.

## How to contact Alfa LU-VE

Up-to-date Alfa LU-VE contact details for all countries are always available on our website at [alfa.luvegroup.com](http://alfa.luvegroup.com)