

DATED 28th July **2021**

HIGHWAYS ENGLAND COMPANY LIMITED

**THE HIGHWAYS ENGLAND (M621 MOTORWAY JUNCTIONS 1 TO 7
IMPROVEMENTS) COMPULSORY PURCHASE ORDER 2019**

GENERAL VESTING DECLARATION No 4

**THE HIGHWAYS ENGLAND (M621 MOTORWAY JUNCTIONS 1 TO 7
IMPROVEMENTS) COMPULSORY PURCHASE ORDER 2019**

This **GENERAL VESTING DECLARATION** is executed on the 28th day of July 2021 by Highways England Company Limited (company number: 09346363) ("the Authority")

WHEREAS:

- (1) On 27 November 2020 an order entitled the Highways England (M621 Motorway Junctions 1 to 7 Improvements) Compulsory Purchase Order 2019 ("the Order") was confirmed by the Secretary of State for Transport under the powers conferred on him by the Highways Act 1980, authorising the Authority to acquire the land specified in the Schedule hereto.
- (2) Notice of the confirmation of the Order was first published in accordance with section 15 of the Acquisition of Land Act 1981 on 17 December 2020.
- (3) That notice included the statement and form prescribed under section 15(4)(e) and (f) of the Acquisition of Land Act 1981.

NOW THIS DEED WITNESSETH that, in exercise of the powers conferred on them by section 4 of the Compulsory Purchase (Vesting Declarations) Act 1981 ("the Act"), the Authority hereby declare –

[1] The land described in the Schedule hereto (being part of the land authorised to be acquired by the Order) and more particularly delineated pink on the plan annexed hereto, together with the right to enter upon and take possession of the land shall vest in the Authority as from the end of the period of 3 months from the date on which the service of notices required by section 6 of the Act is completed.

SCHEDULE

Plot number	Title Number	Land to be acquired
2/5	WYK915464	All interests in 7 square metres of part of highway verge of the M621 Junction 2A westbound off-slip road on the east of Cemetery Road and the north of Normanton Grove.
2/5a	WYK928428	All interests in 53 square metres of part of highway, verge, trees and embankment of the M621 Junction 2A westbound off-slip road on the east of Cemetery Road and north of Normanton Grove.
2/5b	WYK928428	All interests in 16 square metres of part of highway of the M621 Junction 2A westbound off-slip road on the east of Cemetery Road and north of Normanton Grove except for the interests of Yorkshire Water Services Ltd.

2/5c	Unregistered?	All interests in 69 square metres of part of highway, verge, trees and embankment of the M621 Junction 2A westbound off-slip road on the east of Cemetery Road and north of Normanton Grove.
2/5d	Unregistered?	All interests in 18 square metres of part of highway of the M621 Junction 2A westbound off-slip road on the east of Cemetery Road and north of Normanton Grove except for the interests of Yorkshire Water Services Ltd.
2/5e	Unregistered?	All interests in 71 square metres of part of highway verge, trees and embankment of the M621 Junction 2A westbound off-slip road on the east of Cemetery Road and north of Normanton Grove.
2/5f	Unregistered?	All interests in 2 square metres of part of highway verge, trees and embankment of the M621 Junction 2A westbound off-slip road on the east of Cemetery Road and north of Normanton Grove.
2/5g	Unregistered?	All interests in 18 square metres of part of highway of the M621 Junction 2A westbound off-slip road on the east of Cemetery Road and north of Normanton Grove except for the interests of Yorkshire Water Services Ltd.
2/5h	Unregistered?	All interests in 2 square metres of part of highway of the M621 Junction 2A westbound off-slip road on the east of Cemetery Road and north of Normanton Grove except for the interests of Yorkshire Water Services Ltd.
2/6	YWE30833	All interests in 7 square metres of part of highway of the M621 Junction 2A westbound off-slip road on the east of Cemetery Road and north of Normanton Grove.
2/6a	YWE30833	All interests in 19 square metres of part of highway of the M621 Junction 2A westbound off-slip road on the east of Cemetery Road and north of Normanton Grove except for the interests of Yorkshire Water Services Ltd.
2/6b	YWE30833	All interests in 1 square metres of part of highway verge of the M621 Junction 2A westbound off-slip road on the east of Cemetery Road and north of Normanton Grove.
2/8	YWE54031	All interests in 5 square metres of part of highway verge, trees and embankment of the M621 Junction 2A westbound off-slip road on the east of Cemetery Road and north of Normanton Grove
2/9	WYK874127, YWE47932, YWE61573, YWE47035	All interests in 743 square metres of part of highway verge, trees and embankment of the M621 Junction 2A westbound off-slip road on the east of Cemetery Road and northeast of Normanton Grove.
2/9a	WYK874127, YWE47932, YWE61573, YWE47035	All interests in 342 square metres of part of highway verge, trees and embankment of the M621 Junction 2A westbound off-slip road on the east of Cemetery Road and northeast of Normanton Grove except for the interests of Yorkshire Water Services Ltd.

2/9b	WYK874127, YWE47932, YWE61573, YWE47035	All interests in 221 square metres of part of highway of the M621 Junction 2A westbound off-slip road on the east of Cemetery Road and northeast of Normanton Grove except for the interests of Yorkshire Water Services Ltd.
2/11	YWE26831	All interests in 30 square metres of part of highway of the M621 Junction 2A westbound off-slip road on the east of Cemetery Road, northeast of Normanton Grove and northwest of Cambrian Street except for the interests of Yorkshire Water Services Ltd..
2/11a	YWE26831	All interests in 27 square metres of part of highway verge, trees and embankment of the M621 Junction 2A westbound off-slip road on the east of Cemetery Road, northeast of Normanton Grove and northwest of Cambrian Street except for the interests of Yorkshire Water Services Ltd.
2/12	WYK928417, YWE48551, YWE39808	All interests in 193 square metres of part of highway, verge, trees and embankment of the M621 Junction 2A westbound off-slip road on the east of Cemetery Road, northeast of Normanton Grove and northwest of Cambrian Street except for the interests of Yorkshire Water Services Ltd.

The plot numbers above relate to the plot numbers shown on the plan accompanying this General Vesting Declaration.

EXECUTED as a DEED

by affixing the common seal of
HIGHWAYS ENGLAND
COMPANY LIMITED

N Freeman
.....
Director or Authorised Signatory

David
.....
Director or Company Secretary or Authorised Signatory



2021/939



© Crown Copyright. All Rights Reserved. License Number HIGHWAYS ENGLAND 100030649



CEMETERY ROAD

HOLBECK MOOR
RECREATION GROUND

WITHIN THE PARISH OF BEESTON
& HOLBECK IN THE CITY OF LEEDS

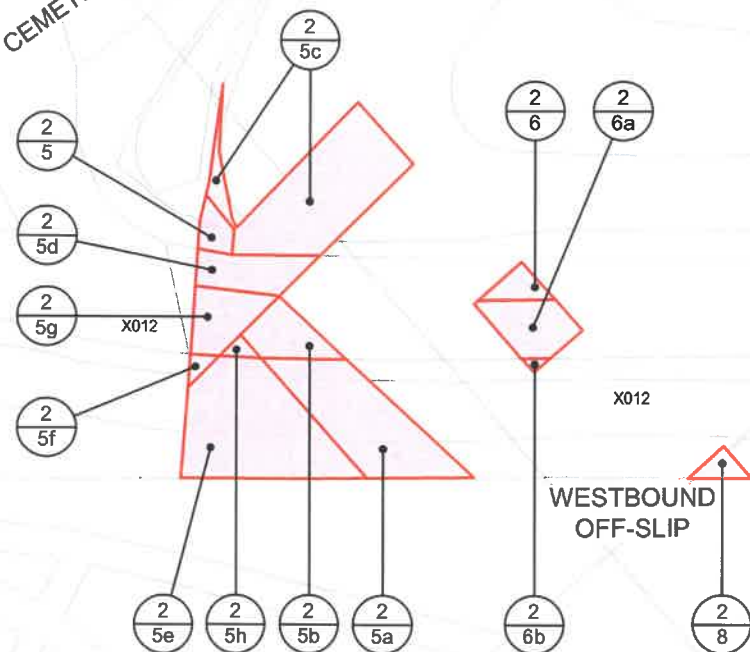

INSET - Scale 1:500

JUNCTION 2A

RECREATION VIEW
RECREATION TERRACE
RECREATION PLACE

CROSBY ROAD

THE UNITED
BAR (PH)

TILBURY ROAD

EASTBOUND
M621
WESTBOUND

SEE INSET
CEMETERY ROAD

X011

X013

WESTBOUND OFF-SLIP

NORMANTON
GROVE

2/9

2/9a

2/9b

2/11a

2/11

X012

EASTBOUND
M621
WESTBOUND

X013

2/12

CAMBRIAN STREET

NORMANTON PLACE

Highways England Company Limited
Bridge House,
1 Walnut Tree Close,
Guildford
GU1 4LZ



PLAN 1 OF 1 REFERRED TO IN

THE HIGHWAYS ENGLAND
(M621 MOTORWAY JUNCTIONS 1 TO 7 IMPROVEMENTS)
COMPULSORY PURCHASE ORDER 2019

GENERAL VESTING DECLARATION No. 4

The COMMON SEAL of
HIGHWAYS ENGLAND COMPANY LIMITED

Director or Authorised Signatory

Director or Company Secretary or Authorised Signatory

No.

Dated 28 July Year 2021



KEY:

- LAND TO BE ACQUIRED
- DISTRICT BOUNDARY
- PARISH BOUNDARY
- EXISTING PUBLIC RIGHT OF WAY (BW / FP / NCN / Byway)

NOTES:

FOR PLOT REFERENCE NUMBERS PLEASE REFER TO: 'THE HIGHWAYS ENGLAND (M621 MOTORWAY JUNCTIONS 1 TO 7 IMPROVEMENTS) COMPULSORY PURCHASE ORDER 2019'

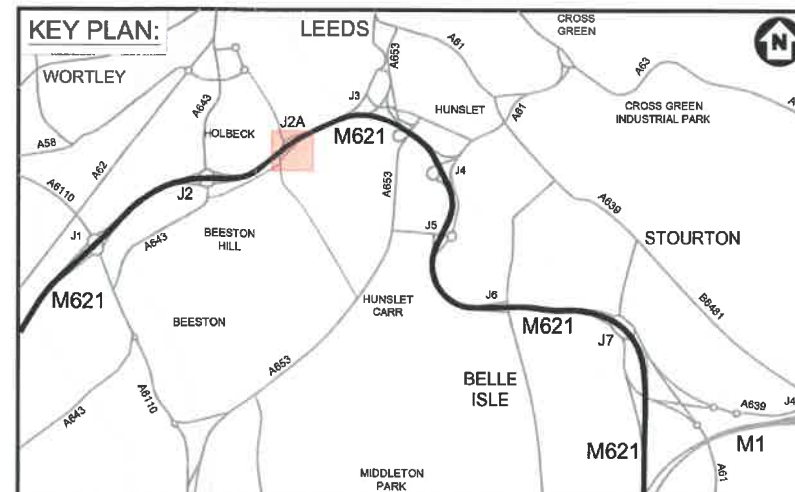

Drawn	Check	Review	Auth.	Date	Size	Scale
MT	HC	SR	SR	28/04/21	A3	1:1250

Drawing Number
HE551464-ATK-LHA-XX-DR-ZL-000604

Rev.
C01

SCALE 1:500
0m 5m 10m 15m 20m

SCALE 1:1250
0m 10m 25m 50m 75m 100m 125m

2021/939