

THE HIGHWAYS ENGLAND (A27 TRUNK ROAD EAST OF LEWES IMPROVEMENT SCHEME) (SHARED USE PATH) COMPULSORY PURCHASE ORDER 2019 ("CPO 2")

GENERAL VESTING DECLARATION No. 3

THIS GENERAL VESTING DECLARATION is made the 10 day of August 2021

by **HIGHWAYS ENGLAND COMPANY LIMITED** (the "**Authority**")

WHEREAS:

1. On 19 July 2021 an order entitled The Highways England (A27 Trunk Road East of Lewes Improvement Scheme)(Shared Use Path) Compulsory Purchase Order 2021 ("the Order") was confirmed by the Secretary of State for Transport under the powers conferred on him by the Highways Act 1980 and the Acquisition of Land Act 1981 authorising the Authority to acquire all interests in the land specified in Schedule 1.
2. Notice of the confirmation of the Order was published in accordance with section 15 of the Acquisition of Land Act 1981 on 6 August 2021.
3. That notice included the statement and form prescribed under section 15(4)(e) and (f) of the Acquisition of Land Act 1981.

NOW THIS DEED WITNESSES that, in exercise of the powers conferred on them by section 4 of the Compulsory Purchase (Vesting Declarations) Act 1981 ("Act"), the Authority hereby declare:-

1. The land described in column 2 of the Schedule hereto (being part of the land authorised to be acquired by the Order) and more particularly coloured pink on the plan annexed hereto, together with the right to enter upon and take possession of the land save for any interests in the land belonging to any Excluded Persons set out in column 3 of the Schedule, shall vest in the Authority as from the end of the period of 3 months from the date on which the service of notices required by section 6 of the 1981 Act is completed ("Vesting Date").
2. For the purposes of section 2(2) of the 1981 Act, the specified period in relation to the land comprised in this Declaration is one year and one day.

SCHEDULE

(1) Plot No.	(2) Description	(3) Excluded Persons	(4) Title No Indicative Only
9-18	Acquisition of Title in respect of 666 metres squared of field and agricultural land (south of Lewes Road, A27, Berwick)	Drusillas Zoo Park Limited but only in respect of rights granted by a Deed of Easement and Release of Covenant dated 26 June 2015	ESX221484
9-19	Acquisition of Title in respect of 8685 metres squared of field and agricultural land, hedgerow, drain, river, bed and banks thereof (Cuckmere River) (south of Lewes Road, A27, Berwick and Long Man) except those owned by the Authority	Barclays Bank Plc British Gas Limited Environment Agency	ESX213098

9-20	Acquisition of Title in respect of 2925 metres squared of grassland, field and agricultural land, hedgerow (south of Lewes Road, A27) except those owned by the Authority		ESX213098, ESX235696, ESX235697, ESX277925, ESX320055, ESX92419.
10-02	Acquisition of Title in respect of 22 metres squared of field and agricultural land (north of Lewes Road, A27, Long Man) except those owned by the Authority	Barclays Bank Plc Environment Agency Unknown in respect of rights granted by lease dated 29 October 1993	ESX245292
10-03	Acquisition of Title in respect of 2497 metres squared of river, bed and banks thereof (Cuckmere River), hedgerow, path and drain (north of Lewes Road, A27, Long Man)	Barclays Bank Plc British Gas Limited Environment Agency	ESX213098
10-05	Acquisition of Title in respect of 45022 square metres field and agricultural land, hedgerow, river, bed and banks thereof (Cuckmere River) (north of Lewes Road, A27, Long Man) except those owned by the Authority	Environment Agency	ESX173223
10-05a	Acquisition of Title in respect of 6536 square metres field and agricultural land, hedgerow, river, bed and banks thereof (Cuckmere River) (north of Lewes Road, A27, Long Man) except those owned by the acquiring authority.	Environment Agency	ESX173223

10-06	Acquisition of Title in respect of 11 metres squared of river, bed and banks thereof (Cuckmere River) (south of Lewes Road, A27, Long Man) except those owned by the Authority	Environment Agency	ESX245292
10-07	Acquisition of Title in respect of 20 metres squared of river, bed and banks thereof (Cuckmere River) and bridge carrying adopted highway (Lewes Road, A27, Long Man) except those owned by the Authority	Environment Agency	ESX213098
10-08	Acquisition of Title in respect of 396 metres squared of field, agricultural land, river, bed and banks thereof (Cuckmere River) (south of Lewes Road, A27, Long Man)	Environment Agency	unregistered
10-10	Acquisition of Title in respect of 3390 metres squared of field and agricultural land, and access splay (south of Lewes Road, A27, Long Man)	Unknown in respect of rights reserved by conveyance dated 18 November 1949	ESX350389
10-11	Acquisition of Title in respect of 4839 metres squared of grassland and woodland (south of Lewes Road, A27, Long Man)	Unknown in respect of rights reserved by conveyance dated 27 April 1978 Unknown in respect of rights reserved by conveyance dated 18 November 1949	ESX227428
10-13	Acquisition of Title in respect of 10465 metres squared of field and agricultural land (south of Lewes Road, A27, Long Man)	Unknown in respect of rights reserved by conveyance dated 27 April 1978 Unknown in respect of rights reserved by conveyance dated 18 November 1949	ESX227428

The plot numbers above relate to the plot numbers shown on maps 1 to 3 for General Vesting Declaration No. 3 accompanying this Declaration.

EXECUTED as a DEED
By affixing the common seal of
HIGHWAYS ENGLAND COMPANY LIMITED

Nickolas Feemin *N Feemin*

Director or Authorised Signatory

J. S. Anderson

J. S. Anderson

Director or Company Secretary or Authorised
Signatory



2021/1299

Crown copyright and database rights 2018 OS 100030649.
You are permitted to use this data solely to enable you to respond to, or interact with, the organisation that provided you with the data. You are not permitted to copy, sub-licence, distribute or sell any of this data to third parties in any form.

Scale at A3: 1:2500

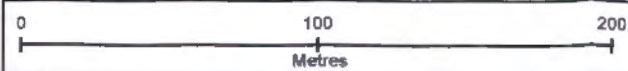

MAP REFERRED TO IN
HIGHWAYS ENGLAND (A27 TRUNK ROAD
EAST OF LEWES IMPROVEMENT SCHEME)
(SHARED USE PATH)
GENERAL VESTING DECLARATION - PLAN FOR
GENERAL VESTING DECLARATION NO. 3
Map 1 of 3

THE COMMON SEAL OF
HIGHWAYS ENGLAND
was hereunto affixed in
the presence of -

Authorised Officer

Dated 10.8.2021



1021/1307

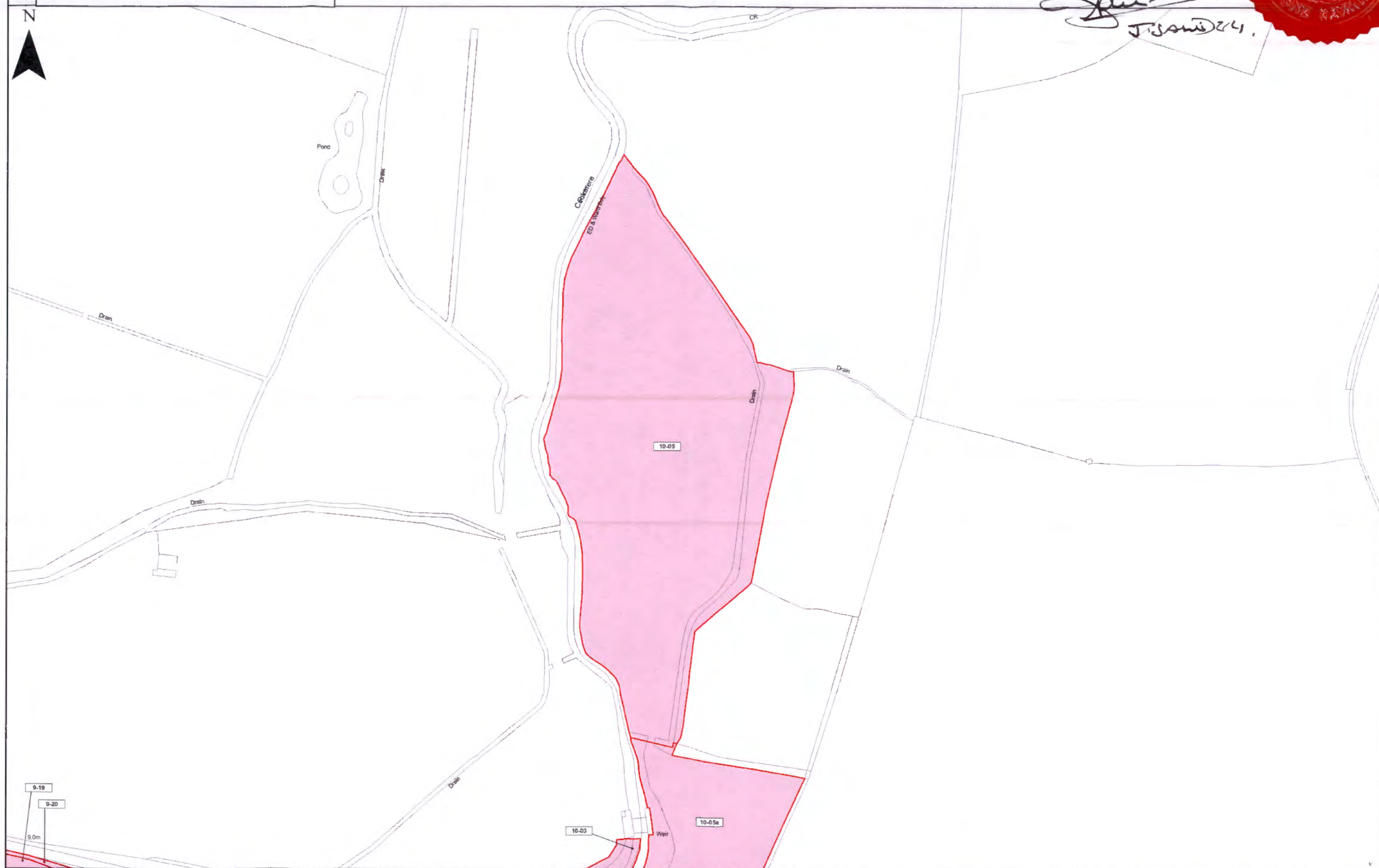

Crown copyright and database rights 2018 OS 100030649.
You are permitted to use this data solely to enable you to
respond to, or interact with, the organisation that provided
you with the data. You are not permitted to copy, sub-licence,
distribute or sell any of this data to third parties in any form.

Scale at A3: 1:2500

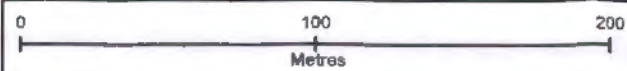

MAP REFERRED TO IN
HIGHWAYS ENGLAND (A27 TRUNK ROAD
EAST OF LEWES IMPROVEMENT SCHEME)
(SHARED USE PATH)
GENERAL VESTING DECLARATION - PLAN FOR
GENERAL VESTING DECLARATION NO. 3
Map 2 of 3

THE COMMON SEAL OF
HIGHWAYS ENGLAND
was hereunto affixed in
the presence of -

Authorised Officer

Dated 10-8-2021

N. Freeman
Nicholas Freeman
John J. SANDER



2021/1202



Crown copyright and database rights 2018 OS 100030649.
You are permitted to use this data solely to enable you to respond to, or interact with, the organisation that provided you with the data. You are not permitted to copy, sub-licence, distribute or sell any of this data to third parties in any form.

Scale at A3: 1:2500



MAP REFERRED TO IN
HIGHWAYS ENGLAND (A27 TRUNK ROAD
EAST OF LEWES IMPROVEMENT SCHEME)
(SHARED USE PATH)
GENERAL VESTING DECLARATION - PLAN FOR
GENERAL VESTING DECLARATION NO. 3
Map 3 of 3

THE COMMON SEAL OF
HIGHWAYS ENGLAND
was hereunto affixed in
the presence of -

Authorised Officer

Dated 10.8.2021



10/11/2022

