

# National Highways

## A14 Junction 47a - 49

### Stakeholder newsletter

**Welcome to the November/ December edition of the A14 junction 47a to junction 49 concrete road newsletter.**

### What we've done so far

We're happy to report that the A14 eastbound carriageway has been fully reconstructed. We've laid a temporary surface which will be replaced with the final surface when the reconstruction of the westbound carriageway is complete in summer 2024.

We've started work on the westbound carriageway, beginning with the excavation of lane 2 in preparation for the full reconstruction of the road.

Once the westbound carriageway reconstruction is complete, we'll return to the eastbound in summer 2024 to apply the finished surface layer.



*Our workers moving the safety barriers on site*

The carriageway is still reduced to one lane in both directions as we work, and the speed limit remains at 50mph to ensure the safety of our workers and other road users.



*Machine used for painting lines on the road*

We've also dug a number of trial holes so that we know where all of the services located underneath the carriageway are, so that we can work around them.

### What's next

Before the Christmas period, we're expecting to break out the concrete in most of lane 2 of the westbound carriageway.

We'll also be removing the safety barrier located in the verge of the westbound carriageway. This will be replaced at a later date.

For the Christmas period, the site will shut down on Wednesday 20 December and we'll be back on Wednesday 3 January. We will still have staff around, to provide recovery for stranded vehicles, to check the traffic management, and to carry out any emergency maintenance work that may be required.

### Traffic layout changes

Following the traffic management switch, we expected congestion to be heavier than usual whilst road users get used to the new layout, and this has proved to be the case.

We know it's a lot to ask, but to help ease congestion we'd like to encourage drivers to think about the way they travel during peak periods and consider:

- 🚗 Car sharing
- 🏠 Working from home if possible
- 🕒 Re-timing your journey

Where the road merges into one lane, we ask drivers to use both lanes on the approach to the contraflow and then merge in turn. This will help to keep traffic flowing.

We're also observing that HGV drivers are straddling both lanes or stopping side by side and then moving along slowly. This creates large gaps and adds to the congestion.



We are reviewing CCTV footage and will be writing to the relevant haulage companies to encourage better driver behaviours.

We encourage all drivers to correctly "merge in turn" as follows:

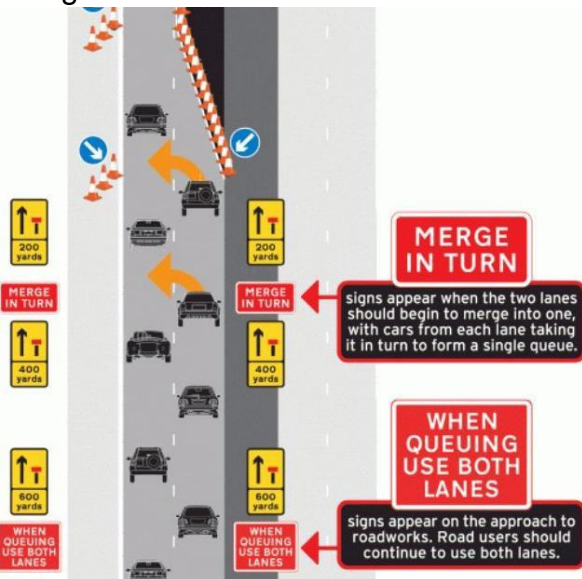

This can help significantly reduce the overall length of queueing traffic, and the risk of disruption and tailbacks at junctions.

## Traffic control

We've worked with Suffolk County Council to consider further actions that can be introduced to prevent the rat running through local villages.

Although we've introduced additional signs along various routes, it's clear that some road users are ignoring these. We've temporarily reduced the speed limit on a number of local roads already, and these have been in place since 16 October 2023. We're continuing to monitor how effective these temporary speed limits are.

We're in the process of applying for further speed reductions to cover Church Road, New Road, Leys Road and Hollow Lane in Tostock. They will be introduced in the new year.

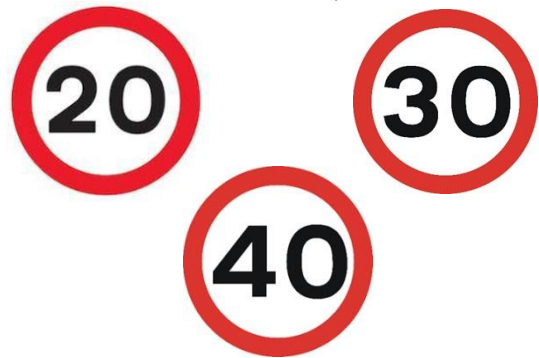

All temporary speed limit reductions will be removed once the A14 junction 47a to junction 49 reconstruction project is completed in summer 2024.



The two safety speed camera vans will continue to monitor local routes that are typically used to rat run.

Where a pothole is forming or the verge has been damaged, please report directly to Suffolk County Council on 0345 606 6171 or using their online [Highways reporting tool](#).

If you have any other queries relating to the A14, please contact us by calling the 24/7 National Highways Customer Contact Centre on 0300 123 5000, email [info@nationalhighways.co.uk](mailto:info@nationalhighways.co.uk).

## Woolpit Tennis and Cricket Club carpark repair

We've donated over 8 tonnes of material, to help repair the car park shared by the Woolpit Tennis and Woolpit Cricket Clubs.



Four members of staff helped deliver the material and carry out the repairs, which means the car park is now free of potholes and is nice and level.



## Tostock Animal Park

Tostock Animal Park got in touch to request help so that they could create some new paths and improve some of their existing tracks.



Four members of our staff volunteered to help deliver 50 tonnes of recycled road material. We also provided the plant and machinery to help carry out the work.

If you're a member of a local community group that needs support with work you do in the local community, please contact Jon via email at [A14J47J49CCC@sisk.co.uk](mailto:A14J47J49CCC@sisk.co.uk).

## A14 welcomes Jo Churchill MP

We recently welcomed local MP for Bury St Edmunds, Jo Churchill, to site recently to give her a tour of the site, an update on what has taken place and what work we have coming up.



She said, "I was delighted to visit the A14 roadworks by Woolpit and receive an update and a comprehensive look at what's going on and the switchover and chat to Sisk and National Highways about the project.

"I was particularly pleased to learn about the company's keenness to offer work experience for those interested in the civil construction world.

"Good progress has been made and I look forward with many constituents to seeing its completion and a smooth new road in early summer 2024."



## Width restrictions

During the contraflow, vehicles with an overall width exceeding 3.5m will be unable to travel through the roadworks.

Any loads wider than 3m must give advance notification to Suffolk County Council and receive consent. See [www.suffolk.gov.uk/roads-and-transport/lorry-management/apply-to-move-abnormal-loads](http://www.suffolk.gov.uk/roads-and-transport/lorry-management/apply-to-move-abnormal-loads)

## Are you ready for winter driving conditions?

Topping up anti-freeze in your car and checking your tyres are inflated to the correct air pressure are just two important things you can do to prepare for driving this autumn/winter.

There are lots of travel tips and advice for negotiating [severe weather](#) on the National Highways' website to help improve driver confidence when travelling as temperatures get colder, the nights draw in, low-lying sun hampers vision and the potential for fog, rain and high winds increase.



## Text Message Alert Service

We've set up a free text message service to keep drivers informed, via text message, about incidents that occur within our roadworks.

You can sign up for this service by sending your mobile number to:

[ConcreteRoadsEastA14@nationalhighways.co.uk](mailto:ConcreteRoadsEastA14@nationalhighways.co.uk)

Please reference the 'A14 junction 47a Haughley to junction 49 Tothill SMS service' in the subject of your email.

You can opt out at any time by contacting us at the same email address.

## Tell us what you think

We'd like to hear what you think about the information we send to you. Please spend a few minutes completing our online questionnaire by visiting:

<https://forms.office.com/e/TC4RYq9bJk>

Alternatively, you can access the survey by scanning this QR code:



## Get in touch with us

You can visit our webpage and sign up for updates about the scheme at [www.nationalhighways.co.uk/A14Haughley](http://www.nationalhighways.co.uk/A14Haughley)

If you'd like more information about our work, then please call the 24/7 National Highways Customer Contact Centre on 0300 123 5000, or email [info@nationalhighways.co.uk](mailto:info@nationalhighways.co.uk)