

This map is based on Ordnance Survey material with the permission of Ordnance Survey on behalf of the Controller of Her Majesty's Stationery Office. © Crown Copyright. Unauthorised reproduction infringes Crown copyright and may lead to prosecution or civil proceedings. Highways England 100030649, 2019.

NOTES (for information):

Land in the Compulsory Purchase Order is required for the:

i) Construction of the new trunk road referred to in 'The A249 Trunk Road (Stockbury Roundabout Improvements) Order 20..'. (and shown on plans in that Order).

ii) Construction and improvement of highways and the construction of new private means of access referred to in 'The Highways England (A249 Trunk Road Stockbury Roundabouts Improvements) (Side Roads) Order 2019' (as shown on plans in that Order).

M2 JUNCTION 5 IMPROVEMENTS

Map referred to in
THE HIGHWAYS ENGLAND (A249 TRUNK ROAD STOCKBURY ROUNDABOUT IMPROVEMENTS) COMPULSORY PURCHASE ORDER 2019

SIGNED BY AUTHORITY OF
HIGHWAYS ENGLAND COMPANY LIMITED

NAME: *C. WILSON - EVERARD*
A DIVISIONAL DIRECTOR IN
HIGHWAYS ENGLAND COMPANY LIMITED

DATE: *24 April 2019*

2019
NO. 562
No.

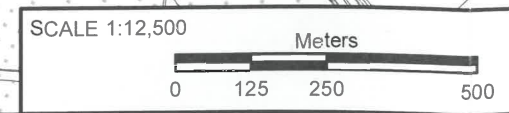
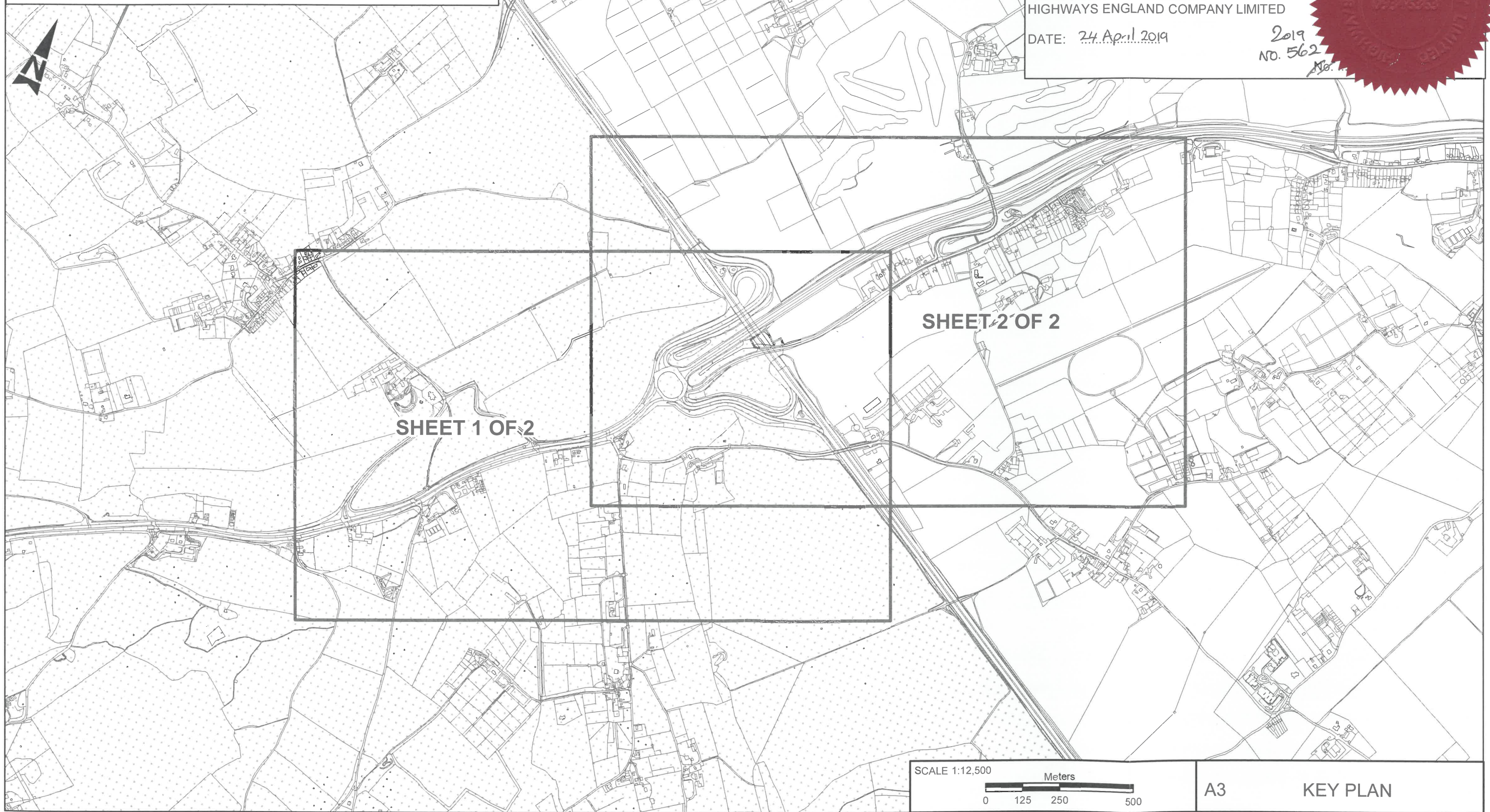

A3 KEY PLAN

This map is based on Ordnance Survey material with the permission of Ordnance Survey on behalf of the Controller of Her Majesty's Stationery Office. © Crown Copyright/Unauthorised reproduction infringes Crown copyright and may lead to prosecution or civil proceedings. Highways England 10000649, 2019.

NOTES (for information):

Land in the Compulsory Purchase Order is required for the:

(i) Construction of the new trunk road referred to in The A249 Trunk Road (Stockbury Roundabout Improvements) Order 2021 (and shown on plans in that Order).

(ii) Construction and improvement of highways and the construction of new private means of access referred to in The Highways England (A249 Trunk Road Stockbury Roundabouts Improvements) (Side Roads) Order 2019 (as shown on plans in that Order).

M2 JUNCTION 5 IMPROVEMENTS

Map referred to in
THE HIGHWAYS ENGLAND (A249 TRUNK ROAD
STOCKBURY ROUNDABOUT IMPROVEMENTS)
COMPULSORY PURCHASE ORDER 2019

SIGNED BY AUTHORITY OF
HIGHWAYS ENGLAND COMPANY LIMITED

NAME:
A DIVISIONAL DIRECTOR IN
HIGHWAYS ENGLAND COMPANY LIMITED

DATE:

No.

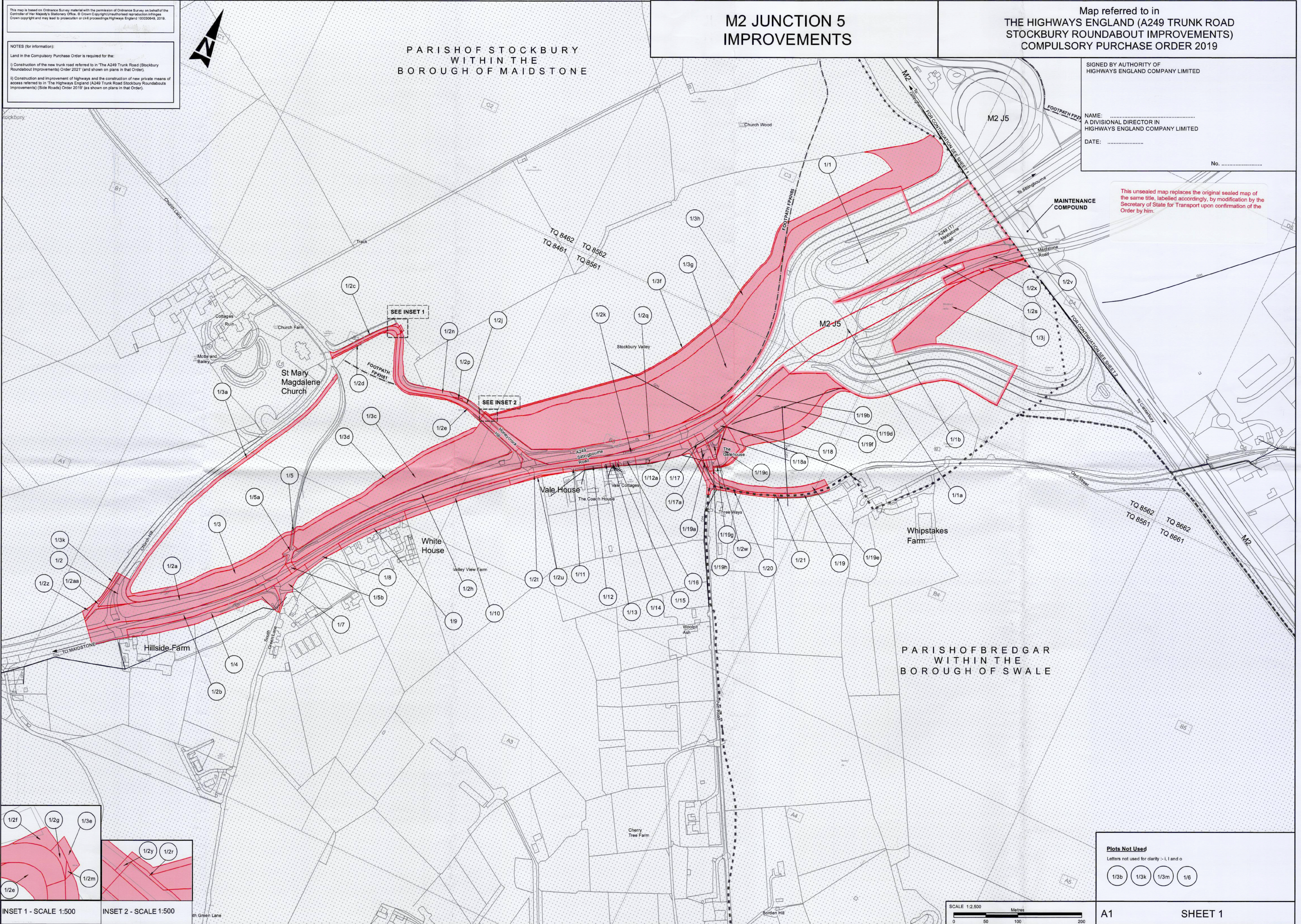

This unsealed map replaces the original sealed map of the same title, labelled accordingly, by modification by the Secretary of State for Transport upon confirmation of the Order by him.

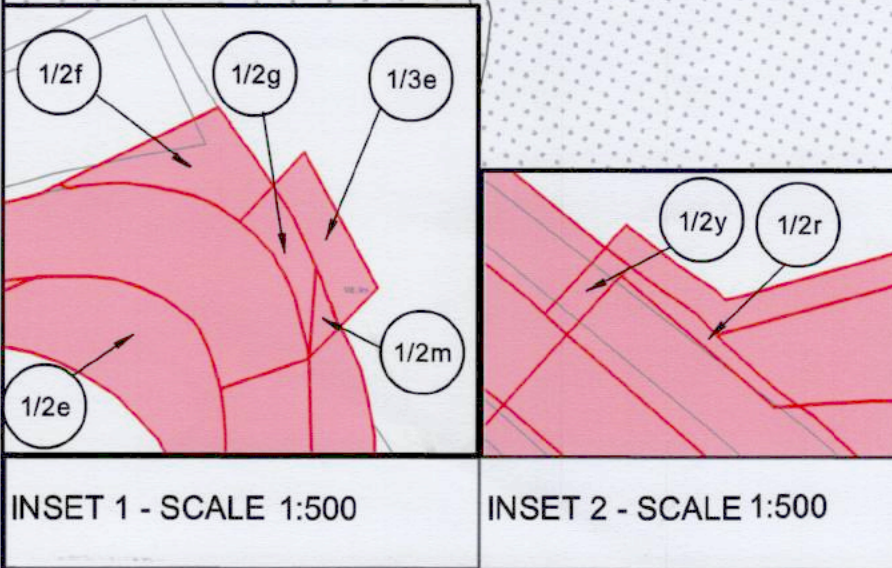

Plots Not Used

Letters not used for clarity: i, l and o

1/3b 1/3k 1/3m 1/6

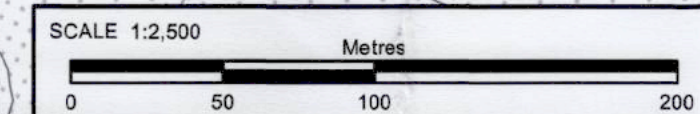

This map is based on Ordnance Survey material with the permission of Ordnance Survey on behalf of the
Controller of Her Majesty's Stationery Office. © Crown Copyright. Unauthorised reproduction infringes
Crown copyright and may lead to prosecution or civil proceedings. Highways England 100030649, 2019.

NOTES (for information):

Land in the Compulsory Purchase Order is required for the:

- i) Construction of the new trunk road referred to in 'The A249 Trunk Road (Stockbury Roundabout Improvements) Order 2019' (and shown on plans in that Order).
- ii) Construction and improvement of highways and the construction of new private means of access referred to in 'The Highways England (A249 Trunk Road Stockbury Roundabouts Improvements) (Side Roads) Order 2019' (as shown on plans in that Order).

M2 JUNCTION 5 IMPROVEMENTS

Map referred to in
THE HIGHWAYS ENGLAND (A249 TRUNK ROAD
STOCKBURY ROUNDABOUT IMPROVEMENTS)
COMPULSORY PURCHASE ORDER 2019

SIGNED BY AUTHORITY OF
HIGHWAYS ENGLAND COMPANY LIMITED

[Signature]

NAME: *Chris Wicks*
A DIVISIONAL DIRECTOR IN
HIGHWAYS ENGLAND COMPANY LIMITED

DATE: *24 April 2019*



2019 No. *562*

This original sealed map is replaced by the unsealed map of the same title, labelled accordingly, by modification by the Secretary of State for Transport upon confirmation of the Order by him.

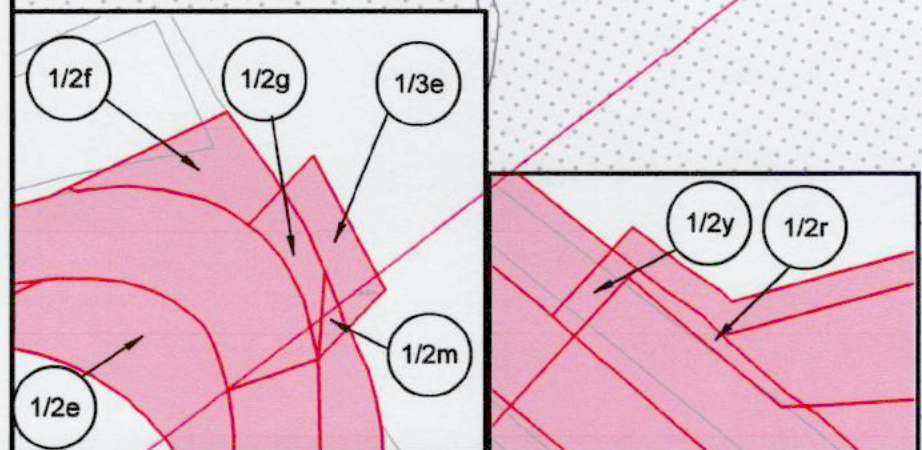
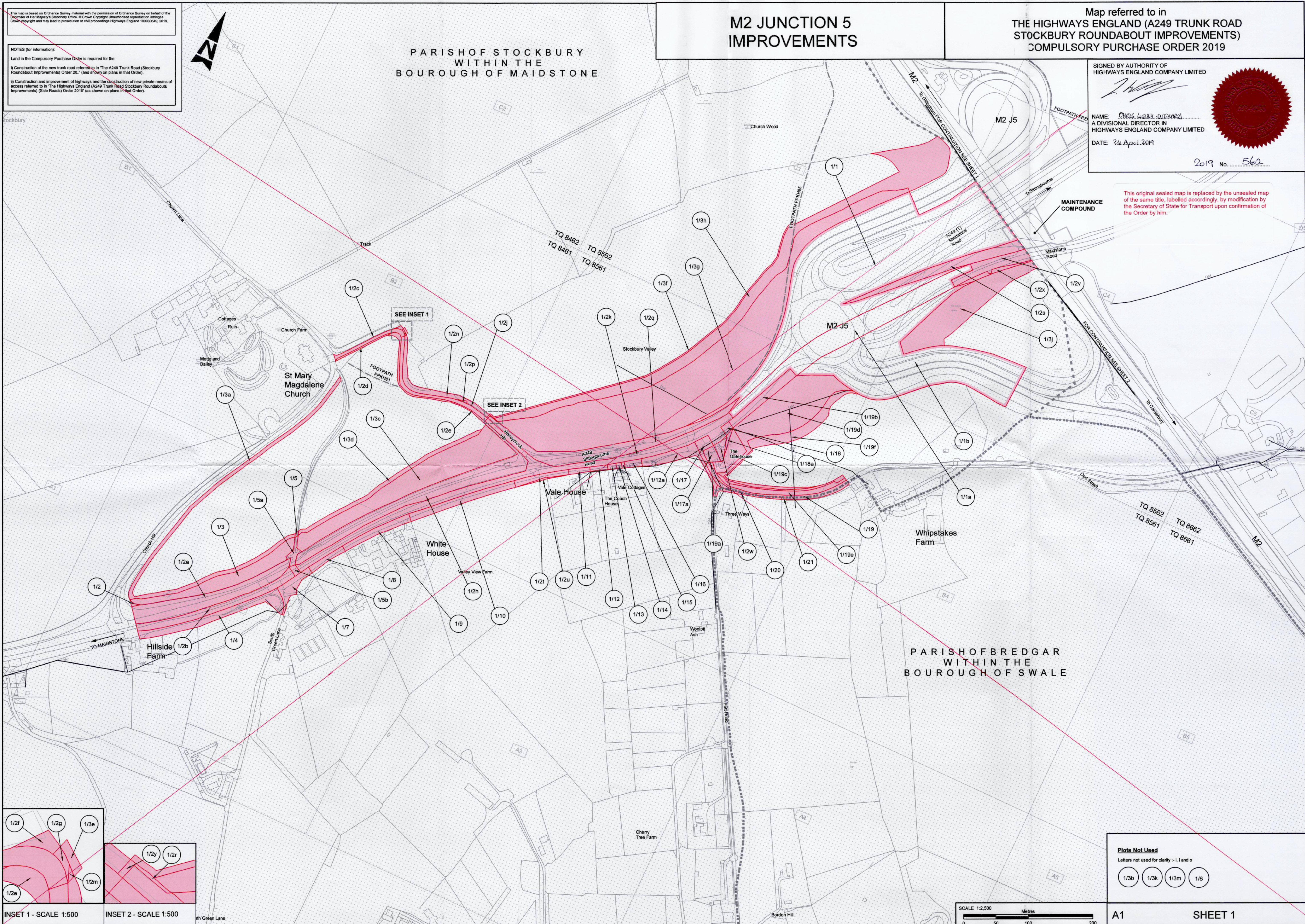

INSET 1 - SCALE 1:500
INSET 2 - SCALE 1:500

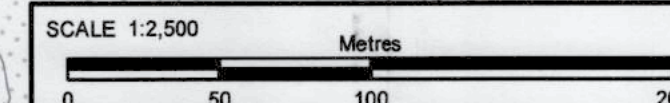

Plots Not Used
Letters not used for clarity: i, l and o

- 1/3b
- 1/3k
- 1/3m
- 1/6

NOTES (for information):

Land in the Compulsory Purchase Order is required for the:

- i) Construction of the new trunk road referred to in 'The A249 Trunk Road (Stockbury Roundabout Improvements) Order 2021' (and shown on plans in that Order).
- ii) Construction and improvement of highways and the construction of new private means of access referred to in 'The Highways England (A249 Trunk Road Stockbury Roundabouts Improvements) (Side Roads) Order 2019' (as shown on plans in that Order).

This map is based on Ordnance Survey material with the permission of Ordnance Survey on behalf of the Controller of Her Majesty's Stationery Office. © Crown Copyright. Unauthorised reproduction infringes Crown copyright and may lead to prosecution or civil proceedings. Highways England 100030640, 2019.

NOTES (for information):

Land in the Compulsory Purchase Order is required for the:

i) Construction of the new trunk road referred to in 'The A249 Trunk Road (Stockbury Roundabout Improvements) Order 2019' (as shown on plans in that Order).

ii) Construction and improvement of highways and the construction of new private means of access referred to in 'The Highways England (A249 Trunk Road Stockbury Roundabouts Improvements) (Side Roads) Order 2019' (as shown on plans in that Order).

M2 JUNCTION 5 IMPROVEMENTS

Map referred to in
THE HIGHWAYS ENGLAND (A249 TRUNK ROAD STOCKBURY ROUNDABOUT IMPROVEMENTS) COMPULSORY PURCHASE ORDER 2019

SIGNED BY AUTHORITY OF
HIGHWAYS ENGLAND COMPANY LIMITED

[Signature]

NAME: *Chris Worsley*
A DIVISIONAL DIRECTOR IN
HIGHWAYS ENGLAND COMPANY LIMITED

DATE: *24 April 2019*



2019 No. *562*

This original sealed map is replaced by the unsealed map of the same title, labelled accordingly, by modification by the Secretary of State for Transport upon confirmation of the Order by him.

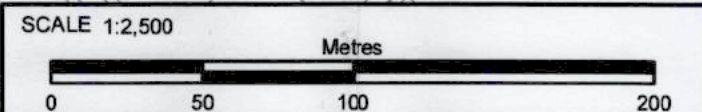
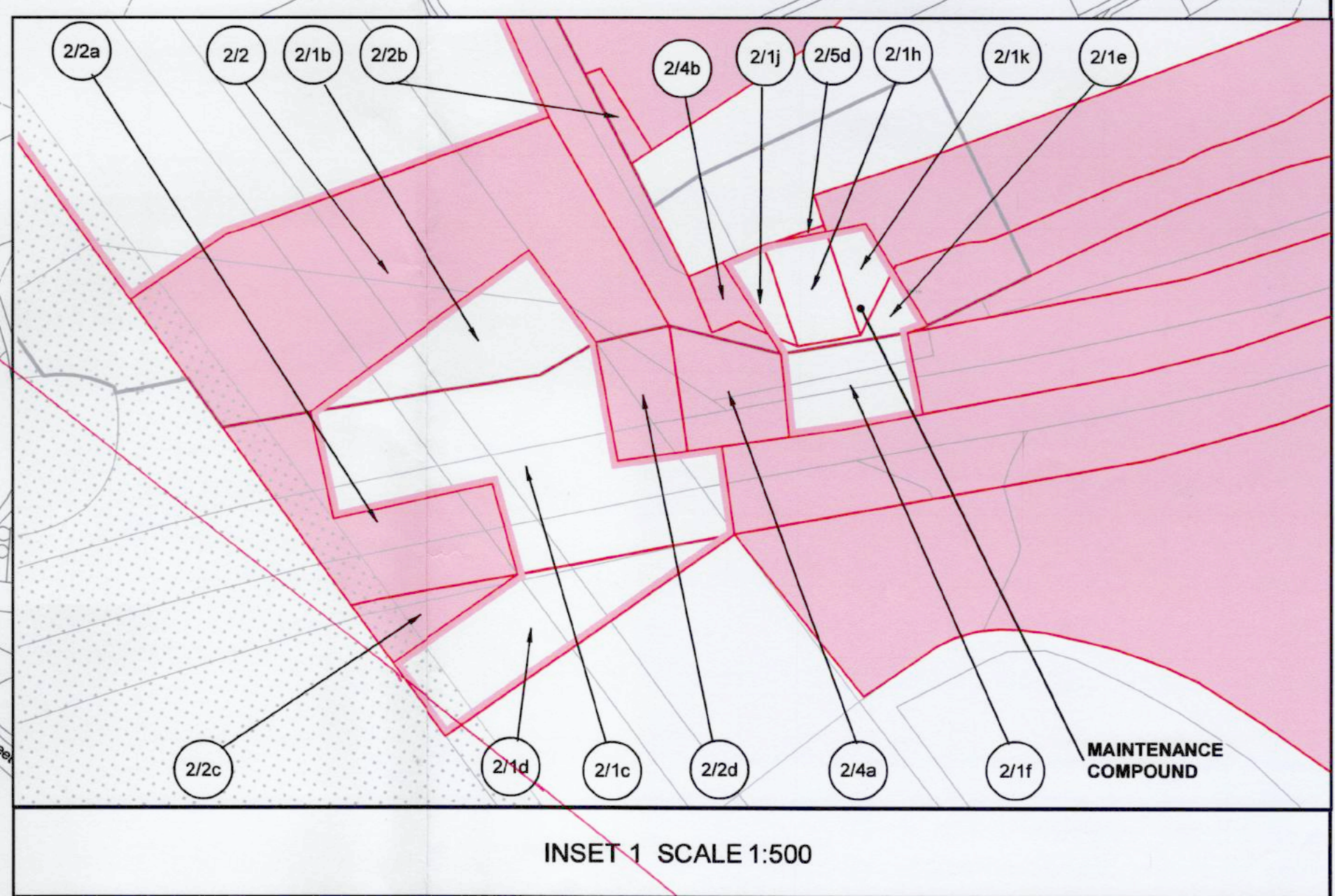
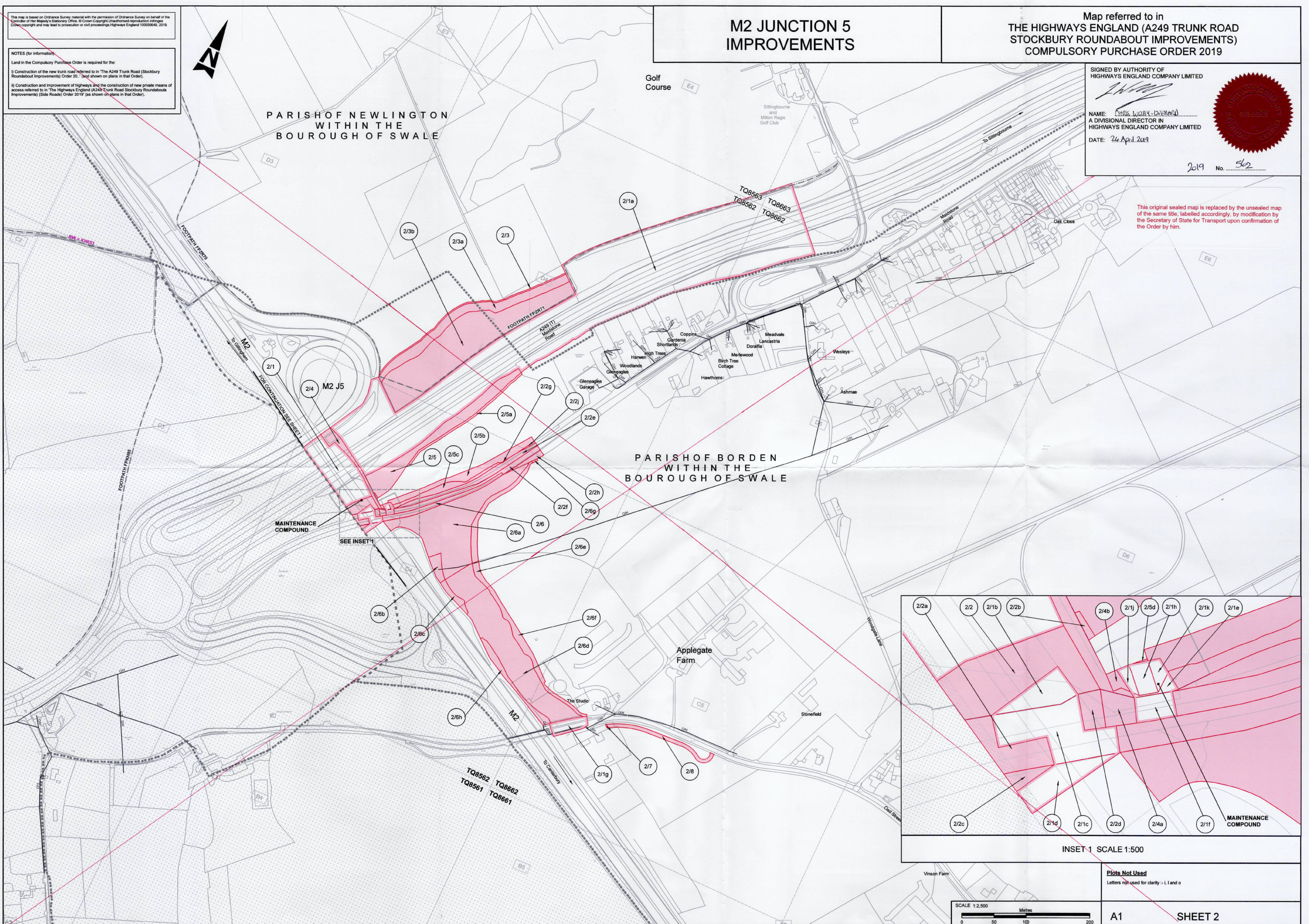

Plots Not Used
Letters not used for clarity - i, l and o