





The common seal of
HIGHWAYS ENGLAND COMPANY LIMITED
Nicholas Freeman
 Director or Authorised Signatory
Freeman
 Director or Company Secretary or Authorised Signatory
 Dated: **2021/626**



KEY
 LAND TO BE PERMANENTLY ACQUIRED
 LAND TO BE USED TEMPORARILY AND RIGHTS TO BE ACQUIRED PERMANENTLY

NOTES
 FOR PLOT REFERENCE NUMBERS PLEASE REFER TO THE LAND PLANS AND SCHEDULE ACCOMPANYING THE A303 SPARKFORD TO ILCHESTER DUALLING DEVELOPMENT CONSENT ORDER 2019

HIGHWAYS ENGLAND COMPANY LIMITED
THE A303 SPARKFORD TO ILCHESTER DUALLING DEVELOPMENT CONSENT ORDER 2021
GENERAL VESTING DECLARATION No. 5

Scale at A3: 1:2500



This map is based upon Ordnance Survey material with the permission of Ordnance Survey on behalf of the Controller of Her Majesty's Stationery Office © Crown copyright. Unauthorised reproduction infringes Crown copyright and may lead to prosecution or civil proceedings. 2018 OS 100030649

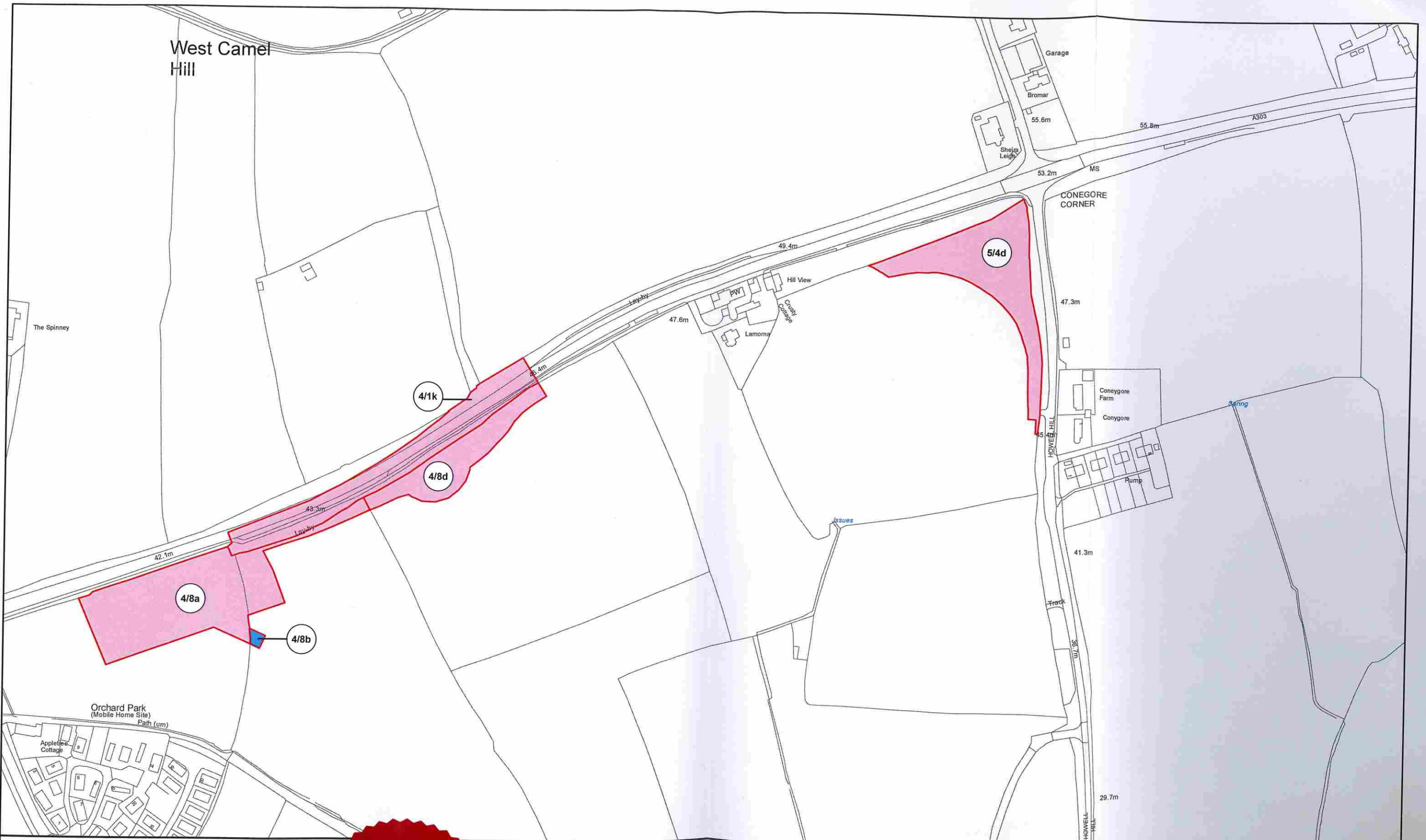

The common seal of
 HIGHWAYS ENGLAND COMPANY LIMITED
N Freeman
 Director or Authorised Signatory
J. Smith
 Director or Company Secretary or Authorised Signatory
 Dated: 2021/02/26



KEY
 [Pink Box] LAND TO BE PERMANENTLY ACQUIRED
 [Blue Box] LAND TO BE USED TEMPORARILY AND RIGHTS TO BE ACQUIRED PERMANENTLY

NOTES
 FOR PLOT REFERENCE NUMBERS PLEASE REFER TO THE LAND PLANS AND SCHEDULE ACCOMPANYING THE A303 SPARKFORD TO ILCHESTER DUALLING DEVELOPMENT CONSENT ORDER 2019

HIGHWAYS ENGLAND COMPANY LIMITED
 THE A303 SPARKFORD TO ILCHESTER DUALLING DEVELOPMENT CONSENT ORDER 2021
 GENERAL VESTING DECLARATION No. 5

Scale at A3: 1:2500

This map is based upon Ordnance Survey material with the permission of Ordnance Survey on behalf of the Controller of Her Majesty's Stationery Office © Crown copyright. Unauthorised reproduction infringes Crown copyright and may lead to prosecution or civil proceedings. 2018 OS 100030649